

**Models:**  
**PREM-SEAT-01**  
**STND-SEAT-01**  
**BARI-SEAT-01**



**Prescribed for Progress™**

# **SCIFIT Seat System Assembly Manual**



**STANDARD**



**BARIATRIC**



**PREMIUM**



Before using this product, read this manual and follow all safety rules and operating instructions.



## CORPORATE HEADQUARTERS

Columbia Centre III, 9525 West Bryn Mawr Avenue, Rosemont, Illinois 60018 • U.S.A.

847.288.3300 • FAX: 847.288.3703

Service phone number: 800.351.3737 (toll-free within U.S.A., Canada)

Global Website [www.lifefitness.com](http://www.lifefitness.com)

## INTERNATIONAL OFFICES

### AMERICAS

#### North America SCIFIT

5151 S. 110th E. Avenue  
Tulsa, OK, 74146 U.S.A  
Toll Free: +1 (800) 745 1373  
Fax: +1 (918) 359 2045  
Email: [Service@scifit.com](mailto:Service@scifit.com)  
Service Website: [www.scifit.com/Support](http://www.scifit.com/Support)  
Operating Hours: 7:00 am - 5:00 pm (CST)

#### Brazil Life Fitness Brasil

Av. Cidade Jardim, 900  
Jd. Paulistano  
São Paulo, SP 01454-000  
BRAZIL  
SAC: 0800 773 8282  
Telephone: +55 (11) 3095 5200  
Fax: +55 (11) 3095 5201  
Service Email: [suporte@lifefitness.com.br](mailto:suporte@lifefitness.com.br)  
Sales/Marketing Email:  
[lifefitness@lifefitness.com.br](mailto:lifefitness@lifefitness.com.br)  
Service Operating Hours:  
9:00 - 17:00 (BRT) (Monday-Friday)  
Store Operating Hours:  
9:00 - 20:00 (BRT) (Monday-Friday)  
10:00 - 16:00 (BRT) (Saturday)

#### Latin America & Caribbean\* Life Fitness Inc.

Columbia Centre III  
9525 West Bryn Mawr Avenue  
Rosemont, IL 60018 U.S.A  
Telephone: (847) 288 3300  
Fax: (847) 288 3703  
Service Email:  
[customersupport@lifefitness.com](mailto:customersupport@lifefitness.com)  
Sales/Marketing Email:  
[commercialsales@lifefitness.com](mailto:commercialsales@lifefitness.com)  
Operating Hours: 7:00am - 6:00pm (CST)

### EUROPE, MIDDLE EAST, & AFRICA (EMEA)

#### Netherlands & Luxemburg Life Fitness Atlantic BV

Bijdorpplein 25-31  
2992 LB Barendrecht  
THE NETHERLANDS  
Telephone: (+31) 180 646 666  
Fax: (+31) 180 646 699  
Service Email:  
[service.benelux@lifefitness.com](mailto:service.benelux@lifefitness.com)  
Sales/Marketing Email:  
[Marketing.benelux@lifefitness.com](mailto:Marketing.benelux@lifefitness.com)  
Operating Hours: 9.00h - 17.00h (CET)

#### United Kingdom & Ireland Life Fitness UK LTD

Queen Adelaide  
Ely, Cambs, CB7 4UB  
Telephone: General Office (+44)  
1353.666017  
Customer Support (+44) 1353.665507  
Fax: (+44) 1353.666018  
Service Email: [uk.support@lifefitness.com](mailto:uk.support@lifefitness.com)  
Sales/Marketing Email: [life@lifefitness.com](mailto:life@lifefitness.com)  
Operating Hours:  
General Office: 9.00am - 5.00pm (GMT)  
Customer Support: 8.30am - 5.00pm (GMT)

#### Germany & Switzerland Life Fitness Europe GMBH

Siemensstraße 3  
85716 Unterschleißheim  
GERMANY  
Telephone: (+49) 89.31 77 51.0 (Germany)  
(+41) 0848 000 901 (Switzerland)  
Fax: (+49) 89.31 77 51.99 (Germany)  
(+41) 043 818 07 20 (Switzerland)  
Service Email:  
[kundendienst@lifefitness.com](mailto:kundendienst@lifefitness.com)  
Sales/Marketing Email:  
[kundenberatung@lifefitness.com](mailto:kundenberatung@lifefitness.com)  
Operating Hours: 08.30 - 16.30h (CET)

#### Austria Life Fitness Austria

Vertriebs G.m.b.H.  
Dückerstraße 7-9/3/36  
1220 Vienna  
AUSTRIA  
Telephone: (+43) 1.61.57.198  
Fax: (+43) 1.61.57.198.20  
Service Email: [kundendienst@lifefitness.com](mailto:kundendienst@lifefitness.com)  
Marketing/Sales Email:  
[kundenberatung@lifefitness.com](mailto:kundenberatung@lifefitness.com)  
Operating Hours: 08:30 - 16.30.h (MEZ)

#### Spain Life Fitness IBERIA

C/Frederic Mompou 5, 1<sup>o</sup>1<sup>a</sup>  
08960 Sant Just Desvern Barcelona  
SPAIN  
Telephone: (+34) 93.672.4660  
Fax: (+34) 93.672.4670  
Service Email: [servicio.tecnico@lifefitness.com](mailto:servicio.tecnico@lifefitness.com)  
Sales/Marketing Email:  
[info.iberia@lifefitness.com](mailto:info.iberia@lifefitness.com)  
Operating Hours:  
9.00h - 18.00h (Monday-Thursday)  
8.30h - 15.00h (Friday)

#### Belgium Life Fitness Benelux NV

Parc Industriel de Petit-Rechain  
4800 Verviers  
BELGIUM  
Telephone: (+32) 87 300 942  
Fax: (+32) 87 300 943  
Service Email:  
[service.benelux@lifefitness.com](mailto:service.benelux@lifefitness.com)  
Sales/Marketing Email:  
[marketing.benelux@lifefitness.com](mailto:marketing.benelux@lifefitness.com)  
Operating Hours: 9.00h - 17.00h (CET)

#### All Other EMEA Countries & Distributor Business C-EMEA\*

Bijdorpplein 25-31  
2992 LB Barendrecht  
THE NETHERLANDS  
Telephone: (+31) 180 646 644  
Fax: (+31) 180 646 699  
Service Email:  
[service.db.cemea@lifefitness.com](mailto:service.db.cemea@lifefitness.com)  
Sales/Marketing Email:  
[marketing.db.cemea@lifefitness.com](mailto:marketing.db.cemea@lifefitness.com)  
Operating Hours: 9.00h - 17.00h (CET)

### ASIA PACIFIC (AP)

#### Japan Life Fitness Japan

Japan Nippon Brunswick Bldg., #8F  
5-27-7 Sendagaya  
Shibuya-Ku, Tokyo  
Japan 151-0051  
Telephone: (+81) 3.3359.4309  
Fax: (+81) 3.3359.4307  
Service Email: [service@lifefitnessjapan.com](mailto:service@lifefitnessjapan.com)  
Sales/Marketing Email:  
[sales@lifefitnessjapan.com](mailto:sales@lifefitnessjapan.com)  
Operating Hours: 9.00h - 17.00h (JAPAN)

#### Hong Kong Life Fitness Asia Pacific LTD

32/F, Global Trade Square  
21 Wong Chuk Hang Road  
HONG KONG  
Telephone: (+852) 2575.6262  
Fax: (+852) 2575.6894  
Service Email:  
[HongKongEnquiry@lifefitness.com](mailto:HongKongEnquiry@lifefitness.com)  
Sales/Marketing Email:  
[Marketing.HK.Asia@lifefitness.com](mailto:Marketing.HK.Asia@lifefitness.com)  
Operating Hours: 9.00h - 17.00h  
Service Operating Hours: 9.00h - 18.00h

#### All Other Asia Pacific countries & distributor business Asia Pacific Life Fitness Asia Pacific LTD

32/F, Global Trade Square  
21 Wong Chuk Hang Road  
HONG KONG  
Telephone: (+852) 2575.6262  
Fax: (+852) 2575.6894  
Service Email:  
[HongKongEnquiry@lifefitness.com](mailto:HongKongEnquiry@lifefitness.com)  
Sales/Marketing Email:  
[Marketing.HK.Asia@lifefitness.com](mailto:Marketing.HK.Asia@lifefitness.com)  
Operating Hours: 9.00h - 17.00h  
Service Operating Hours: 9.00h - 18.00h

\* Also check [www.lifefitness.com](http://www.lifefitness.com) for local representation or distributor/dealer

\* Order online 24/7 at [www.SCIFIT.com](http://www.SCIFIT.com)



**Prescribed for Progress™**

Operation Manuals and other Product Information available at <http://www.scifit.com/resources/specifications-manuals/>

عقودملا ولع ةحاتم زاوجلان ع ىرخأ تامولعمو ليغشتلا فلداً <http://www.scifit.com/resources/specifications-manuals/>

操作マニュアルおよびその他の製品情報については、<http://www.scifit.com/resources/specifications-manuals/>をご覧ください。

如需操作手册和其他产品信息，请登录：<http://www.scifit.com/resources/specifications-manuals/>

操作手册和其他产品资讯请见 <http://www.scifit.com/resources/specifications-manuals/>

작동 설명서 및 기타 제품 정보는 <http://www.scifit.com/resources/specifications-manuals/>에서 찾을 수 있습니다.

Trobareu el manual de funcionament i altra informació de producte a <http://www.scifit.com/resources/specifications-manuals/>

Mae Llawlyfrau Gweithredu a Gwybodaeth Arall am Beiriannau ar gael yn <http://www.scifit.com/resources/specifications-manuals/>

Die Betriebsanleitung und andere Produktinformationen erhalten Sie unter <http://www.scifit.com/resources/specifications-manuals/>

Encontrará el manual de funcionamiento y otra información de producto en <http://www.scifit.com/resources/specifications-manuals/>

Erabiltzailearen Eskuliburua eta Beste Produktuei buruzko Informazioa eskuratu <http://www.scifit.com/resources/specifications-manuals/>

Käyttöoppaat ja muut tuotetiedot ovat saatavana osoitteessa <http://www.scifit.com/resources/specifications-manuals/>

Les manuels d'utilisation, ainsi que d'autres informations sur les Produits, sont disponibles sur <http://www.scifit.com/resources/specifications-manuals/>

Felhasználói kézikönyvek és más termékinformációk: <http://www.scifit.com/resources/specifications-manuals/>

Manuali di funzionamento e altre informazioni sui prodotti disponibili su <http://www.scifit.com/resources/specifications-manuals/>

Manuali di funzionamento e altre informazioni sui prodotti disponibili su <http://www.scifit.com/resources/specifications-manuals/>

Instrukcje obsługi i inne informacje o produktach dostępne na stronie <http://www.scifit.com/resources/specifications-manuals/>

Manuais de Operação e Informações sobre outros produtos disponíveis em <http://www.scifit.com/resources/specifications-manuals/>

Руководства по эксплуатации и другую касающуюся нашей продукции информацию можно найти, перейдя по ссылке <http://www.scifit.com/resources/specifications-manuals/>

Kullanım Kılavuzları ve Diğer Ürün Bilgileri <http://www.scifit.com/resources/specifications-manuals/>

# TABLE OF CONTENTS

<b>MAINTENANCE</b> .....	1
<b>SAFETY INFORMATION</b> .....	2
<b>SPECIFICATIONS</b> .....	3
<b>PREMIUM SEAT ASSEMBLY</b> .....	4-6
<b>STANDARD SEAT ASSEMBLY</b> .....	7-8
<b>BARIATRIC SEAT ASSEMBLY</b> .....	9-11
<b>PLACING THE SEAT ASSEMBLY ONTO THE MACHINE</b> .....	11
<b>WARRANTY</b> .....	12

## MAINTENANCE

COMPONENT	ACTION	WHEN
Upholstery	Clean With Mild Soap and Water	Daily
Base Wheel Rollers	Clean With a Damp Cloth	Every 6 Months

# SAFETY INFORMATION

The purpose of the symbol seen below is to attract your attention to possible dangers during the assembly or adjustment process. The Attention symbol and special icons with its associated explanation, deserves your careful consideration. The warning does not by itself eliminate any danger. The instructions given are not substitutes for proper accident prevention measures.

Look for this symbol that will point out safety precautions or important information.



- Read all warnings and instructions on each product prior to using your SCIFIT seat system. Save these instructions for future reference.
- If warnings are missing or damaged, please contact SCIFIT immediately for replacement warning labels. Warning labels are shipped with every product and should be installed before product is used. SCIFIT is not responsible for missing or damaged warning labels.
- Use the SCIFIT seat system only for its intended purposes as described in this manual. Do not use attachments not recommended by the manufacturer.
- Never drop or insert any object into any opening.
- **This seat assembly is intended for indoor use only.** Do not place in direct sunlight, high humidity or where water is present (i.e. pool or spa areas).
- Consult your physician or medical specialist before participating in any exercise program, especially if you are pregnant or if you are suffering from heart disease, respiratory disease, diabetes, high blood pressure, elevated cholesterol, arthritis, or any other diseases and physical complaints.
- The exercise machine this seat system is attached to is not to be used by persons (including children) with reduced physical, sensory or mental capabilities, or lack of experience and knowledge, unless they have supervision or been given instruction.
- Close supervision is necessary when the exercise machine this seat system is attached to is being used near children. Keep children away from rotating mechanical parts and supports that may cause injury.
- To prevent muscle injuries and soreness, you should always cool down at least 5 minutes. Always stretch after a workout session to reduce the risk of personal injury. Failure to stretch properly may result in injury to yourself.
- **WARNING!** Heart rate monitoring systems may be inaccurate. Over exercise may result in serious injury or death. If you feel faint stop exercising immediately.
- **DANGER!** To reduce the risk of electrical shock, always unplug SCIFIT products before cleaning or attempting any maintenance activity.
- **WARNING!** To reduce the risk of burns, fire, electrical shock, or injury, it is imperative to connect each product to a properly grounded electrical outlet.
- Injuries to health may result from incorrect or excessive training. Failure to stop exercising can result in injury or death to yourself.

## PROPOSITION 65

Health and Environmental Regulation Warning - This product may contain chemicals known to the state of California to cause cancer, birth defects, or other reproductive harm. For more information related to the European Commission Regulation (EC) No. 1907/2006 (REACH) and the California Safe Drinking Water and Toxic Enforcement Act of 1986 (Proposition 65), please visit <https://www.lftechsupport.com/web/guest/environment-regulations-information>.

# SPECIFICATIONS

## Premium Seat

**Max User Weight:** 450 lbs (204kg)

**Length:** 24 in. (61cm)

**Height:** 42 in. (107cm)

**Width:** 25 in. (64cm)

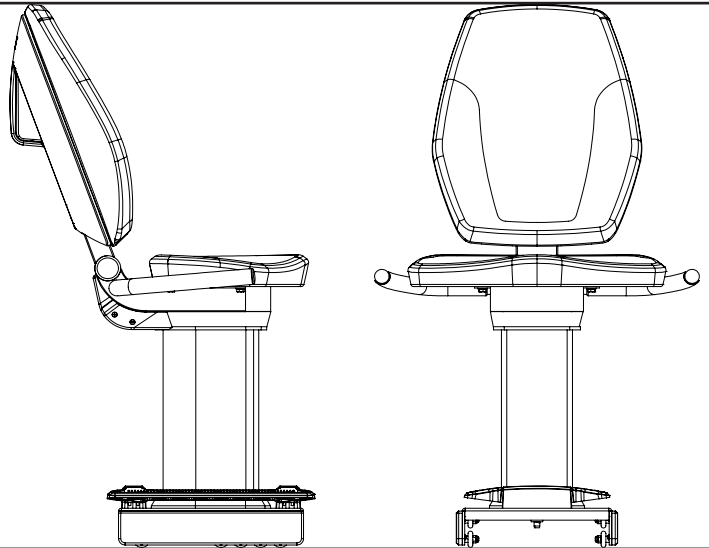
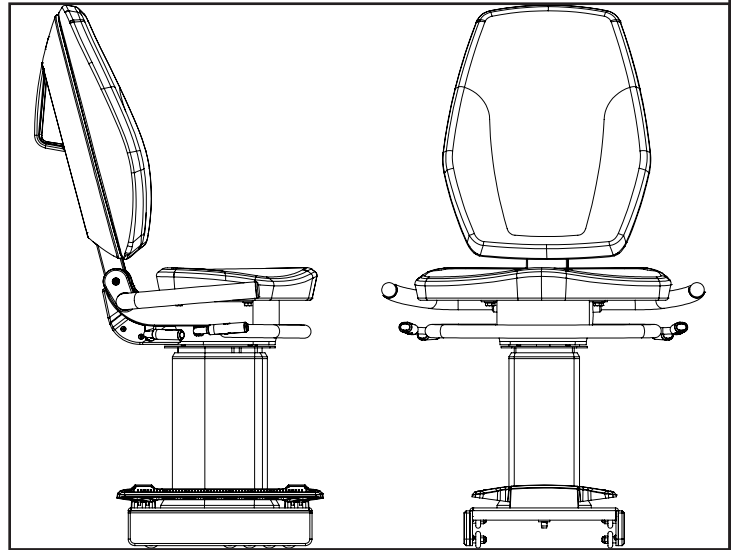

## Standard Seat

**Max User Weight:** 500 lbs (227kg)

**Length:** 24 in. (61cm)

**Height:** 42 in. (107cm)

**Width:** 25 in. (64cm)

## Bariatric Seat

**Max User Weight:** 600 lbs (272kg)

**Length:** 24 in. (61cm)

**Height:** 42 in. (107cm)

**Width:** 28 in. (71cm)

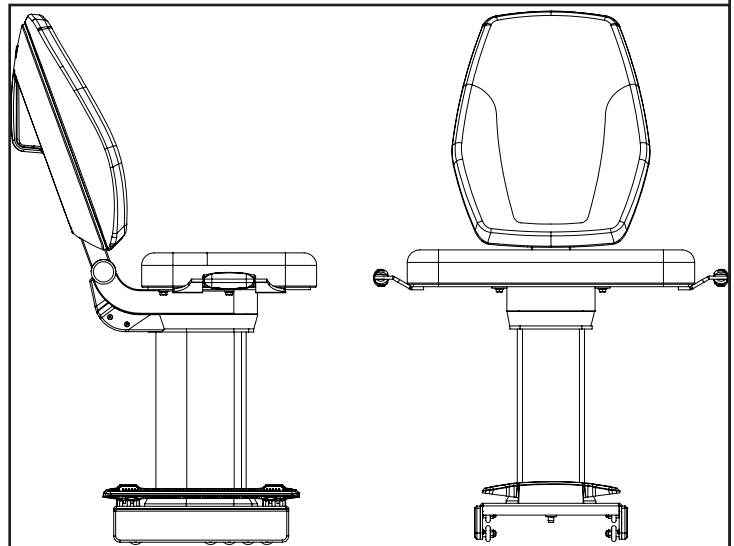

# PREMIUM SEAT ASSEMBLY

## Components:

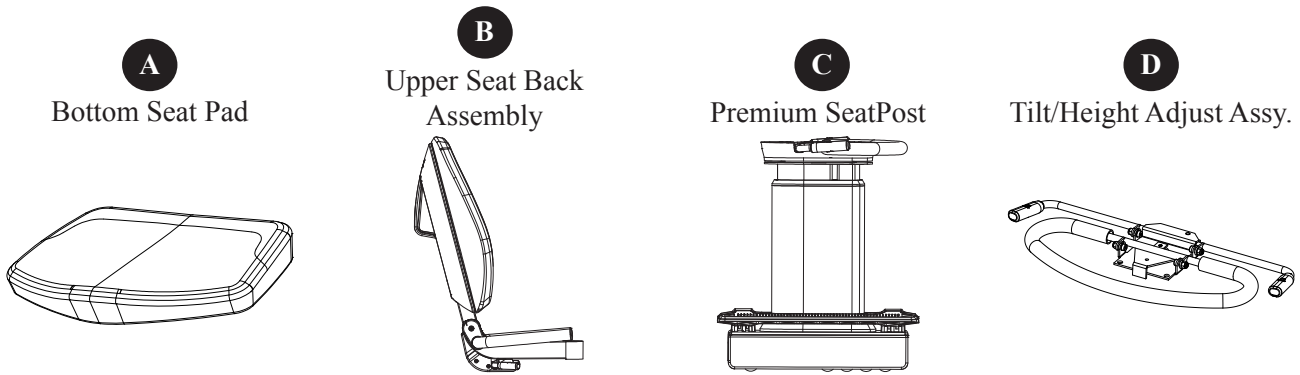

## Hardware Bag and Hardware Content

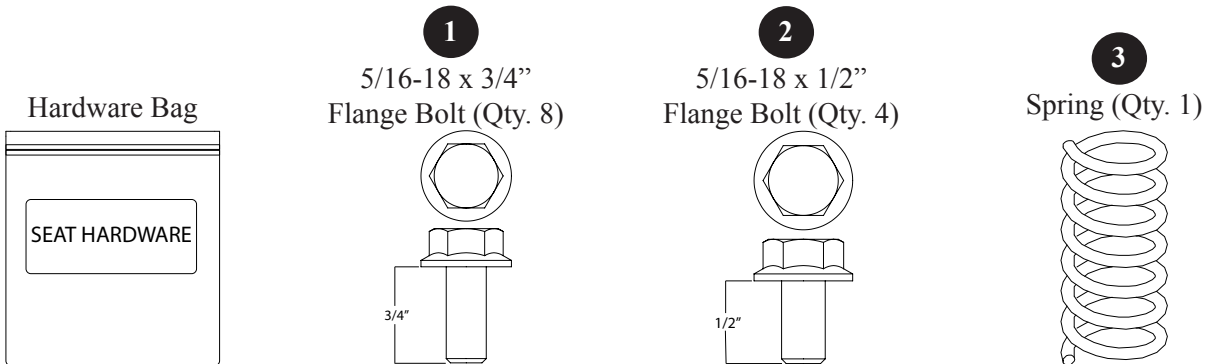

Required Tools: • 1/2" (13mm) Socket • 3" (76mm) Ratchet Extension • Ratchet

**ATTENTION**  
HOLD SPRING WHEN PLACING THE  
ASSEMBLY ONTO THE POST.

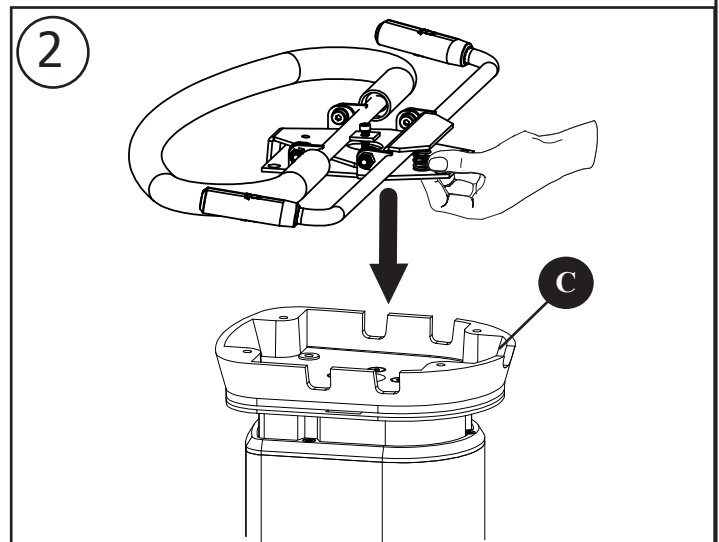
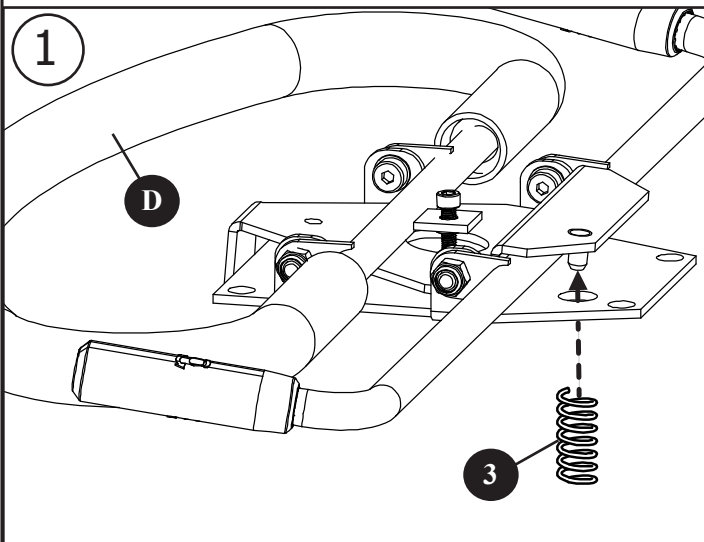

# PREMIUM SEAT ASSEMBLY

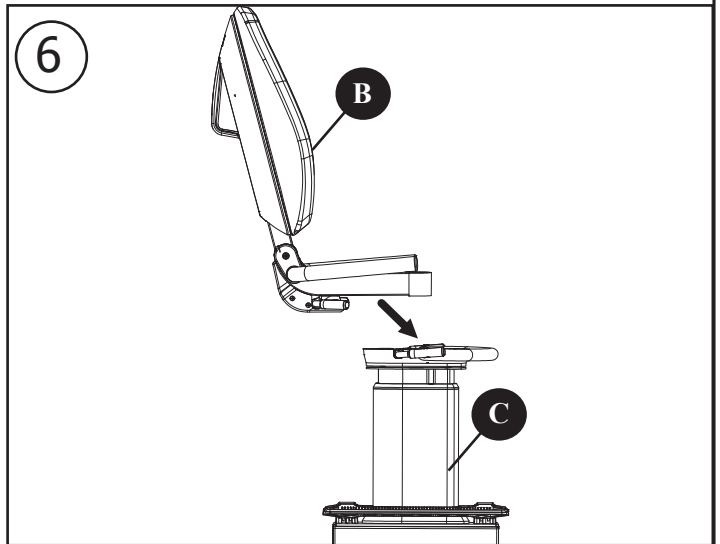
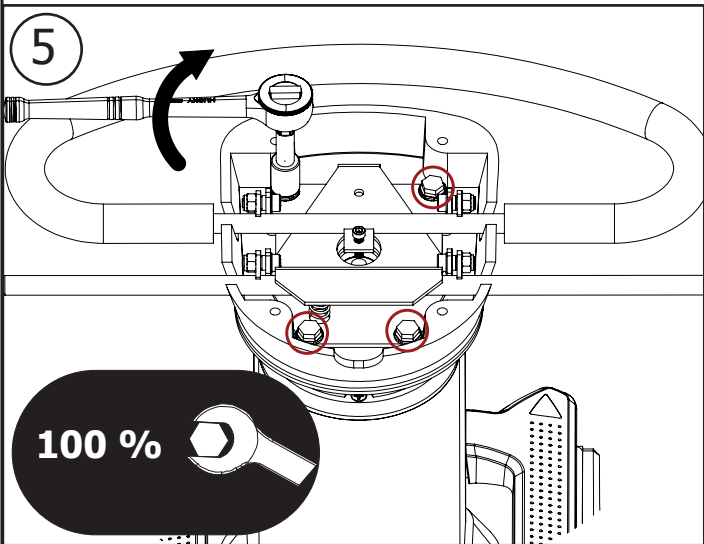
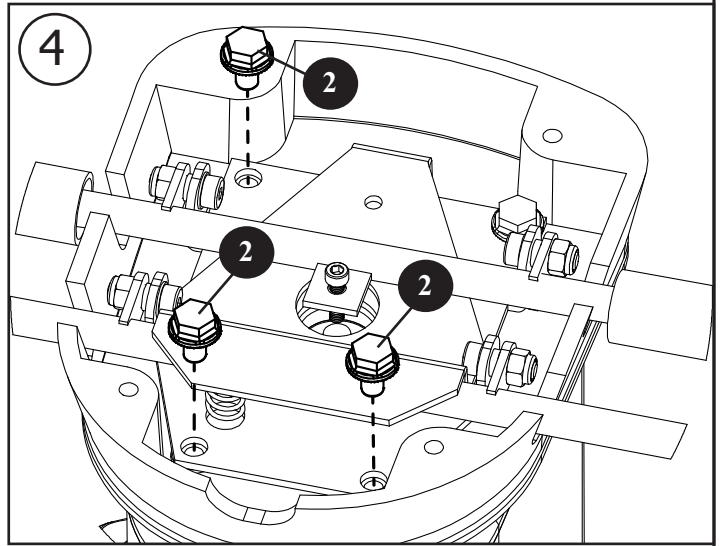
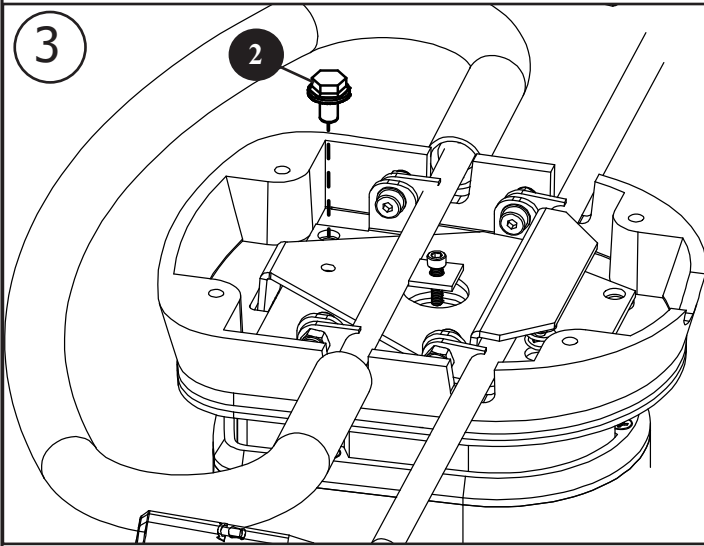

**⚠ ATTENTION**  
THE UPPER SEAT SECTION IS UNBALANCED. STABILIZE THE SEAT SECTION BY HOLDING THE UPPER REAR PAD HANDLE WHEN SECURING TO THE SEATPOST.

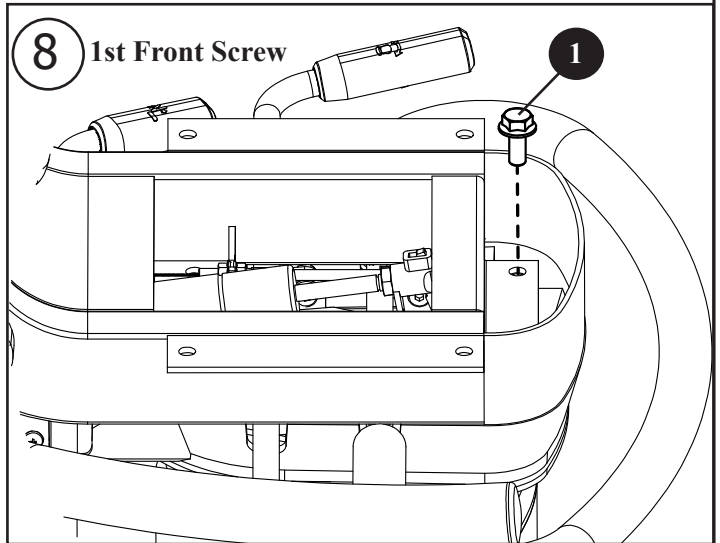
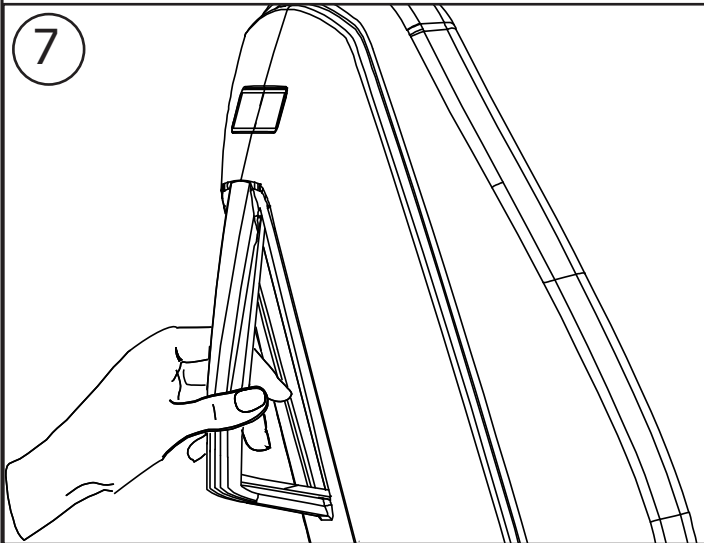

# PREMIUM SEAT ASSEMBLY

9 2nd Front Screw

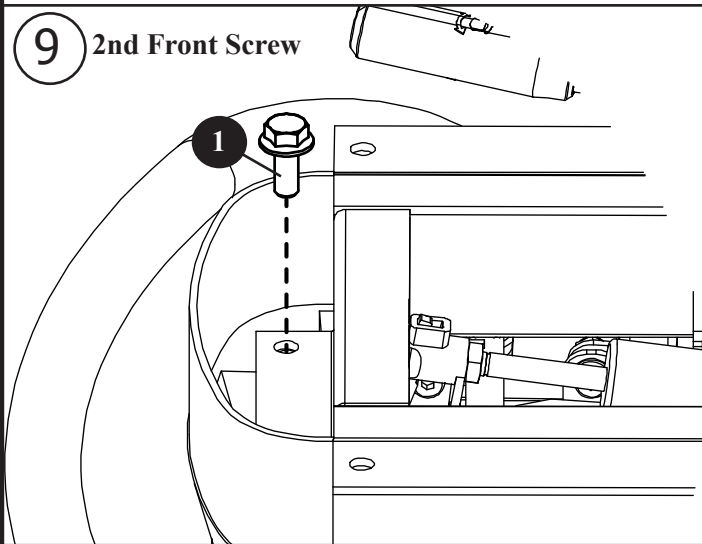

10 Rear Screws

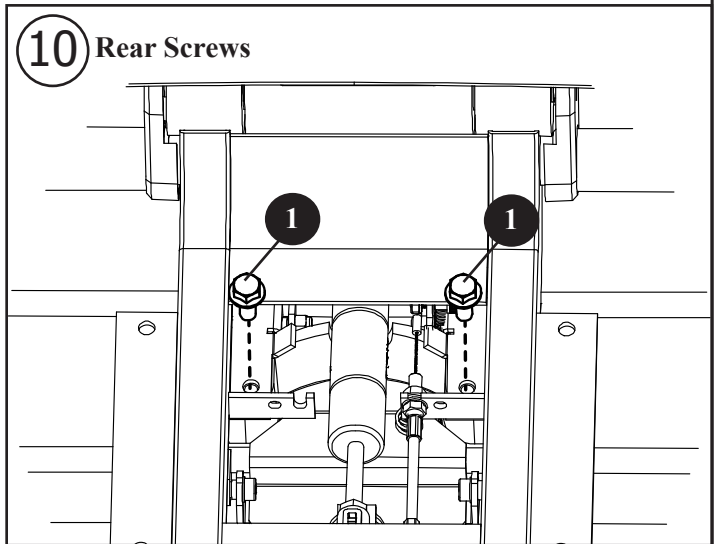

11

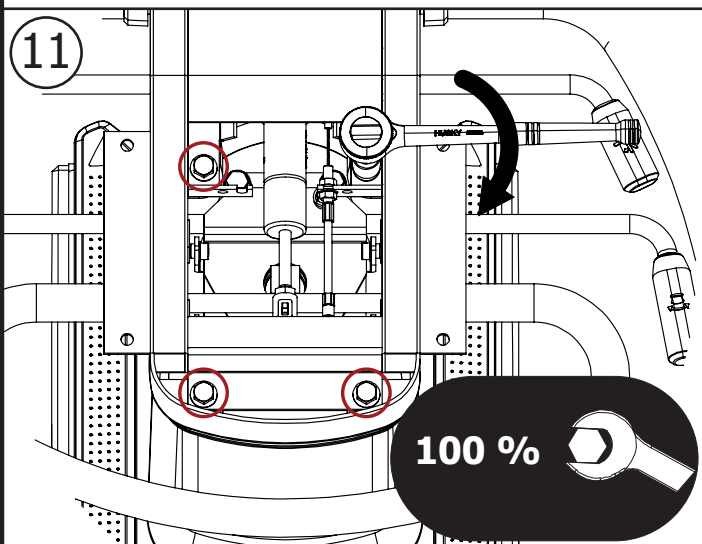

12



13 Right User Side

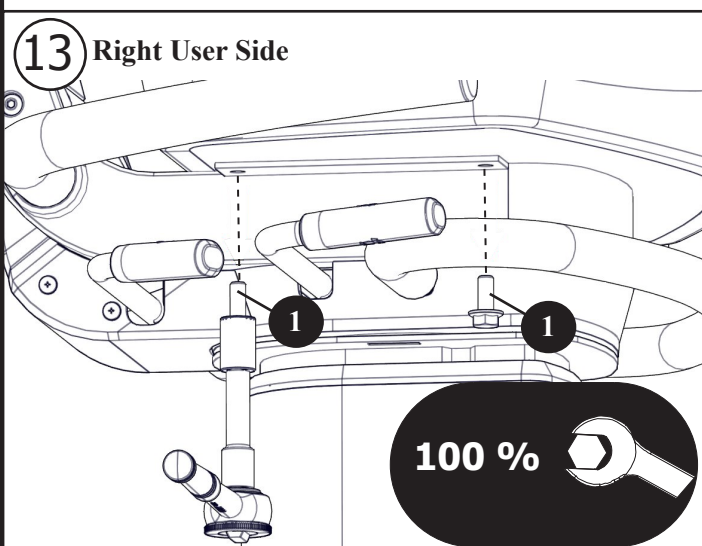

14 Left User Side

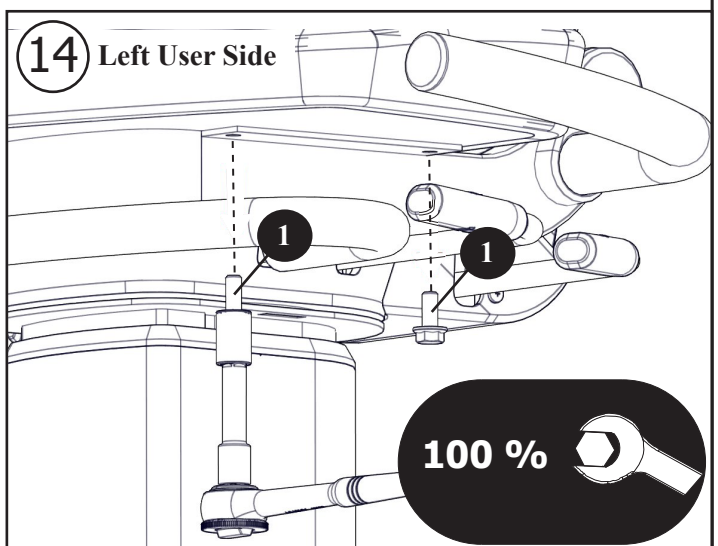

15 Refer to the seat system user's manual to test the height, tilt and swivel functions of the seat assembly.

# STANDARD SEAT ASSEMBLY

## Components:

## Hardware Bag and Hardware Content

**A**

Bottom Seat Pad

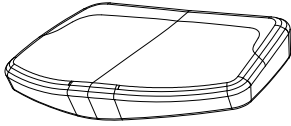

**B**

Standard Upper  
Seat Back Assembly

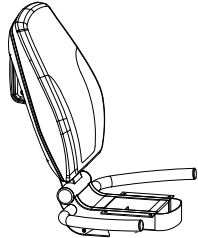

**C**

Standard SeatPost

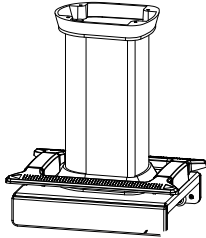

**1**

5/16-18 x 3/4"  
Flange Bolt (Qty. 8)

Hardware Bag

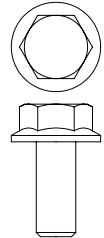
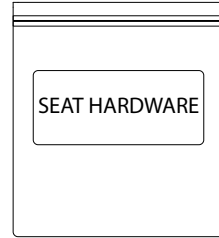

Required Tools: • 1/2" (13mm) Socket • 3" (76mm) Ratchet Extension • Ratchet

## **!** ATTENTION

THE UPPER SEAT SECTION IS UNBALANCED. STABILIZE THE SEAT SECTION BY HOLDING THE UPPER REAR PAD HANDLE WHEN SECURING TO THE SEATPOST.

1

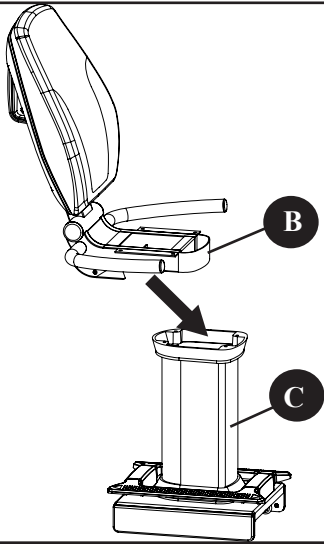

2

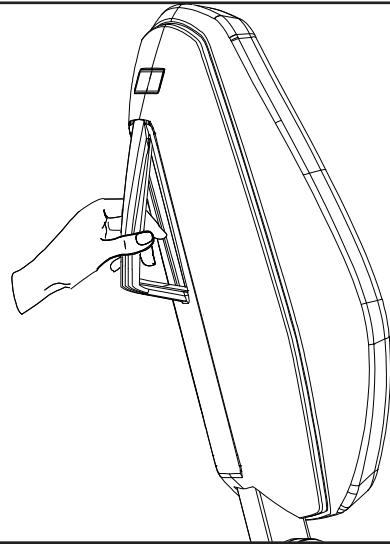

3

1st Front Screw

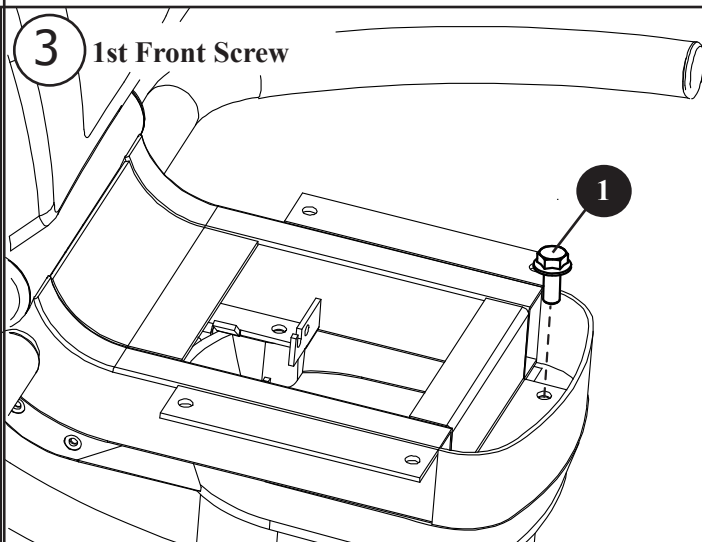

4

2nd Front Screw

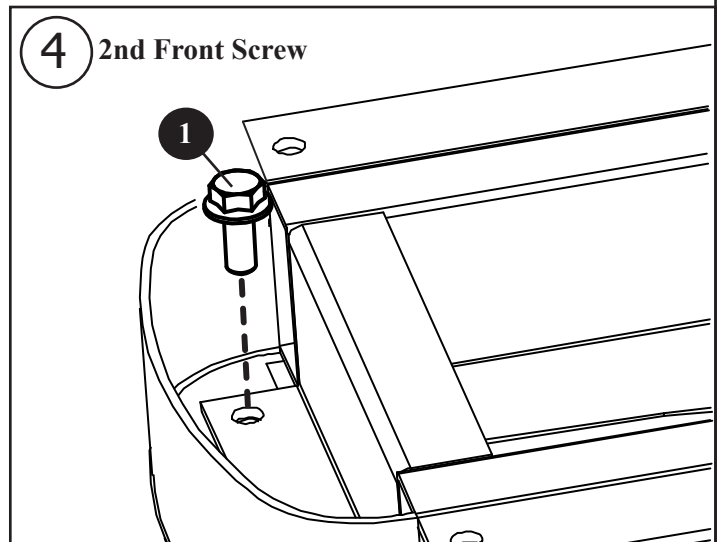

# STANDARD SEAT ASSEMBLY

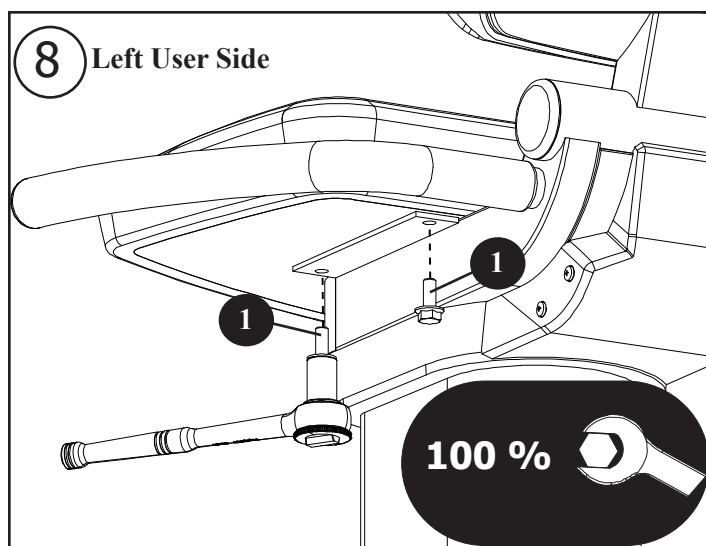
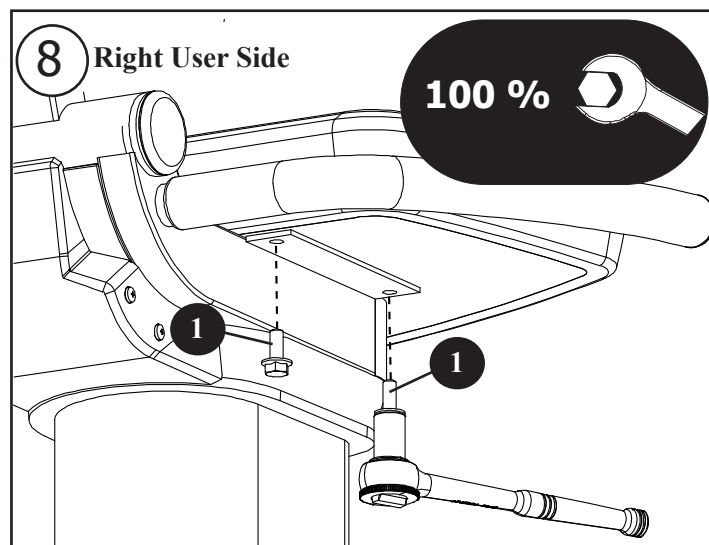
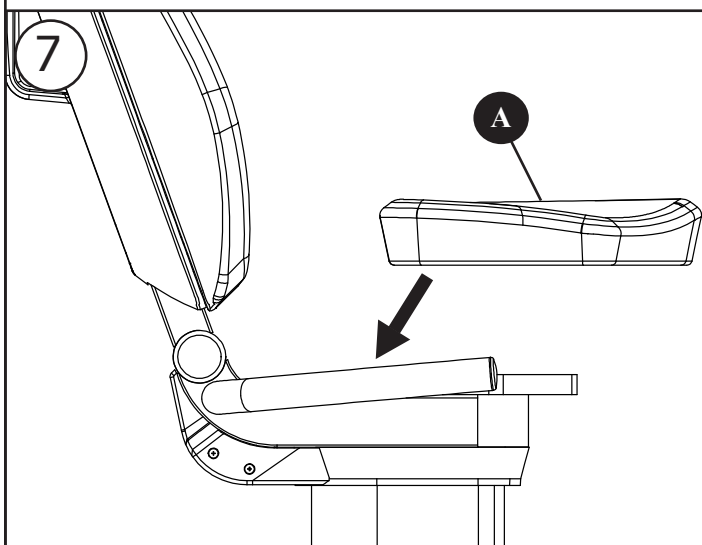
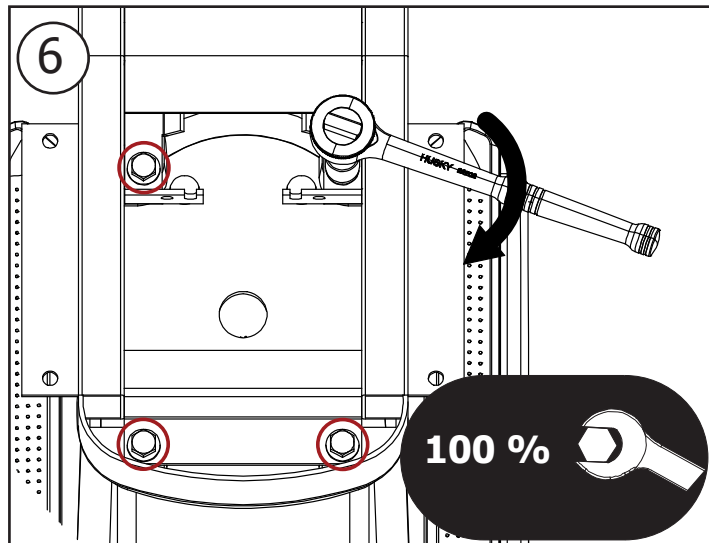
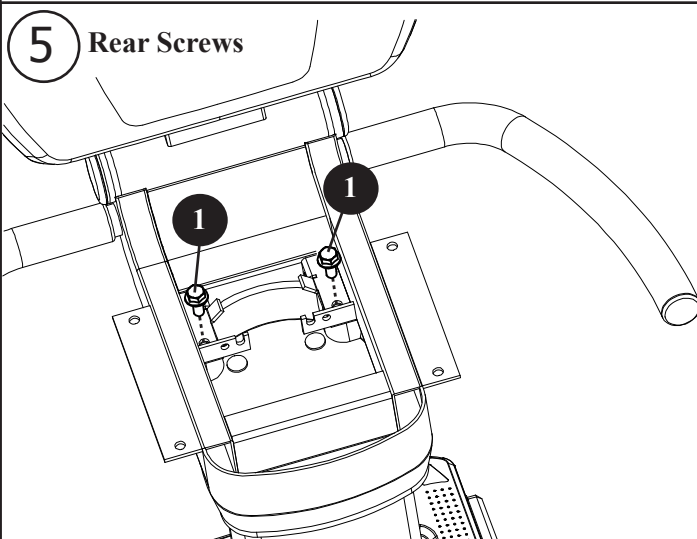

# BARIATRIC SEAT ASSEMBLY

## Components:

**A**

Bariatric Bottom Seat Pad

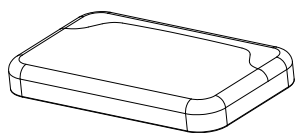

**B**

Bariatric Upper Seat Back Assembly

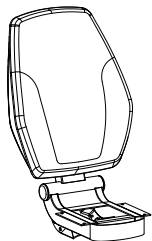

**C**

Bariatric SeatPost

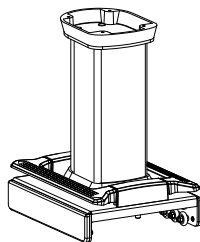

**D**

Bariatric Seat Pad Weldment

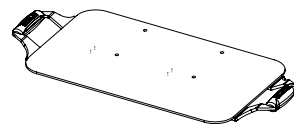

## Hardware Bag and Hardware Content

**1**

5/16-18 x 3/4"  
Flange Bolt (Qty. 8)

Hardware Bag

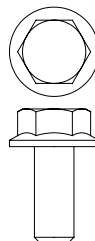
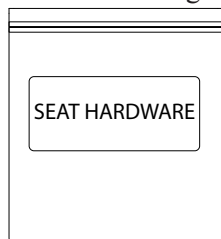

**Required Tools:** • 1/2" (13mm) Socket • 3" (76mm) Ratchet Extension • Ratchet

## **!** ATTENTION

THE UPPER SEAT SECTION IS UNBALANCED. STABILIZE THE SEAT SECTION BY HOLDING THE UPPER REAR PAD HANDLE WHEN SECURING TO THE SEATPOST.

**1**

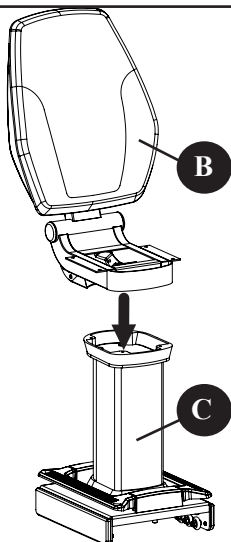

**2**

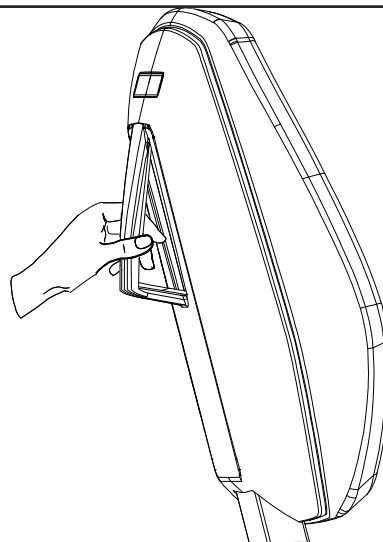

# BARIATRIC SEAT ASSEMBLY

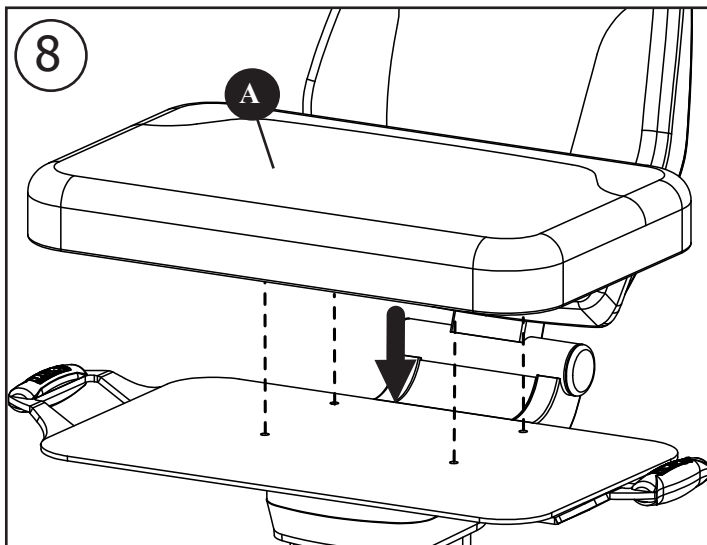
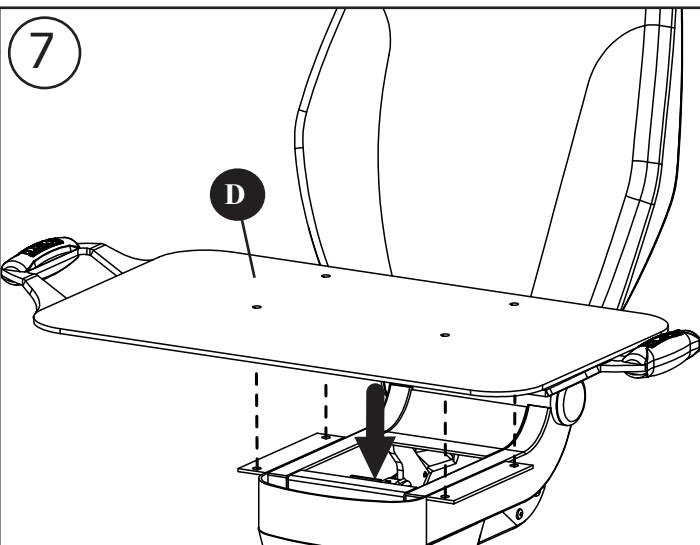
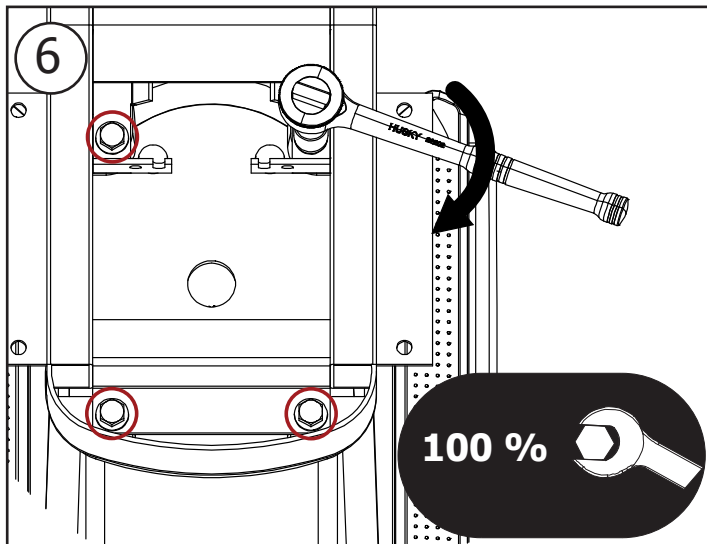
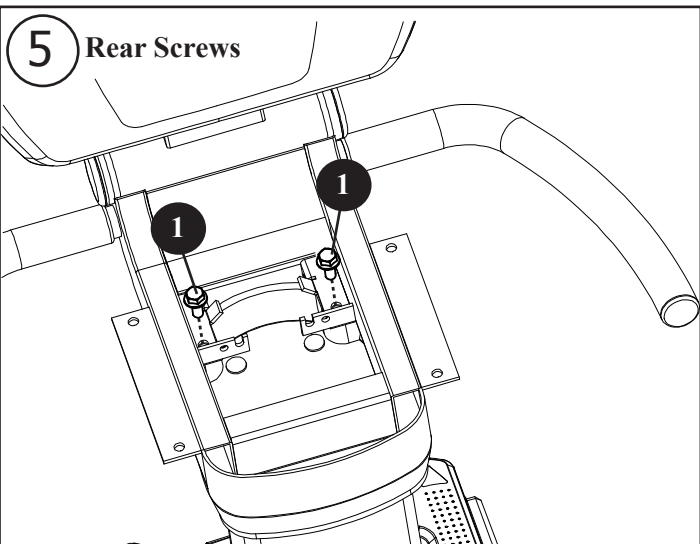
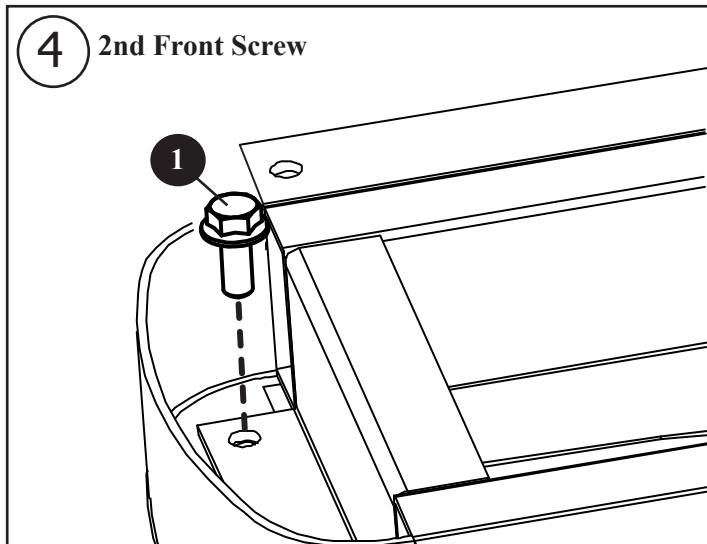
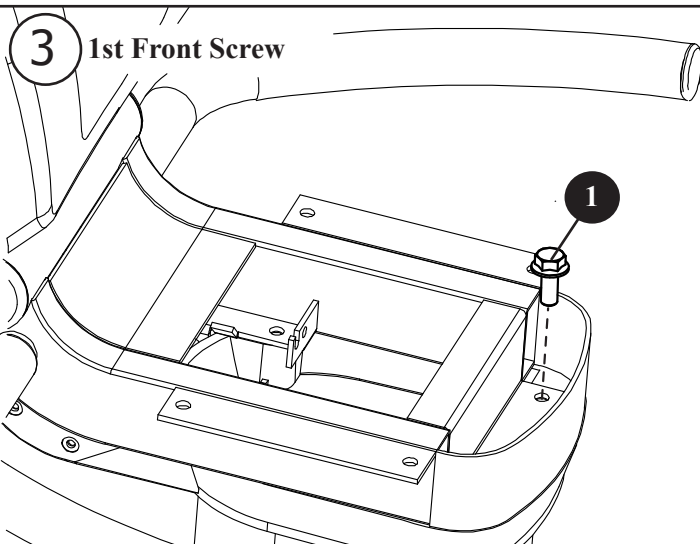

# BARIATRIC SEAT ASSEMBLY

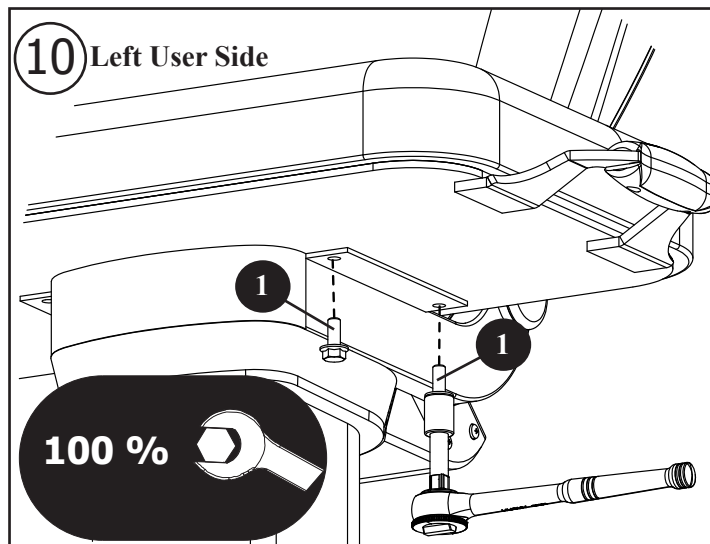
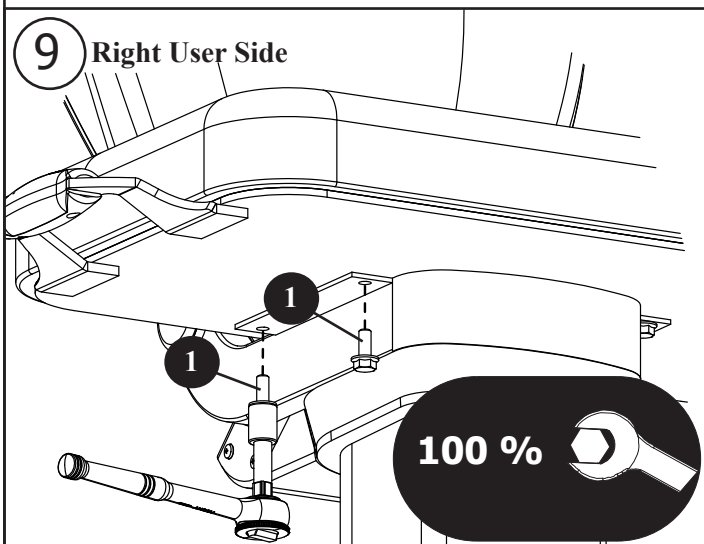

## PLACING THE SEAT ASSEMBLY ONTO THE MACHINE

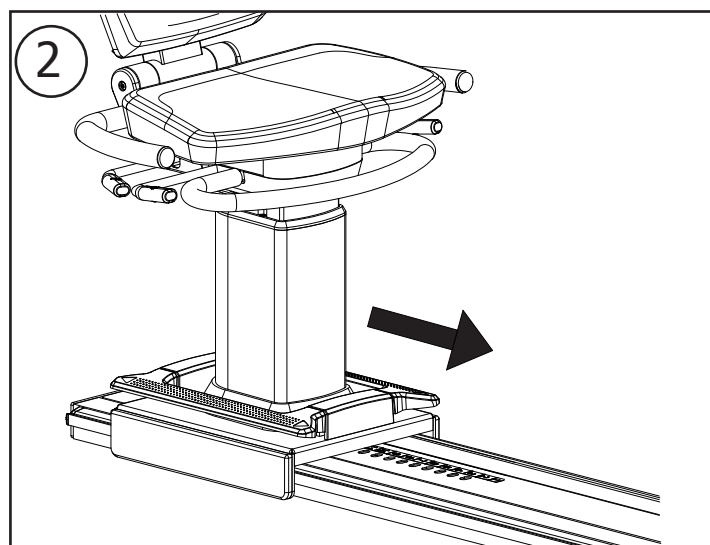
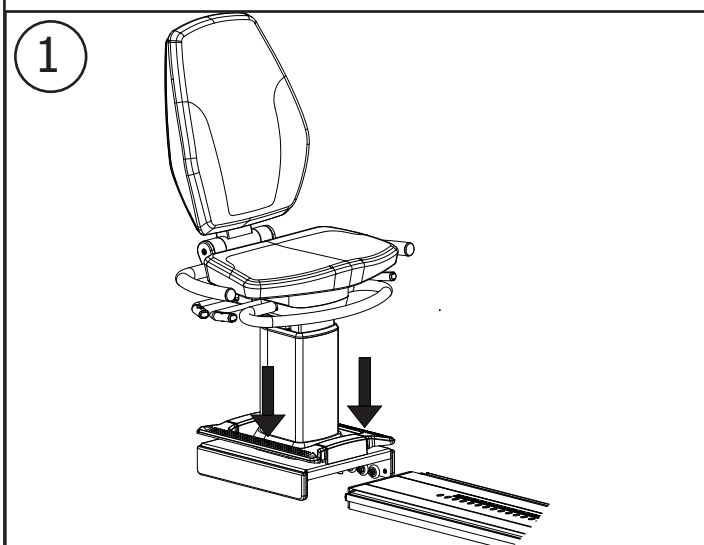

# WARRANTY

## WARRANTY INFORMATION

### WHAT IS COVERED.

This SCIFIT commercial exercise equipment ("Product") is warranted to be free of all defects in material and workmanship.

### WHO IS COVERED.

The original purchaser or any person receiving a newly purchased Product as a gift from the original purchaser. Warranty will be voided on subsequent transfers.

### HOW LONG IS IT COVERED.

All coverage is provided by specific Product according to the guidelines listed on the chart below.

### WHO PAYS TRANSPORTATION & INSURANCE FOR SERVICE.

If the Product or any covered part must be returned to a service facility for repairs, We, SCIFIT, will pay all transportation and insurance charges for the first year. You are responsible for transportation and insurance charges during the second and third years (if applicable).

### WHAT WE WILL DO TO CORRECT COVERED DEFECTS.

We will ship to you any new or rebuilt replacement part or component, or, at our option, replace the Product. Such replacement parts are warranted for the remaining portion of the original warranty period.

### WHAT IS NOT COVERED.

Any failures or damage caused by unauthorized service, misuse, accident, negligence, improper assembly or installation, debris resulting from any construction activities in the Product's environment, rust or corrosion as a result of the Product's location, alterations or modifications without our written authorization or by failure on your part to use, operate and maintain the Product as set out in your Operation Manual ("Manual").

One type RJ45 interchangeable Network ready and Fitness Entertainment port is supplied with the Product. This port complies with the FitLinxx CSAFE specification dated August 4, 2004 stating: 4.75VDC to 10VDC; maximum current of 85mA. Any Product damage caused by a load exceeding this FitLinxx CSAFE specification is not covered by warranty.

All terms of this warranty are void if this product is moved beyond the continental borders of the United States of America (excluding Alaska, Hawaii and Canada) and are then subject to the terms provided by that country's local authorized SCIFIT representative.

Detailed warranty guidelines are available at:  
<http://www.SCIFIT.com/Support/Service information/Warranty and Product Information/>

### WHAT YOU MUST DO.

Register your Product online at <http://www.SCIFIT.com/warrantyregistration.shtml/>. Retain proof of purchase; use, operate and maintain the Product as specified in the Manual; notify Customer Support Services of any defect within 10 days after discovery of the defect; if instructed, return any defective part for replacement or, if necessary, the entire Product for repair.

**OPERATION MANUAL:** It is VERY IMPORTANT THAT YOU READ THE MANUAL before operating the Product. Remember to perform the periodic maintenance requirements specified in the Manual to assure proper operation and your continued satisfaction.

### HOW TO GET REPLACEMENT PARTS & SERVICE.

Refer to page one of this manual for your local service contact information. Reference your name, address and the serial number of your Product. They will tell you how to get a replacement part, or, if necessary, arrange for service where your Product is located.

### EXCLUSIVE WARRANTY.

THIS LIMITED WARRANTY IS IN LIEU OF ALL OTHER WARRANTIES OF ANY KIND EITHER EXPRESSED OR IMPLIED, INCLUDING BUT NOT LIMITED TO THE IMPLIED WARRANTIES OF MERCHANTABILITY AND FITNESS FOR A PARTICULAR PURPOSE, AND ALL OTHER OBLIGATIONS OR LIABILITIES ON OUR PART. We neither assume nor authorize any person to assure for us any other obligation or liability concerning the sale of this Product. Under no circumstances shall we be liable under this warranty, or otherwise, of any damage to any person or property, including any lost profits or lost savings, for any special, indirect, secondary, incidental or consequential damages of any nature arising out of the use of or inability to use this Product. Some states do not allow the exclusion or limitation of implied warranties or of liability for incidental or consequential damages, so the above limitations or exclusions may not apply to you. Warranty coverages and terms may differ outside the United States. Please contact the SCIFIT office servicing your country (contact information found at the front of this manual) or visit the applicable local SCIFIT website to receive the specific warranty information for your country.

### CHANGES IN WARRANTY NOT AUTHORIZED.

No one is authorized to change, modify or extend the terms of this limited warranty.

### EFFECT OF STATE LAWS.

This warranty gives you specific legal rights and you may have other rights which vary from state to state and country by country.

### OUR PLEDGE TO YOU.

Our Products are designed and manufactured to the highest standards. We want you completely satisfied with our Products and will do everything possible under the terms of this warranty to keep you secure in knowing you have bought the best!

Item	6 months	1 Year	3 Years	5 Years
Frame				X
Electrical			X	
Mechanical			X	
Labor		X		
Upholstery, Seats, Grips, Walk belts, Decks		X		
Battery		X		
High Wear Items (Heartrate Straps, Pedal Straps)	X			



**Prescribed for Progress™**