

# E1 TOTAL- BODY ELLIPTICAL CROSS-TRAINER

ASSEMBLY INSTRUCTIONS

M051-00K102-0007 REV B



# CORPORATE HEADQUARTERS

Columbia Centre III, 9525 West Bryn Mawr Avenue, Rosemont, Illinois 60018 • U.S.A.

847.288.3300 • FAX: 847.288.3703

Service phone number: 800.351.3737 (toll-free within U.S.A., Canada)

Global Website: [www.lifefitness.com](http://www.lifefitness.com)

## INTERNATIONAL OFFICES

### AMERICAS

#### North America Life Fitness, Inc.

Columbia Centre III  
9525 West Bryn Mawr Avenue  
Rosemont, IL 60018 U.S.A  
Telephone: (847) 288 3300  
Fax: (847) 288 3703  
Service Email: [customersupport@lifefitness.com](mailto:customersupport@lifefitness.com)  
Service Website: [www.lifefitness.com/parts](http://www.lifefitness.com/parts)  
Sales/Marketing Email:  
[consumerproducts@lifefitness.com](mailto:consumerproducts@lifefitness.com)  
Operating Hours: 7:00 am-6:00 pm (CST)

#### Brazil Life Fitness Brasil

Av. Cidade Jardim, 900  
Jd. Paulistano  
São Paulo, SP 01454-000  
BRAZIL  
SAC: 0800 773 8282  
Telephone: +55 (11) 3095 5200  
Fax: +55 (11) 3095 5201  
Service Email: [suporte@lifefitness.com.br](mailto:suporte@lifefitness.com.br)  
Sales/Marketing Email: [lifefitness@lifefitness.com.br](mailto:lifefitness@lifefitness.com.br)  
Service Operating Hours:  
9:00 - 17:00 (BRT) (Monday-Friday)  
Store Operating Hours:  
9:00 - 20:00 (BRT) (Monday-Friday)  
10:00 - 16:00 (BRT) (Saturday)

#### Latin America & Caribbean\* Life Fitness Inc.

Columbia Centre III  
9525 West Bryn Mawr Avenue  
Rosemont, IL 60018 U.S.A  
Telephone: (847) 288 3300  
Fax: (847) 288 3703  
Service Email: [customersupport@lifefitness.com](mailto:customersupport@lifefitness.com)  
Sales/Marketing Email:  
[consumerproducts@lifefitness.com](mailto:consumerproducts@lifefitness.com)  
Operating Hours: 7:00am-6:00pm (CST)

### EUROPE, MIDDLE EAST, & AFRICA (EMEA)

#### Netherlands & Luxemburg Life Fitness Atlantic BV

Bijdorpplein 25-31  
2992 LB Barendrecht  
THE NETHERLANDS  
Telephone: (+31) 180 646 666  
Fax: (+31) 180 646 699  
Service Email: [service.benelux@lifefitness.com](mailto:service.benelux@lifefitness.com)  
Sales/Marketing Email:  
[marketing.benelux@lifefitness.com](mailto:marketing.benelux@lifefitness.com)  
Operating Hours: 9.00h-17.00h (CET)

#### United Kingdom & Ireland Life Fitness UK LTD

Queen Adelaide  
Ely, Cambs, CB7 4UB  
Telephone: General Office (+44)  
1353.666017  
Customer Support (+44) 1353.665507  
Fax: (+44) 1353.666018  
Service Email: [uk.support@lifefitness.com](mailto:uk.support@lifefitness.com)  
Sales/Marketing Email: [life@lifefitness.com](mailto:life@lifefitness.com)  
Operating Hours:  
General Office: 9.00am - 5.00pm (GMT)  
Customer Support: 8.30am - 5.00pm (GMT)

#### Germany & Switzerland Life Fitness Europe GMBH

Siemensstraße 3  
85716 Unterschleißheim  
GERMANY  
Telephone: (+49) 89.31 77 51.0 (Germany)  
(+41) 0848 000 901 (Switzerland)  
Fax: (+49) 89.31 77 51.99 (Germany)  
(+41) 043 818 07 20 (Switzerland)  
Service Email: [kundendienst@lifefitness.com](mailto:kundendienst@lifefitness.com)  
Sales/Marketing Email:  
[kundenberatung@lifefitness.com](mailto:kundenberatung@lifefitness.com)  
Operating Hours: 08.30 -16.30h (CET)

#### Austria Life Fitness Austria

Vertriebs G.m.b.H.  
Dückerstraße 7-9/3/36  
1220 Vienna  
AUSTRIA  
Telephone: (+43) 1.61.57.198  
Fax: (+43) 1.61.57.198.20  
Service Email: [kundendienst@lifefitness.com](mailto:kundendienst@lifefitness.com)  
Marketing/Sales Email:  
[kundenberatung@lifefitness.com](mailto:kundenberatung@lifefitness.com)  
Operating Hours: 08:30-16.30.h (MEZ)

#### Spain Life Fitness IBERIA

C/Frederic Mompou 5,1ªª  
08960 Sant Just Desvern Barcelona  
SPAIN  
Telephone: (+34) 93.672.4660  
Fax: (+34) 93.672.4670  
Service Email: [servicio.tecnico@lifefitness.com](mailto:servicio.tecnico@lifefitness.com)  
Sales/Marketing Email: [info.iberia@lifefitness.com](mailto:info.iberia@lifefitness.com)  
Operating Hours:  
9.00h-18.00h (Monday-Thursday)  
8.30h-15.00h (Friday)

#### Belgium Life Fitness Benelux NV

Parc Industriel de Petit-Rechain  
4800 Verviers  
BELGIUM  
Telephone: (+32) 87 300 942  
Fax: (+32) 87 300 943  
Service Email: [service.benelux@lifefitness.com](mailto:service.benelux@lifefitness.com)  
Sales/Marketing Email:  
[marketing.benelux@lifefitness.com](mailto:marketing.benelux@lifefitness.com)  
Operating Hours: 9.00h -17.00h (CET)

#### All Other EMEA Countries & Distributor Business C-EMEA\*

Bijdorpplein 25-31  
2992 LB Barendrecht  
THE NETHERLANDS  
Telephone: (+31) 180 646 644  
Fax: (+31) 180 646 699  
Service Email: [service.db.cemea@lifefitness.com](mailto:service.db.cemea@lifefitness.com)  
Sales/Marketing Email:  
[marketing.db.cemea@lifefitness.com](mailto:marketing.db.cemea@lifefitness.com)  
Operating Hours: 9.00h-17.00h (CET)

### ASIA PACIFIC (AP)

#### Japan Life Fitness Japan

Japan Nippon Brunswick Bldg., #8F  
5-27-7 Sendagaya  
Shibuya-Ku, Tokyo  
Japan 151-0051  
Telephone: (+81) 3.3359.4309  
Fax: (+81) 3.3359.4307  
Service Email: [service@lifefitnessjapan.com](mailto:service@lifefitnessjapan.com)  
Sales/Marketing Email: [sales@lifefitnessjapan.com](mailto:sales@lifefitnessjapan.com)  
Operating Hours: 9.00h-17.00h (JAPAN)

#### China and Hong Kong Life Fitness Asia Pacific LTD

Room 2610, Miramar Tower  
132 Nathan Road  
Tsimshatsui, Kowloon  
HONG KONG  
Telephone: (+852) 2891.6677  
Fax: (+852) 2575.6001  
Service Email: [HongKongEnquiry@lifefitness.com](mailto:HongKongEnquiry@lifefitness.com)  
Sales/Marketing Email:  
[ChinaEnquiry@lifefitness.com](mailto:ChinaEnquiry@lifefitness.com)  
Operating Hours: 9.00h-18.00h

#### All Other Asia Pacific countries & distributor business Asia Pacific\*

Room 2610, Miramar Tower  
132 Nathan Road  
Tsimshatsui, Kowloon  
HONG KONG  
Telephone: (+852) 2891.6677  
Fax: (+852) 2575.6001  
Service Email: [HongKongEnquiry@lifefitness.com](mailto:HongKongEnquiry@lifefitness.com)  
Sales/Marketing Email:  
[ChinaEnquiry@lifefitness.com](mailto:ChinaEnquiry@lifefitness.com)  
Operating Hours: 9.00h-18.00h

\* Also check [www.lifefitness.com](http://www.lifefitness.com) for local representation or distributor/dealer

# TABLE OF CONTENTS

1. Important Safety Instructions	3
2. E1 Total-Body Elliptical Cross-Trainer Overview	5
3. Initial Setup	6
4. Service and Technical Data	8
5. Assembly	10
6. Specifications	19

© 2014 Life Fitness, A division of Brunswick Corporation. All Rights Reserved. Life Fitness is a registered trademark of Brunswick Corporation. Discover, FitPower, Heart Rate+, LFconnect, Lifepulse, Lifescape, MaxBlox, PowerMill, SureStepSystem, Swipe and Workout Landscape are trademarks of Brunswick Corporation. FitLinxx is a trademark of Integrated Fitness Corp. Polar is a registered trademark of Polar Electro, Inc. iPad, iPhone and iPod are registered trademarks of Apple Inc. Android is a trademark of Google Inc. PM-038-13. (3.14) Fitlinxx is a trademark of Fitlinxx, Inc. Polar is a registered trademark of Polar Electro, Inc. Gym Wipes® is a registered trademark of The 2XL Corporation. PureGreen 24 is a trademark of Pure Green.

# 1 IMPORTANT SAFETY INSTRUCTIONS

 **CAUTION:** Any changes or modifications to this equipment could void the product warranty.

 **WARNING:** Read all instructions before using this product.

 **WARNING:** Heart rate monitoring systems may be inaccurate. Over exercising may result in serious injury or death. If you feel faint, stop exercising immediately.

 **DANGER:** To reduce the risk of electrical shock, always unplug this Life Fitness product before cleaning or attempting any maintenance activity.

 **The heart rate hand pulse sensors provide an approximate heart rate value. The sensors are not medical devices and should not be used in any type of medical application.**

- Before using this product, it is essential to read the ENTIRE operation manual and ALL instructions. The cross-trainer is intended for use solely in the manner described in this manual.
- Position the product so that the power cord plug to the wall is accessible to the user. Make sure that the power cord is not knotted or twisted and that it is not trapped under any equipment or other objects.
- If the electrical supply cord is damaged, it must be replaced by the manufacturer, an authorized service agent, or a similarly qualified person to avoid hazard.
- Always follow the console instructions for proper operation.
- This appliance is not intended for use by persons (including children) with reduced physical, sensory or mental capabilities, or lack of experience and knowledge, unless they have been given supervision or instruction concerning use of the appliance by a person responsible for their safety.
- Children should be supervised to ensure that they do not play with the appliance.
- Never insert objects into any openings in this product. If an object should drop inside, turn off the power, unplug the power cord from the outlet and carefully retrieve it. If the item cannot be reached, contact Life Fitness Customer Support Services.
- Never place liquids of any type directly on the unit, except in an accessory tray. Containers with lids are recommended.
- Do not use the exercise cross-trainer outdoors, near swimming pools or in areas of high humidity.
- Keep all loose clothing, shoelaces, and towels away from the cross-trainer pedals.
- Keep the area around the cross-trainer clear of any obstructions, including walls and furniture. Make sure there are 2 feet (0.6 meters) on each side of the cross-trainer.
- Use caution when mounting or dismounting the cross-trainer.
- Never operate a Life Fitness product if it has been dropped, damaged, or even partially immersed in water. Contact Life Fitness Customer Support Services.

- Keep the power cord away from heated surfaces. Do not pull the equipment by the power cord or use the power cord as a handle.
- Do not run the power cord on the floor under or along side of the cross-trainer.
- Wear shoes with rubber or high-traction soles. Do not use shoes with heels, leather soles, cleats or spikes. Do not use the cross-trainer in bare feet.
- Do not tip the cross-trainer on its side during operation.
- Keep hands and feet away from all moving parts.
- To ensure proper functioning of this product, do not install attachments or accessories that are not provided or recommended by Life Fitness.
- Use this product in a well-ventilated area.
- Use this product on a solid, level surface.
- Make sure that all components are fastened securely.
- An appliance should never be left unattended when plugged in. Unplug from outlet when not in use, and before putting on or taking off parts.
- Do not operate under blanket or pillow. Excessive heating can occur and cause fire, electric shock, or injury to persons.
- Never operate this appliance if it has a damaged cord or plug, if it is not working properly, if it has been dropped or damaged, or dropped into water. Contact Life Fitness Customer Support Services.
- Never operate the appliance with the air openings blocked. Keep the air openings free of lint, hair, and the like.
- To disconnect, turn all controls to the off position, then remove plug from outlet.
- Allow LCD consoles to “normalize” with respect to temperature for one hour before plugging the unit in and/or using.
- Do not allow other people to interfere in any way with the user or equipment during a workout.
- Read all warnings on the product prior to starting a workout.

**CAUTION: Health-related injuries may result from incorrect or excessive use of exercise equipment. LIFE FITNESS STRONGLY recommends seeing a physician for a complete medical exam before undertaking an exercise program, particularly if the user has a family history of high blood pressure or heart disease, is over the age of 45, smokes, has high cholesterol, is obese, or has not exercised regularly in the past year.**

If, at any time while exercising, the user experiences faintness, dizziness, pain, or shortness of breath, he or she must stop immediately.

**SAVE THESE INSTRUCTIONS FOR  
FUTURE REFERENCE.**

# 2 E1 TOTAL-BODY ELLIPTICAL CROSS-TRAINER OVERVIEW

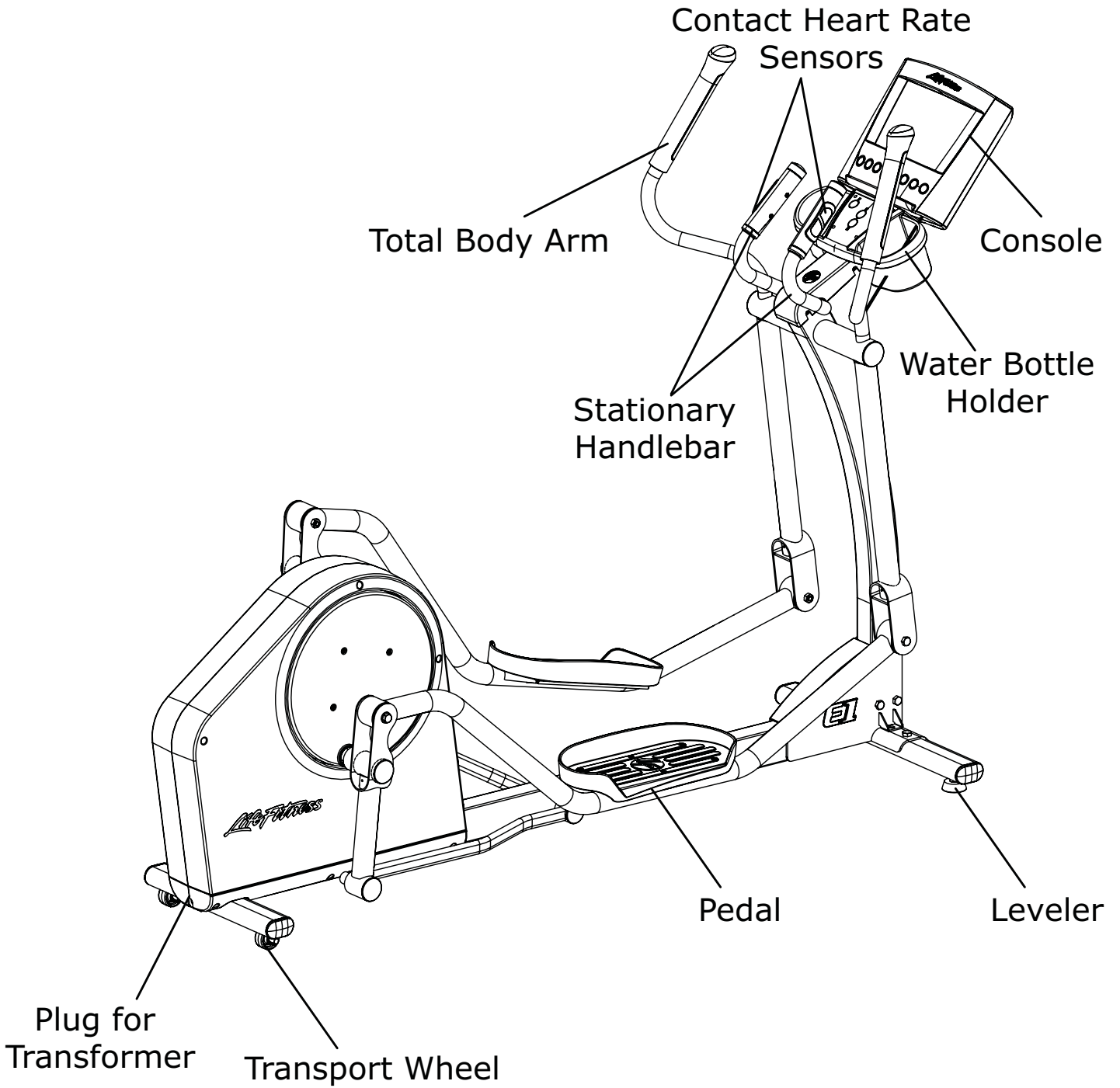

# 3 INITIAL SETUP

Read the entire User Manual before setting up the Total-Body Elliptical Cross-Trainer.

**Note:** This Total Body Elliptical Cross-Trainer is speed independent. Resistance can be adjusted by means other than speed.

**DANGER:** Improper connection of the equipment-grounding conductor can result in a risk of electric shock. Check with a qualified electrician or service technician if you are in doubt as to whether the product is properly grounded. Do not modify the plug provided with the product. If it will not fit the outlet, have a proper outlet installed by a qualified electrician.

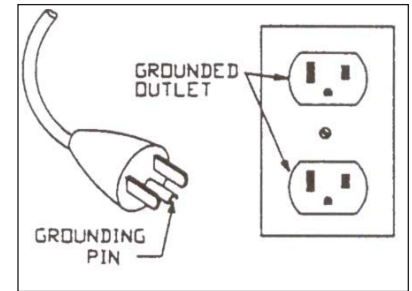

## Where to Place the Total-Body Elliptical Cross-Trainer

After following all Safety Instructions move the Total-Body Elliptical Cross-Trainer to the place where it will be used. Allow a minimum clearance of 2 feet (0.6 meter) around the product. See *Specifications* for full dimensions if needed. The Total-Body Elliptical Cross-Trainer is equipped with front and rear wheels so that it is simple to push or pull the Total-Body Elliptical Cross-Trainer to its final destination. To use the wheels make sure that the levelers are twisted up far enough so that all wheels (A) can engage with the floor. Once the Total-Body Elliptical Cross-Trainer is properly positioned, allow enough space in the front of the Total-Body Elliptical Cross-Trainer for the movement of the pedal levers. Also be sure to allow space on the side so that it is easy to mount the Total-Body Elliptical Cross-Trainer from the side.

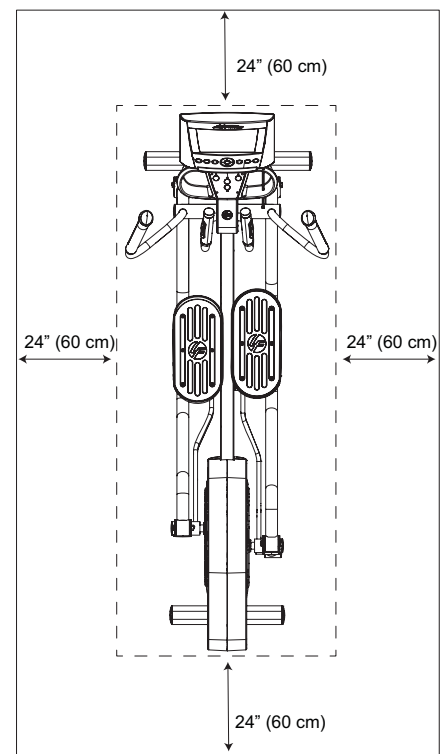
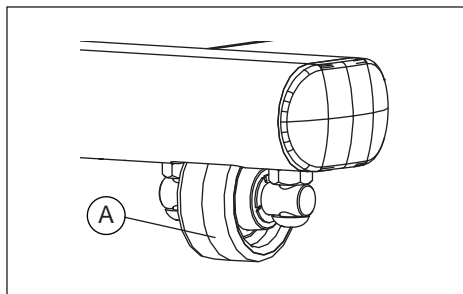

**CAUTION:** Make certain you have plenty of room for the swing of the moving arms.

**CAUTION:** Place Total-Body Elliptical Cross-Trainer in a dry place. Do not place in highly humid areas, like near swimming pools, as rust and corrosion may occur.

## How to Stabilize the Total-Body Elliptical Cross-Trainer

Once the cross-trainer is positioned in the room lower the levelers (B) on the front stabilizer to contact the floor. All four wheels must be completely off the floor. The levelers will keep the cross-trainer fixed to the floor while using it.

**CAUTION:** Do not use the Total-Body Elliptical Cross-Trainer without the levelers touching the floor.

After placing the Total-Body Elliptical Cross-Trainer where it will be used, check the stability. If there is even a slight rocking motion, or the unit is not stable the levelers will need to be adjusted. Determine which leveler is not resting firmly on the floor. To adjust the levelers downward twist the rubber portion of the leg counterclockwise. To adjust the levelers upward twist the rubber portion of the leg clockwise. After adjusting the levelers, tighten the jam nuts (D) against the stabilizer to lock the levelers in place.

**Note:** After the Cross-Trainer is level, be sure to tighten the nut on the leveler against the stabilizer tube. If this is not tightened, noise will occur.

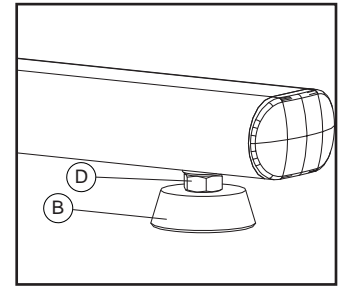

## Powering Up the Total-Body Elliptical Cross-Trainer

Your Life Fitness Total-Body Elliptical Cross-Trainer may come with either a U.S. power supply or one of several international power supplies. Insert the appropriate power adapter jack into the connector (C) on the back of the Total-Body Elliptical Cross-Trainer. Then Insert the plug into the wall outlet. Make sure the cord is placed so it doesn't bind and will not be walked on. Then check that the console lights up. If not, recheck the plug and the wall connections and make sure the wall outlet has power.

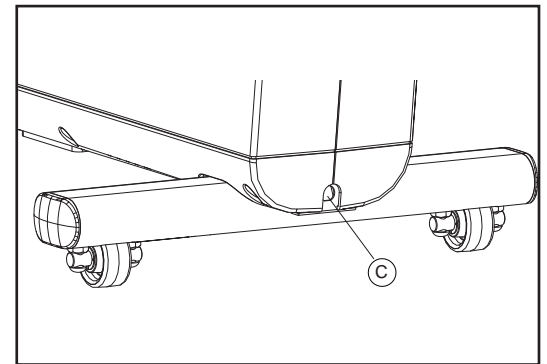

## Mounting the Machine

When mounting the machine it is recommended that the pedal closest to you is in its lowest position. This can be done by pushing the arms to rotate the pedal until it is centered to the side of you at its lowest position. If you are standing to the left side of the machine, when facing the console, place your left foot on the pedal closest to you and then swing your right leg over the right pedal. Use the stationary handlebar to stabilize yourself.

## Dismounting the Machine

Bring the machine to a stop. It is recommended to put the pedal in its lowest position on the side of the unit you will be dismantling. If dismantling the machine on the left side, when facing the console, step off with the right leg first followed by the left leg. Use the stationary handlebar for stabilization.

# 4 SERVICE AND TECHNICAL DATA

## 4.1 PREVENTIVE MAINTENANCE TIPS

The Life Fitness Total Body Elliptical Cross-Trainer is backed by the engineering excellence and reliability of Life Fitness and is one of the most rugged and trouble-free pieces of exercise equipment on the market today.

**Note:** Safety of the equipment can be maintained only if the equipment is examined regularly for damage or wear. Keep the equipment out of use until the defective parts are required or replaced. Pay special attention to parts that are subject to wear, as outlined below.

The following preventative maintenance tips will keep the Life Fitness Total Body Elliptical Cross-Trainer operating at Peak performance:

<b>Important:</b> Turn the cross-trainer off and unplug prior to performing any maintenance	
Weekly	Inspect the power cord. If the cord is damaged call technical support. Make sure the cord is positioned in a location where it will not be damaged.
Monthly	Clean the top surface of the pedals
	Clean the display console and all exterior surfaces with mild soap, water and a soft cotton cloth or a Life Fitness approved cleaner.
	<b>Note:</b> Do not use paper towels, ammonia or acid based cleaners on the product. At no time should cleaner be applied directly to any part of the equipment; spray the cleaner on a soft cloth and then wipe the unit.
	Inspect the exterior parts for wear and check that user assembly bolts are still tight.

**Note:** Long fingernails may damage or scratch the surface of the console. Use the pad of the finger to press the keys.

### LIFE FITNESS Approved Cleaners *(United States Availability Only)*

Two preferred cleaners have been approved by Life Fitness reliability experts: PureGreen 24 and Gym Wipes. Both cleaners will safely and effectively remove dirt, grime and sweat from equipment. PureGreen 24 and the Antibacterial Force formula of Gym Wipes are both disinfectants that are effective against MRSA and H1N1.

PureGreen 24 is available in a convenient spray. Apply the spray to a microfiber cloth and wipe down the equipment. Use PureGreen 24 on the equipment for at least 2 minutes for general disinfection purposes and at least 10 minutes for fungus and viral control.

Gym Wipes are large, durable pre-moistened wipes to use on the equipment before and after workouts. Use Gym Wipes on the equipment for at least 2 minutes for general disinfection purposes.

Contact Life Fitness Customer Support Services to order these cleaners. Call 1-800-351-3737 or email: [customersupport@lifefitness.com](mailto:customersupport@lifefitness.com).

### LIFE FITNESS Compatible Cleaners

Mild soap and water or a mild non-abrasive household cleaner can also be used to clean the display and all exterior surfaces. Use a soft microfiber cloth only. Apply the cleaner to the microfiber cloth before cleaning. DO NOT use ammonia or acid based cleaners. DO NOT use abrasive cleaners. DO NOT use paper towels. DO NOT apply cleaners directly to the equipment surfaces.

## 4.2 PREVENTIVE MAINTENANCE SCHEDULE

Item	Weekly	Monthly	Bi-Annually
Console Overlay	Clean		Inspect
Bottle Holders	Clean	Inspect	
Console Mounting Bolts			Inspect
Frame	Clean		Inspect
Plastic Covers	Clean	Inspect	
Lifepulse Sensors	Clean / Inspect		
Pedals	Clean	Inspect	

## 4.3 HOW TO OBTAIN PRODUCT SERVICE

1. Please contact your dealer or Life Fitness Customer Service at 1-800-351-3737.
2. Verify the symptom and review the operating instructions and troubleshooting matrix.
3. Locate and document the serial number of the unit. The serial number plate is located on the rear stabilizer. Please also have proof of purchase information available.

# 5 ASSEMBLY

## Component List and Hardware

Identify the following components after unpacking your E1 Total-Body Elliptical Cross-Trainer.

DESCRIPTION		QUANTITY
1	E1 BASE FRAME	1
2	FRONT STABILIZER	1
3	M10 X 16MM BLACK HEX HEAD BOLT	4
4	CONSOLE UPRIGHT	1
5	M10 X 70MM BLACK HEX HEAD BOLT	4 <i>(One bolt is preinstalled)</i>
6	M10 X 20MM CLEAR ZINC HEX HEAD BOLT	3
7	RIGHT ROCKER ARM	1
8	LARGE FLAT WASHER	2
9	WAVE WASHER	4
10	FLAT WASHER	2
11	PLASTIC END CAP	2
12	LEFT ROCKER ARM	1
13	M10 X 75MM BLACK HEX HEAD BOLT	2
14	M10 BLACK HEX NUT	2
15	BASE COVER	1
16	CONSOLE BRACKET	1
17	CONSOLE ( <b>TRACK+</b> or <b>GO</b> )	1
18	M5 X 12 BLACK PHILLIPS PAN HEAD TAPPING SCREW	4
<b>CONSOLE CABLES</b>		
19	POWER TO CONSOLE (15-PIN CONNECTOR)	1
20	HEART RATE (4-PIN CONNECTOR)	1
21	GROUND WIRE	1

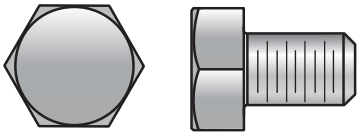

**M10 X 16MM BLACK HEX HEAD BOLT (#3)**

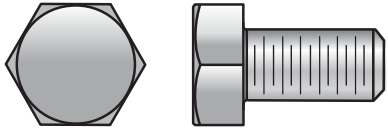

**M10 X 20MM CLEAR ZINC HEX HEAD BOLT (#6)**



**M10 X 70MM BLACK HEX HEAD BOLT (#5)**



**M10 X 75MM BLACK HEX HEAD BOLT (#13)**

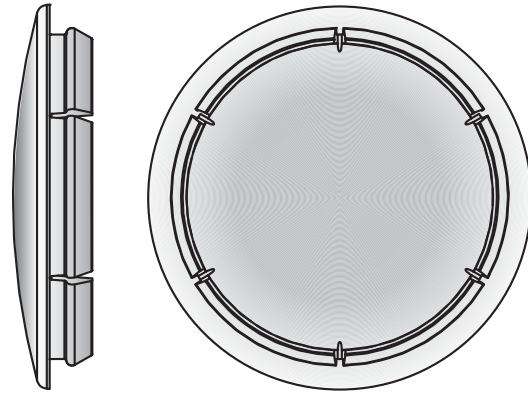

**PLASTIC END CAP (#11)**

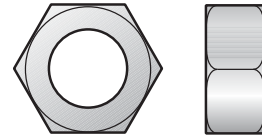

**M10 BLACK HEX NUT (#14)**



**M5 X 12MM BLACK PHILLIPS PAN HEAD TAPPING SCREW (#18)**

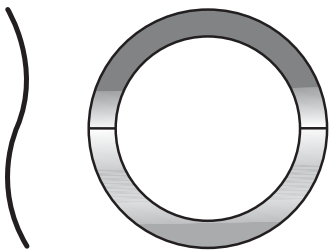

**WAVE WASHER (#9)**

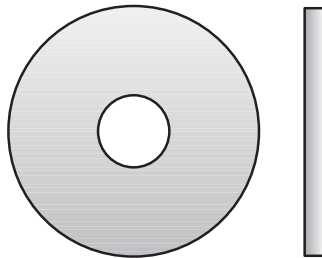

**FLAT WASHER 10MM ID (#10)**

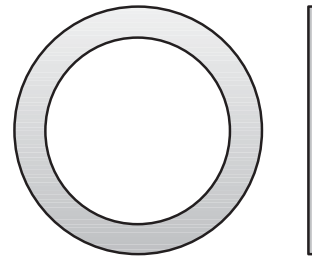

**LARGE FLAT WASHER (#8)**

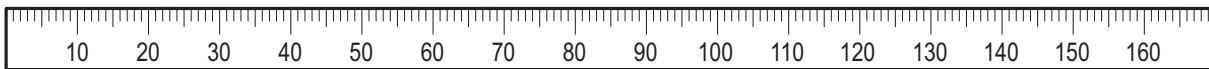

**Tools Required:**

- Phillips Head Screwdriver
- 17mm Socket Wrench
- 17mm Open End Wrench

1

40 ft. lbs.  
(54.23 Nm)

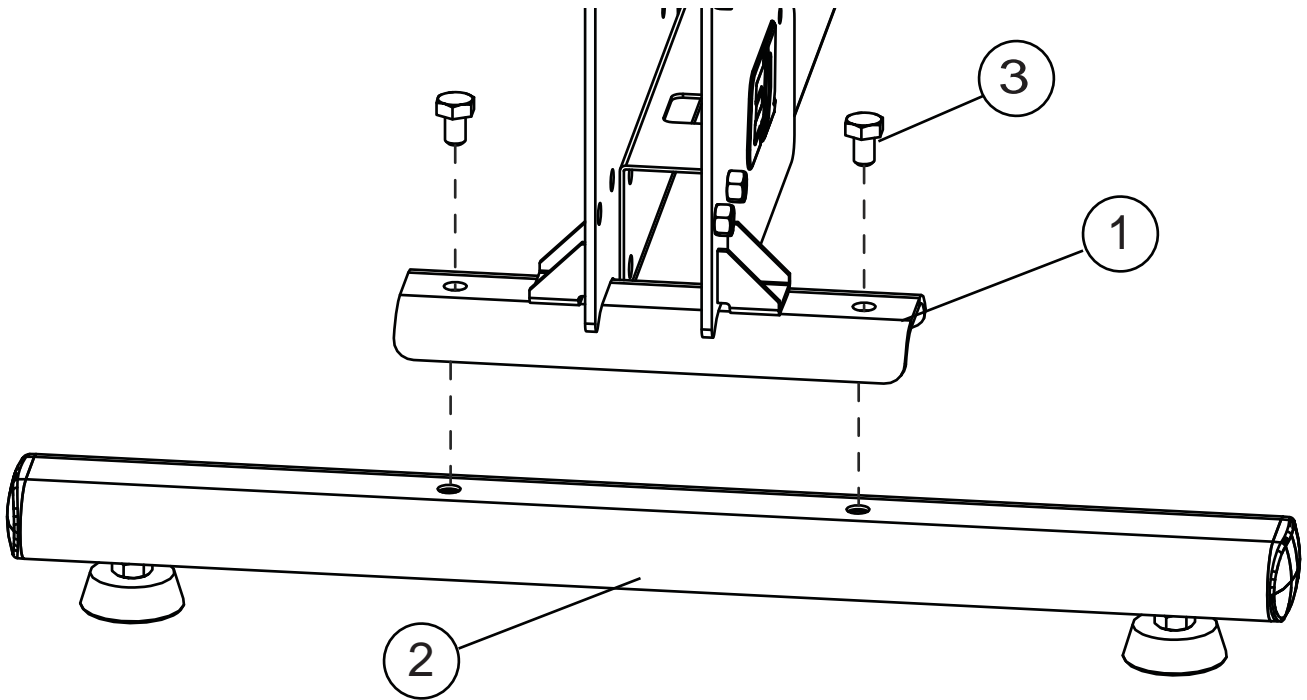

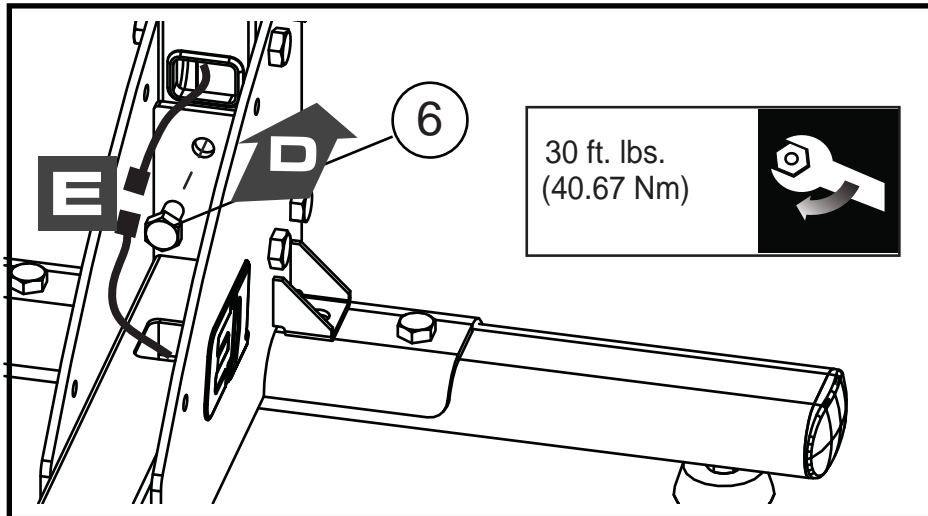
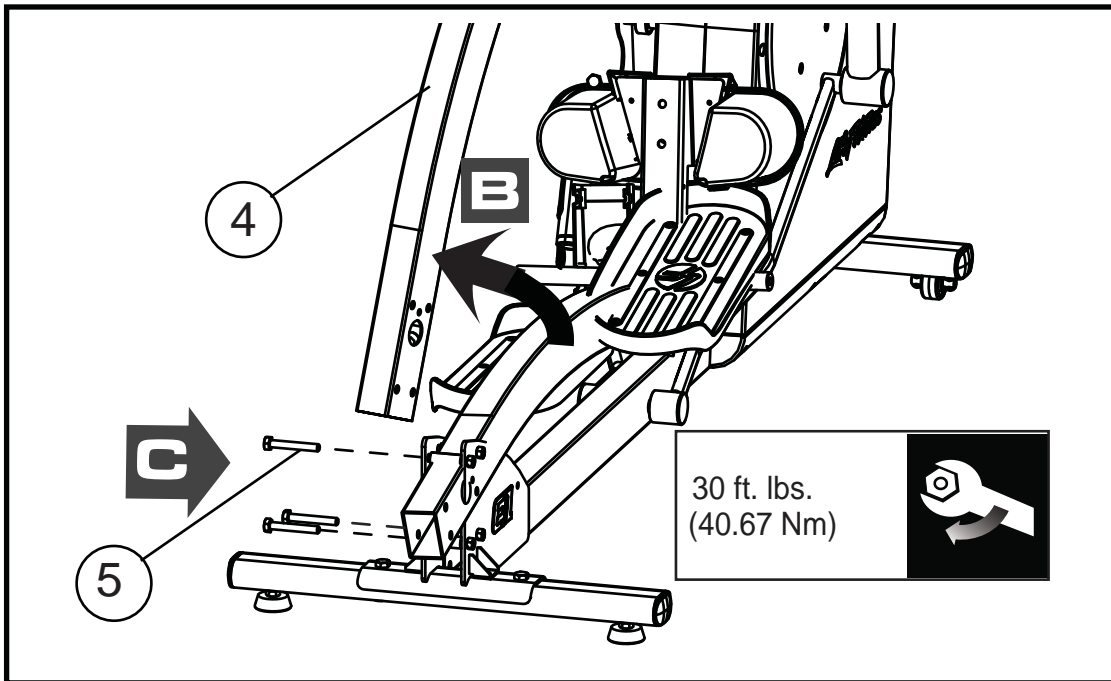
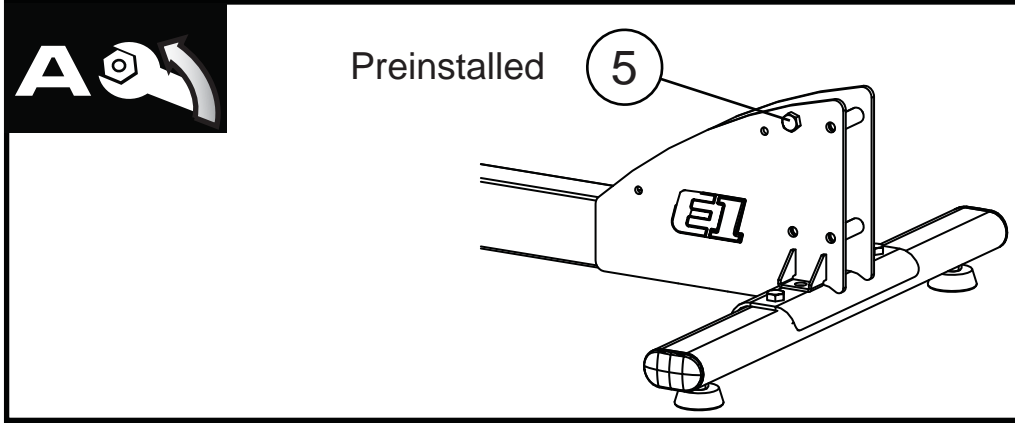

30 ft. lbs.  
(40.67 Nm)

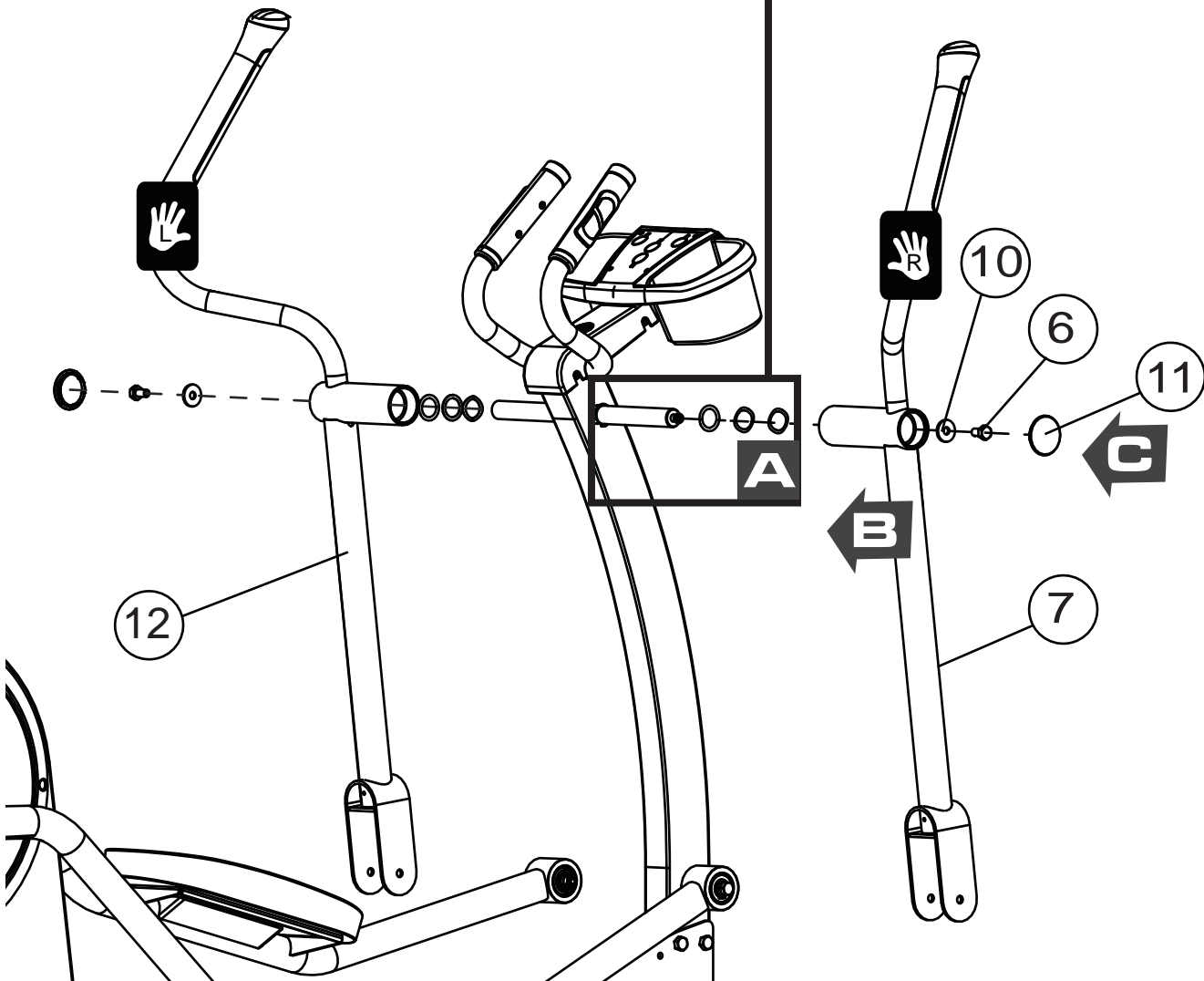
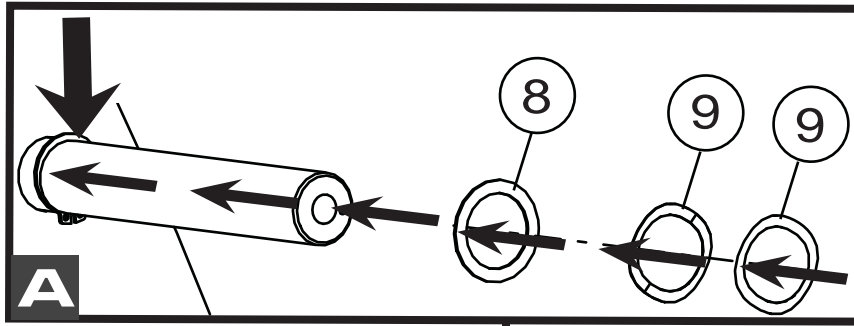

30 ft. lbs.  
(40.67 Nm)

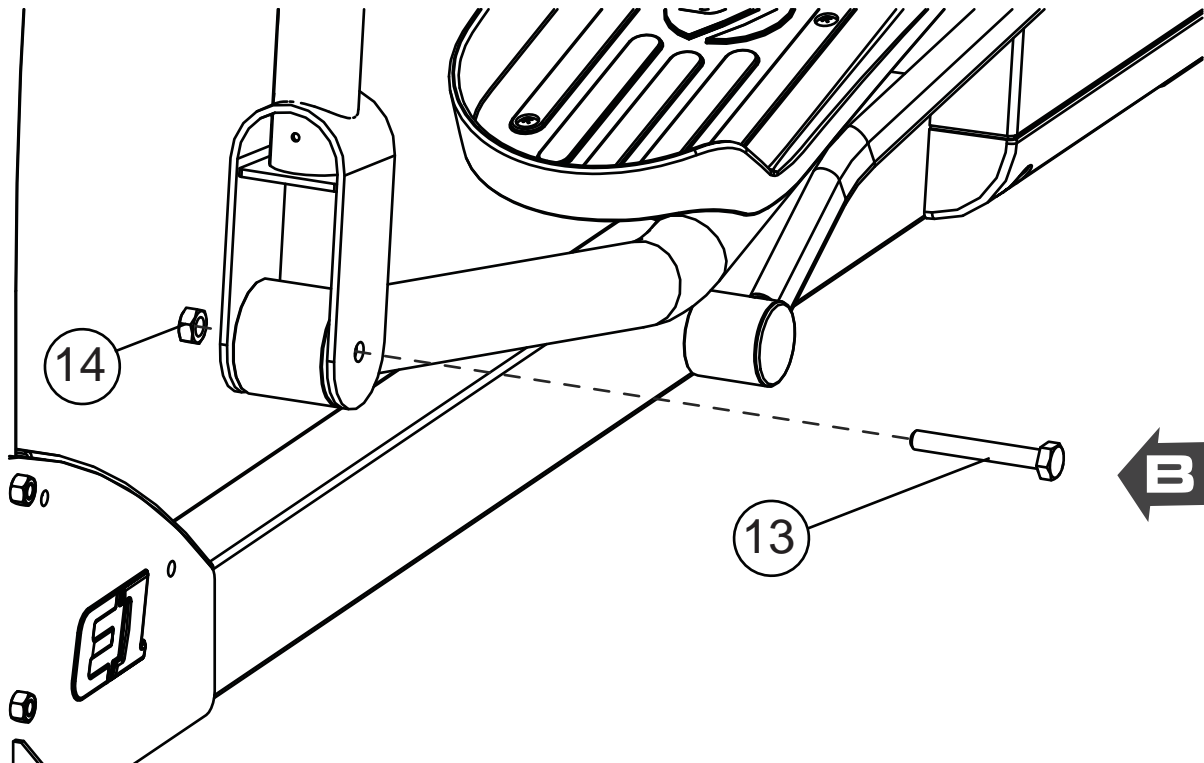
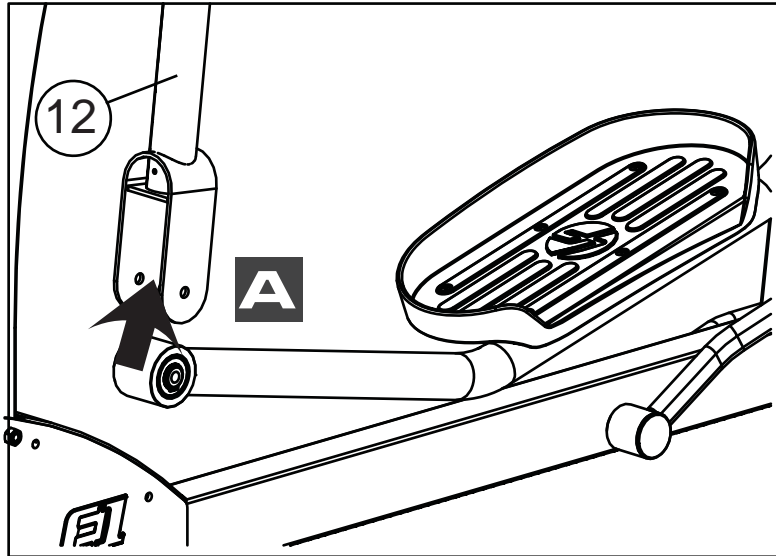

5

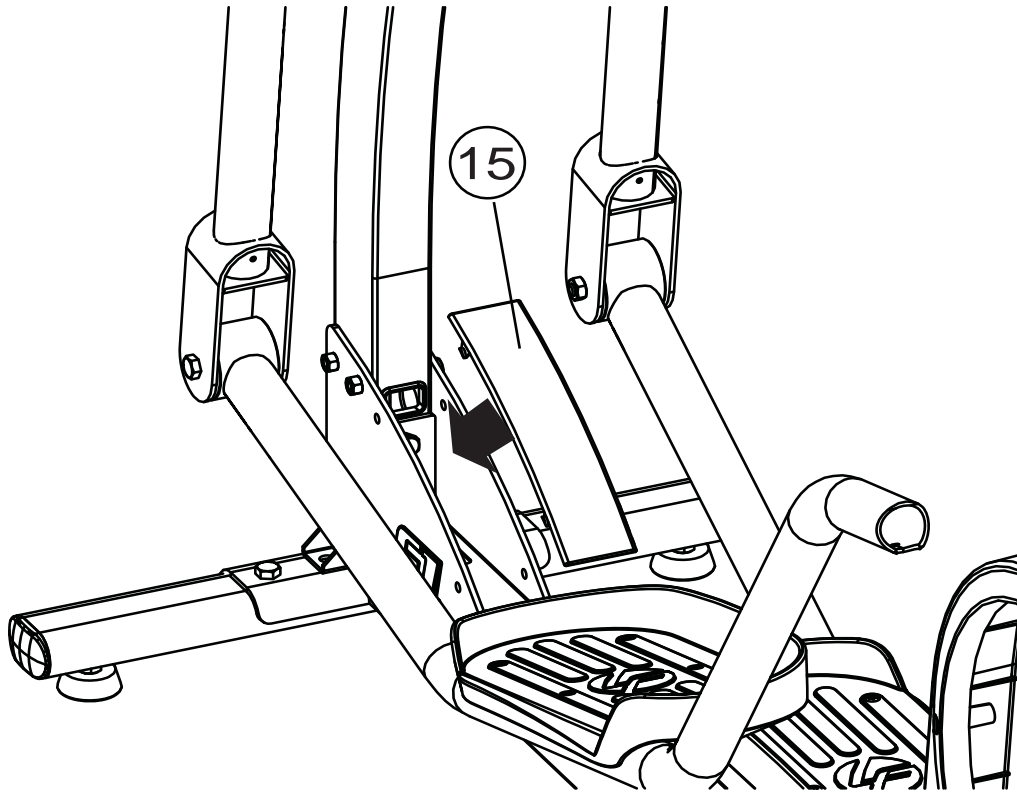

6

40 ft. lbs.  
(54.23 Nm)

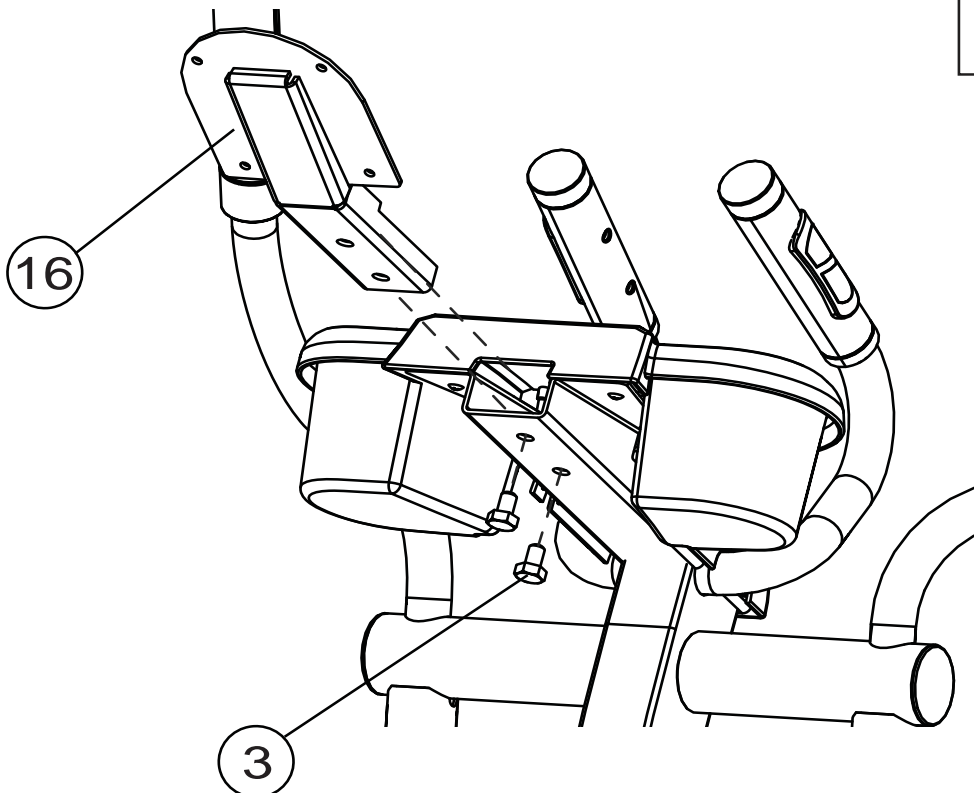

17.4 - 21.7 in. lbs.  
(2.0 - 2.5 Nm)

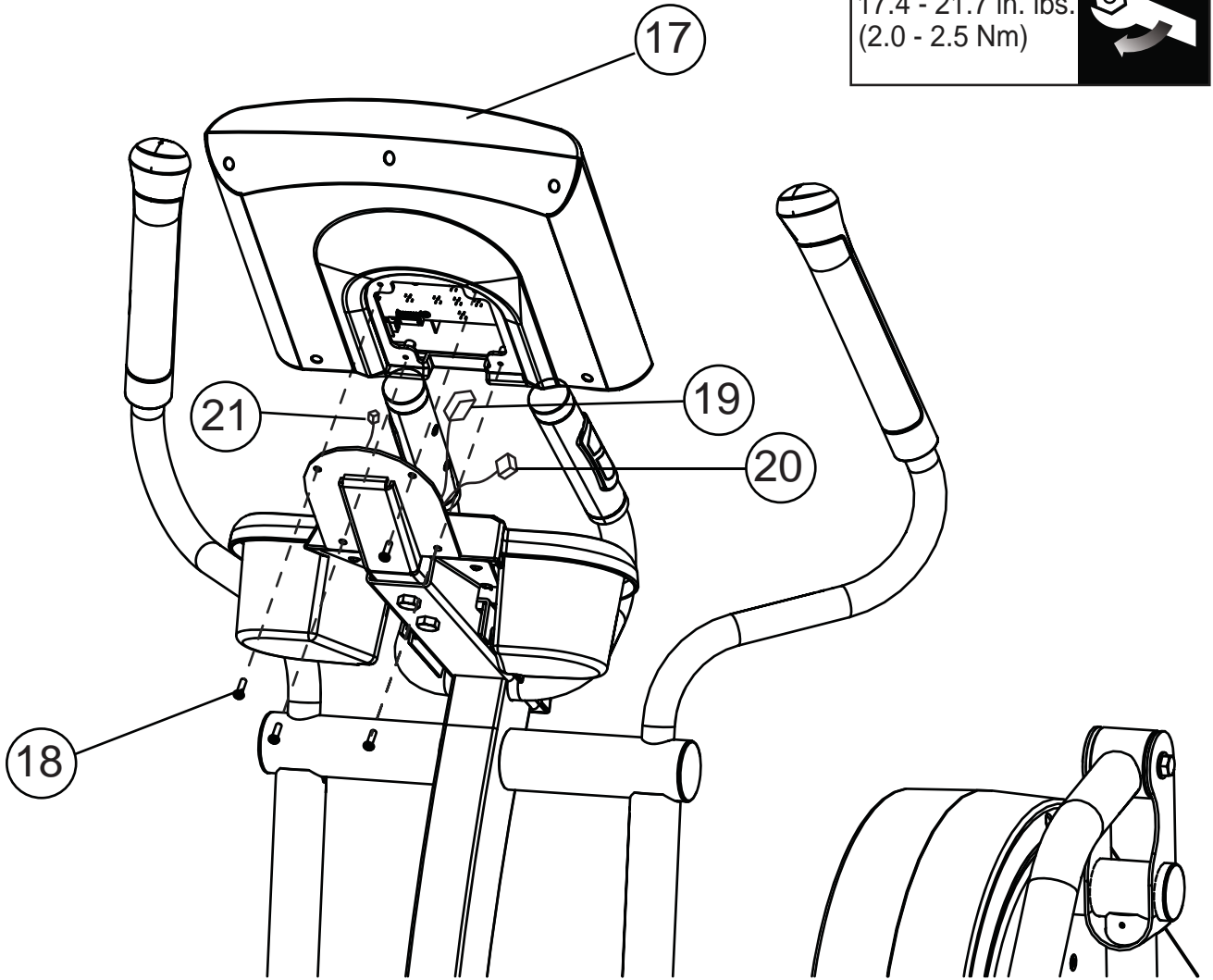

TRACK+ CONSOLE

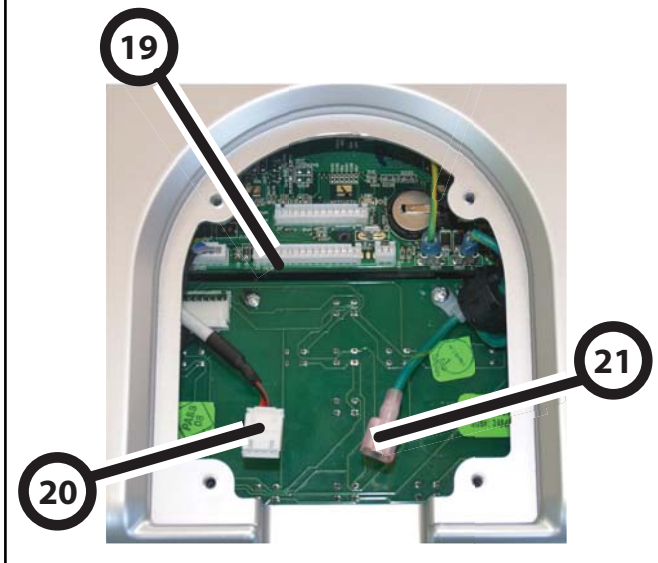

GO CONSOLE

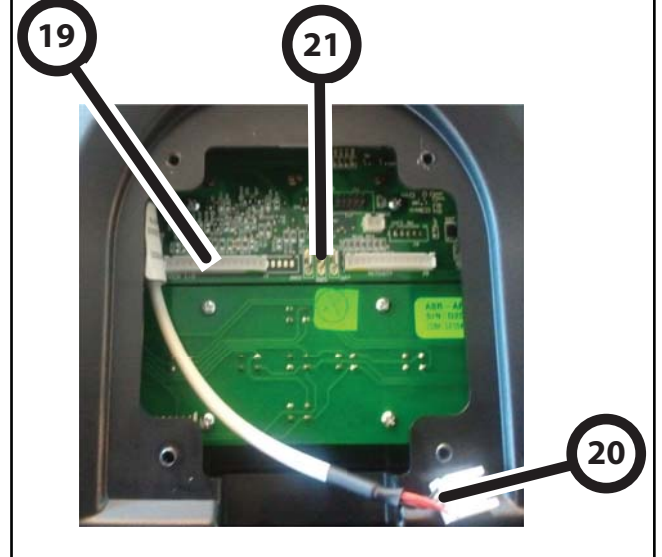

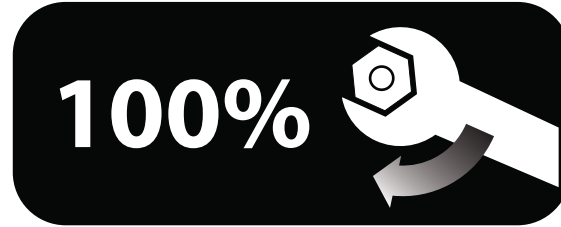

**MAKE SURE ALL HARDWARE IS TIGHT**

**Controleer of alle bevestigingen goed vast zitten**

**Vérifier que toute la visserie est serrée**

**Sicherstellen, dass alle Befestigungsteile festgezogen sind**

**Asegúrese de que todas las piezas estén firmes**

**УБЕДИТЕСЬ, ЧТО ВСЕ КРЕПЕЖНЫЕ ИЗДЕЛИЯ ЗАТЯНУТЫ**

مالك حإب ؤتببشم تادعمل اعيمج نأ نم دكأت



# 6 SPECIFICATIONS

## 6.1 LIFE FITNESS E1 TOTAL-BODY ELLIPTICAL CROSS-TRAINER

<b>Designed Use</b>	Home
<b>Max User Weight</b>	400 lbs. / 181 kg
<b>Resistance System</b>	Eddy Current
<b>Stride Length</b>	20 in. (51 cm) (Fixed Stride)
<b>User Controls</b>	None
<b>Contact Heart Rate</b>	On bull horns only
<b>Accessories</b>	2 water bottle holders & 1 accessory tray
<b>Power Supply</b>	120 Volt (U.S.), 220 Volt (Europe), 240+ Volt (Australia)

<b>Assembled Dimensions</b>		<b>E1</b>
Length		81.7 in. / 214 cm
Width		30 in. / 76.2 cm
Height		58.9 in. / 150 cm
Weight		211 lbs. / 96 kg
<b>Shipped Dimensions</b>		
Length		81 in. / 207 cm
Width		20 in. / 51 cm
Height		32 in. / 81 cm
Weight		242 lbs. / 110 kg

Operation Manuals and other Product Information available at  
<https://www.lftechsupport.com/web/document-library/documents>