

# Life Fitness Row GX How To Resolve a Leaking Tank

Revision Date	Problem Code	Warranty		Pages	Author			
July 11th, 2022	MECRA		Parts	12	B. Garber			
			Labor					
		X	Normal Warranty					
Document No.	RW220711							
Subject	Life Fitness Row GX leaking tank							
Time Required:		15 min	X	30 min		45 min		1 hr+
Distributed To:		Internal		Dealer	X	ISO	X	Installer
Video bulletin link:	Not Available							
<i>Life Fitness proprietary and confidential information. For the use of the intended recipient only. The information and instructions in this bulletin are intended for use by skilled technicians. Warranty information is for reference only and is subject to change. Contact the local Life Fitness representative for more information.</i>								

## DESCRIPTION

Row GX water tanks may leak water if they have been damaged or are not installed correctly. To resolve this, first identify where the water is leaking.

**Note:** You may have to row a few times to stir the water in the tank to identify where it is leaking.

The leak will be originating from one of three locations. Once you have identified the location, follow the steps below to resolve the issue.

**Leaking from plug in back** Remove plug and inspect. If the gasket has been damaged, replace. If it is properly seated and no damage is visible, reinstall tighten the plug to ensure a seal

**Note:** Avoid over-tightening this plug, as it may damage the gasket and cause leaking.

**Leaking from damaged part:** Identify the part that is cracked, causing the link. Follow the instructions to replace the part.

**Leaking from main tank gasket:** If the tank is leaking around the edges with no visible damage to any parts, the main gasket may be damaged or not seated correctly. Follow instructions to access gasket. Examine gasket and re-seat if necessary. inspect gasket for any damage. if no damage is visible and gasket was improperly seated, you may attempt to reinstall properly. If damage is present or no issue was detected, replace the gasket.

## Kit contents, 1017223-0001 Service Kit: GX Tank Shell

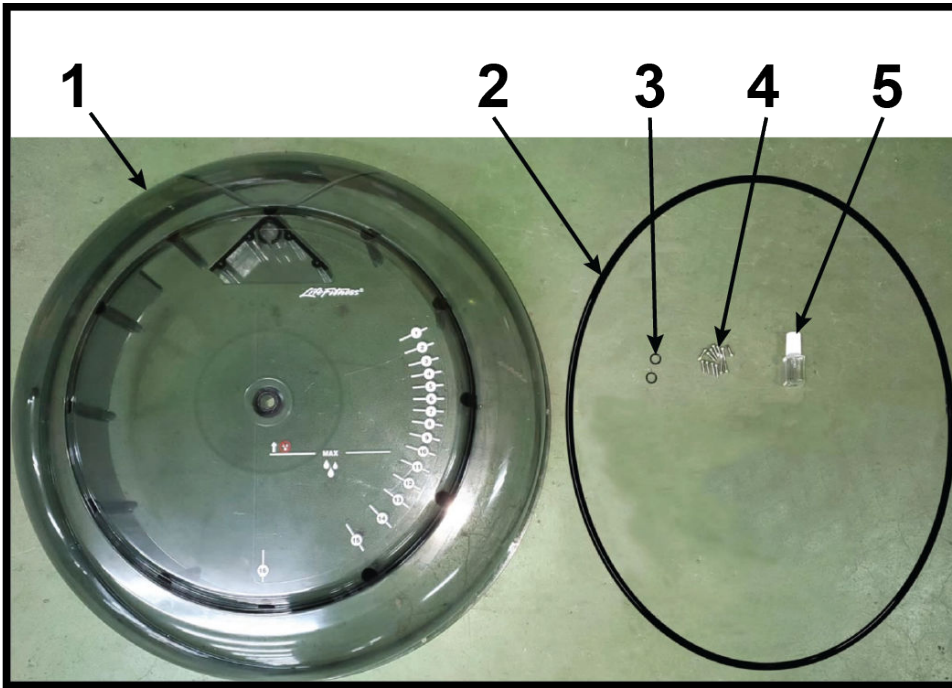

Item	Description	Qty.
1	TANK:COVER ASSY, BLACK, A403	1
2	SEAL: TANK, LARGE, 10046	1
3	RING: 12X9X1.5, O, NYLON, RESISTANCE ADJUSTER, 10032	2
4	SCREW: M3X20 SUS, TAPPING, COUNTER SUNK, 10036	12
5	SERVICE SILICONE O005320	1

### AFFECTED MODELS

GER-ALLX-101, GER-ALLX-102, and GER-ALLX-101PF

# Water Tank Cover Replacement - Upper

[Video Link](#)

## Tools Required:

- Siphon, included with rower
- Shallow pan, Large
- Drop cloth
- 4 mm Allen wrench
- 6 mm Allen wrench
- 17 mm Open end wrench
- Flat head screwdriver
- Phillips screwdriver
- Torque wrench
- Rubber mallet
- Clean cloth
- Silicone grease, clear, water safe. Example: RS Pro #494-124
- Small brush for silicone grease

## Parts Required:

- Upper tank cover
- Tank seal
- O-ring (2)
- Bolt, M3 x 12 (12)

## Time:

30 minutes

## Remove Water from Tank Procedure



**CAUTION:** Use a drop cloth under the tank when filling to avoid staining floor or carpet.

1. Remove water tank cap using a flat head screwdriver.

**Note:** Some water tank caps have wings on them and can be removed by hand.

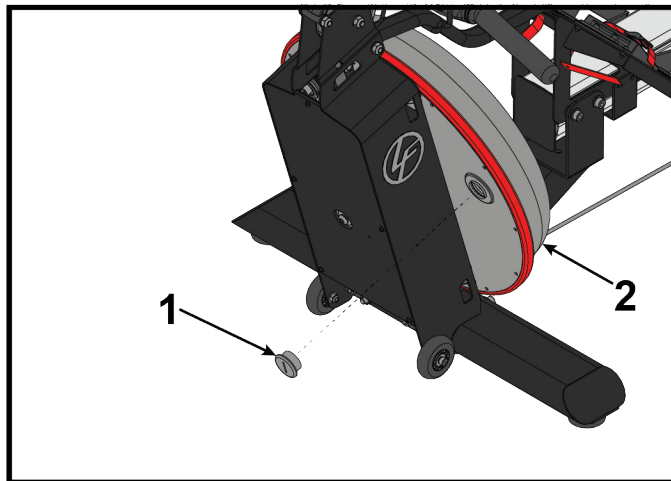

Item	Description	Qty
1	Water tank cap	1
2	Water tank	1

2. Place shallow pan under tank.
3. Lift rear leg of rower to pour water from tank into shallow pan. Remove as much water as possible.

## Remove Upper Water Tank Cover

1. Move the row handle from S-bend bar to a point where it is resting near upper pulley.

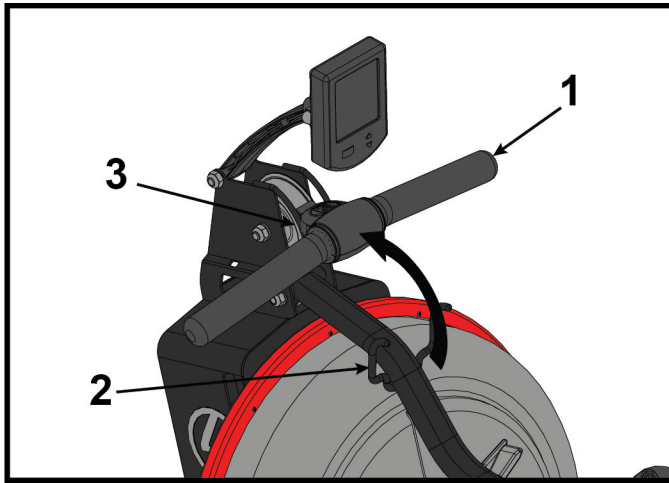

Item	Description	Qty
1	Handle	1
2	S-Bend handle	1
3	Upper pulley	1

2. Remove bolt and washer securing S-bend bar to footplate using a 6 mm Allen wrench.

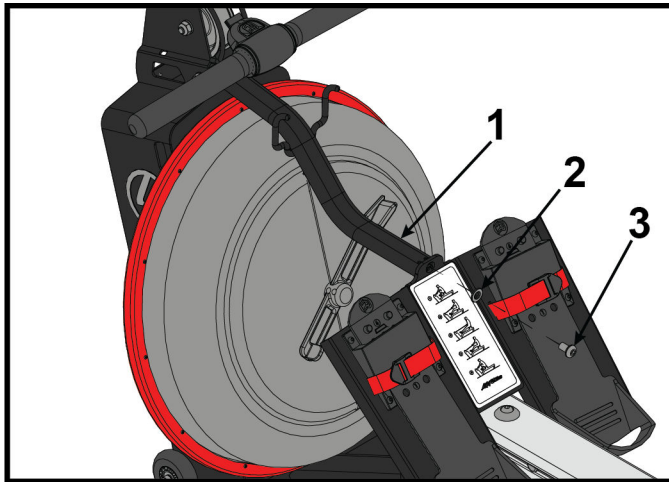

Item	Description	Qty
1	S-bend bar	1
2	Washer	1
3	Bolt	1

3. Loosen bolt and nut securing top of S-bend bar using a 6 mm Allen wrench and 17mm open end wrench.

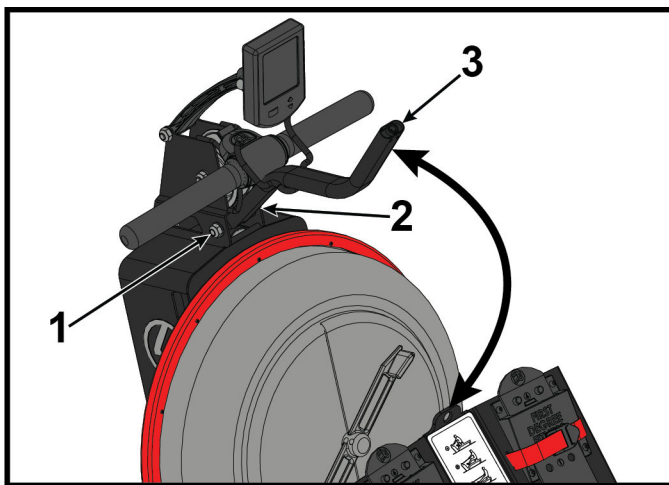

Item	Description	Qty
1	Nut	1
2	Bolt	1
3	S-bend bar	1

4. Pivot S-bend bar up and tighten bolt and nut to keep S-bend bar up and out of the way.

5. Remove red outer cover ring from tank by hand.

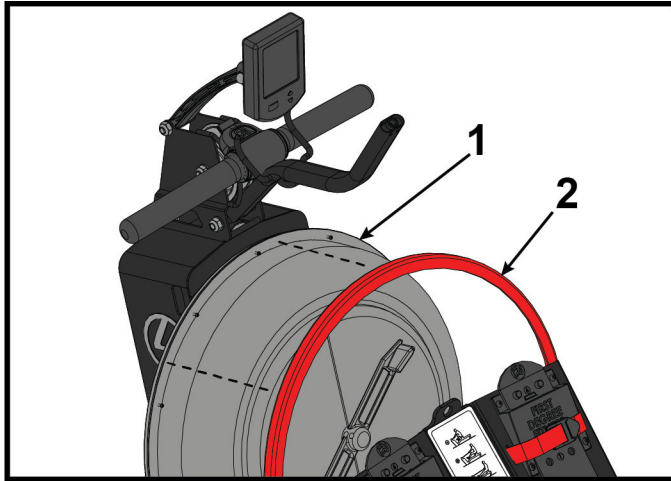

Item	Description	Qty
1	Tank	1
2	Red outer cover ring	1

6. Remove twelve water tank bolts using a Phillips screwdriver.

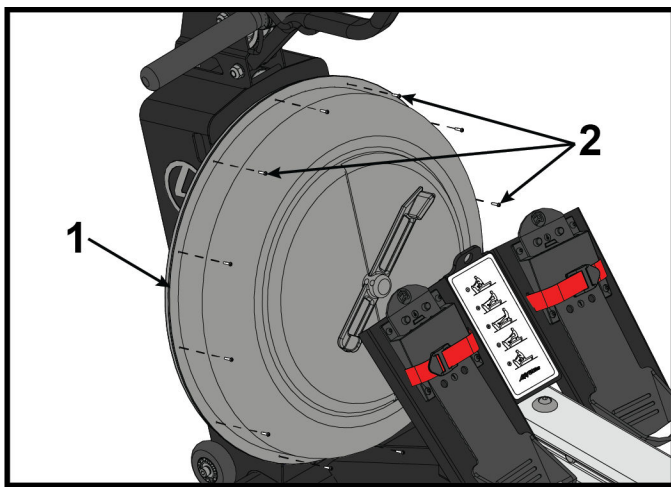

Item	Description	Qty
1	Tank	1
2	Bolts	12

7. Remove tank cover by prying off of tank back using a flat head screwdriver. Place on drop cloth to avoid scratches.



**Warning:** Pry tank cover off carefully, do not damage with flat head screwdriver.

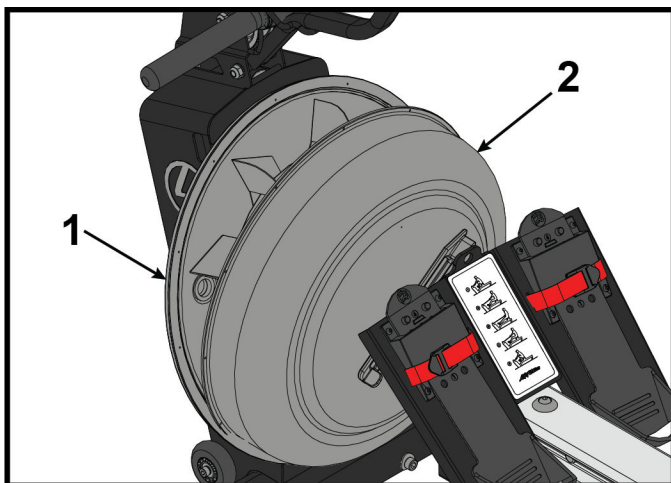

Item	Description	Qty
1	Tank back	1
2	Tank cover	1

8. Loosen set screws on adjustment handle using a 4 mm Allen wrench and remove adjustment handle from backing plate shaft.

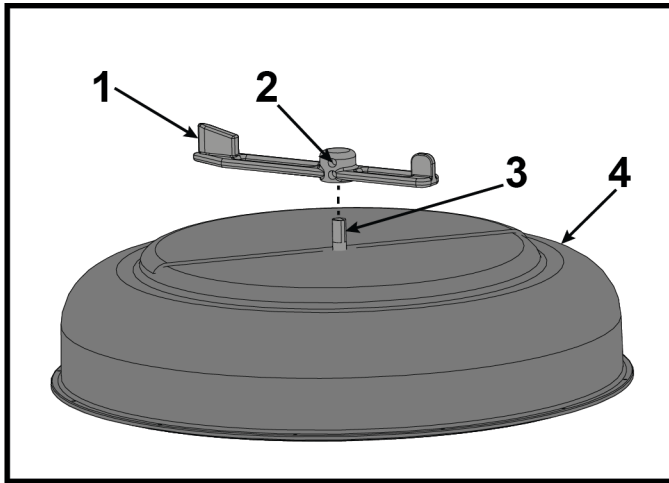

Item	Description	Qty
1	Adjustment handle	1
2	Set screw	2
3	Backing plate shaft	1
4	Tank cover	1

9. Remove twelve bolts securing tank ring to tank cover using a Phillips screwdriver.

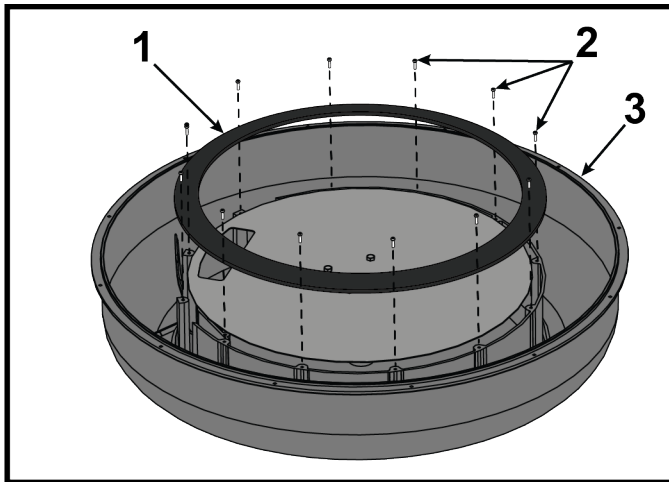

Item	Description	Qty
1	Tank ring	1
2	Bolt	12
3	Tank cover	1

10. Remove tank ring.

11. Stand water tank cover on side and remove backing plate by tapping shaft out with rubber mallet.

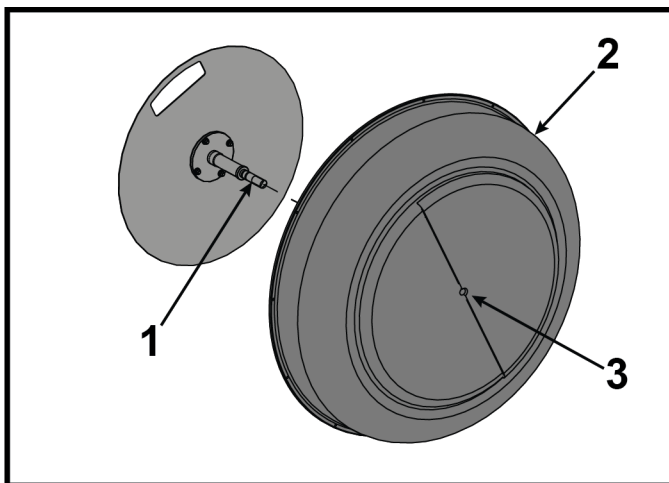

Item	Description	Qty
1	Backing plate shaft	1
2	Tank cover	1
3	Tap here with rubber mallet	1

12. Remove and discard both O-rings on backing plate shaft.

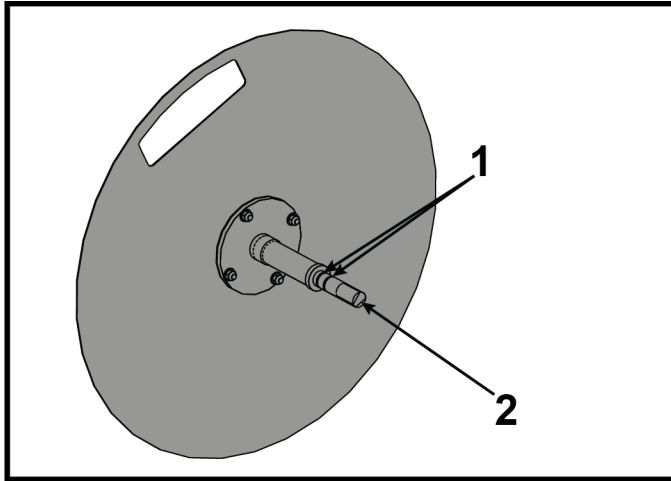

Item	Description	Qty
1	O-ring	2
2	Backing plate shaft	1

### Install Upper Water Tank Cover

1. Clean backing plate shaft with clean cloth.

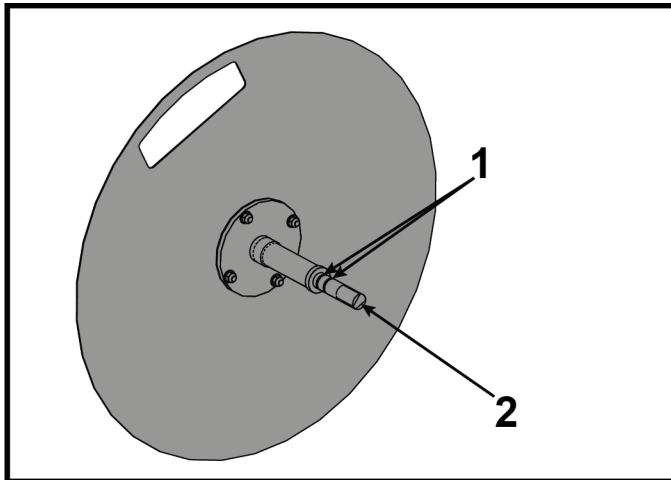

Item	Description	Qty
1	O-ring	2
2	Backing plate shaft	1

2. Install two O-rings on backing plate shaft.
3. Apply silicone to inside of tank mounting hole using silicone brush.
4. Install backing plate shaft into tank cover.

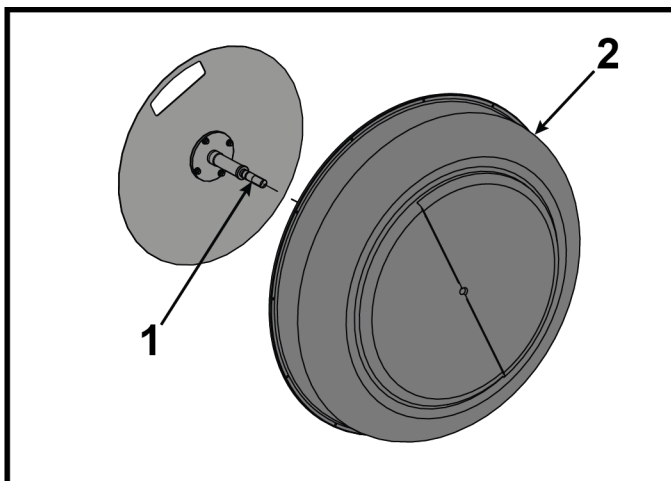

Item	Description	Qty
1	Backing plate shaft	1
2	Tank cover	1

5. Install twelve bolts securing tank ring using a Phillips screwdriver, but do not fully tighten.

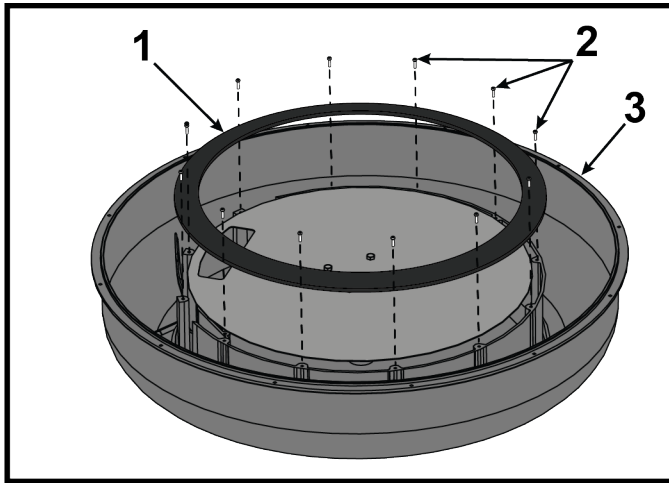

Item	Description	Qty
1	Tank ring	1
2	Bolt	12
3	Tank cover	1

6. Fully tighten bolts. Torque to 10 kgf / cm.

7. Remove and discard tank seal.

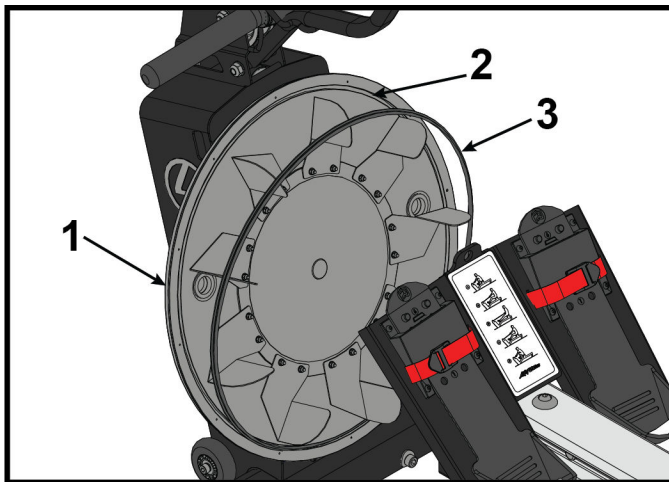

Item	Description	Qty
1	Tank back	1
2	Tank seal channel	1
3	Tank seal	1

8. Apply silicone to tank seal channel using small brush.

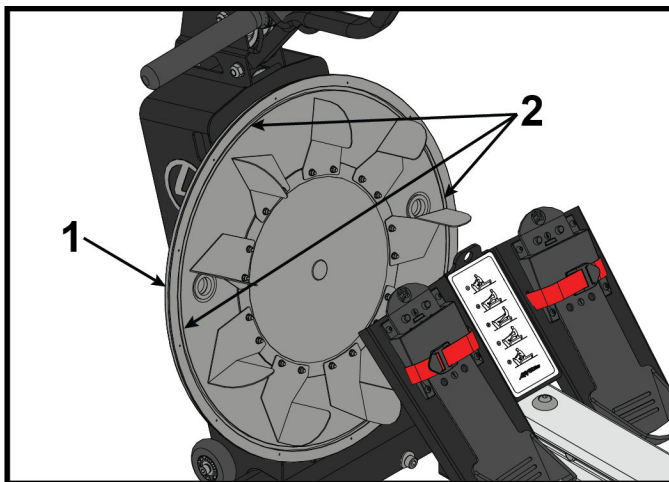

Item	Description	Qty
1	Tank back	1
2	Tank seal channel	1

9. Install tank seal into tank seal channel with flat side towards inside of tank.

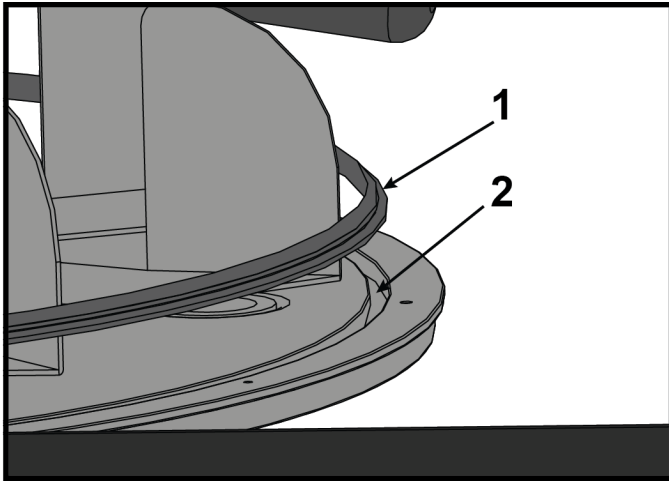

Item	Description	Qty
1	Tank seal	1
2	Tank seal channel	1

10. Apply more silicone to top of tank seal using small brush.

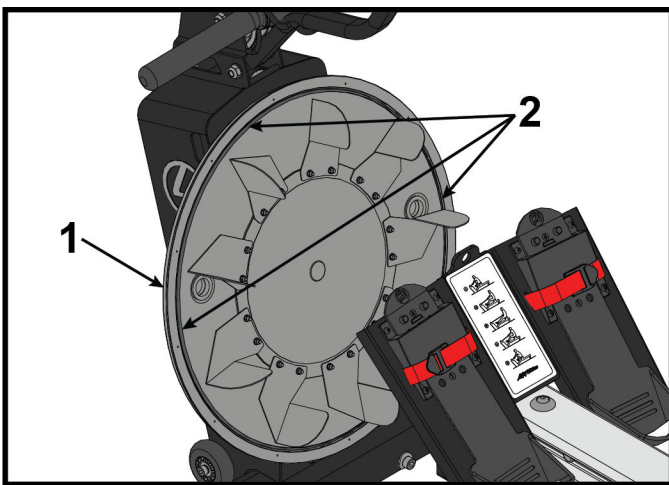

Item	Description	Qty
1	Tank back	1
2	Apply silicone here	1

11. Place one bolt into the top of the water tank cover and one into the bottom.

**Note:** Align water tank cover with logos and decals aligned horizontally.

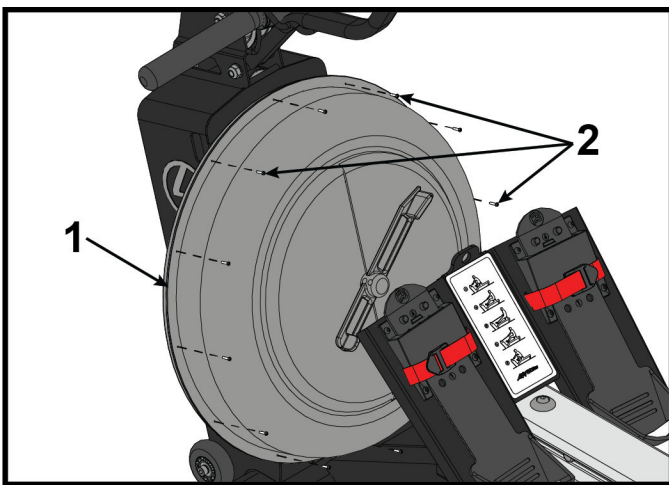

Item	Description	Qty
1	Tank	1
2	Bolts	12

12. Align both bolts and install water tank cover to base.

13. Partially tighten bolts using a Phillips screwdriver.

14. Install the ten other bolts and partially tighten bolts using a Phillips screwdriver.

15. Fully tighten all twelve bolts. Torque to 8 kgf / cm.

16. Install red outer cover ring by hand.

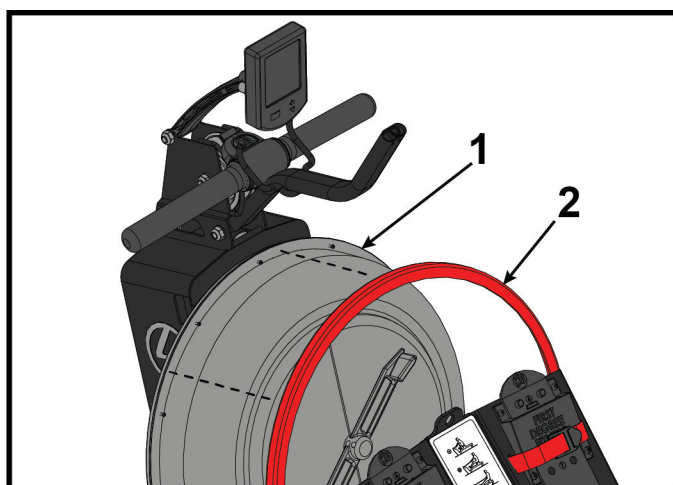

Item	Description	Qty
1	Tank	1
2	Red outer cover ring	1

17. Install set screws on adjustment handle and tighten using a 4 mm Allen wrench. Test rotation of adjustment handle for smooth operation.

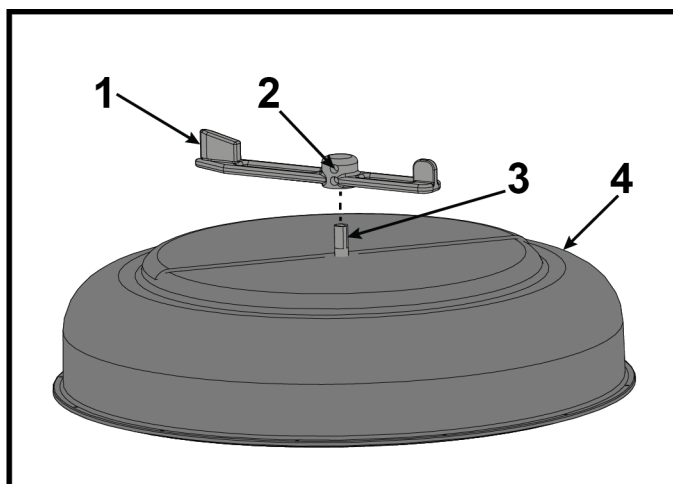

Item	Description	Qty
1	Adjustment handle	1
2	Set screw	2
3	Backing plate shaft	1
4	Tank cover	1

18. Loosen bolt and nut securing top of S-bend bar using a 6 mm Allen wrench and 17mm open end wrench.

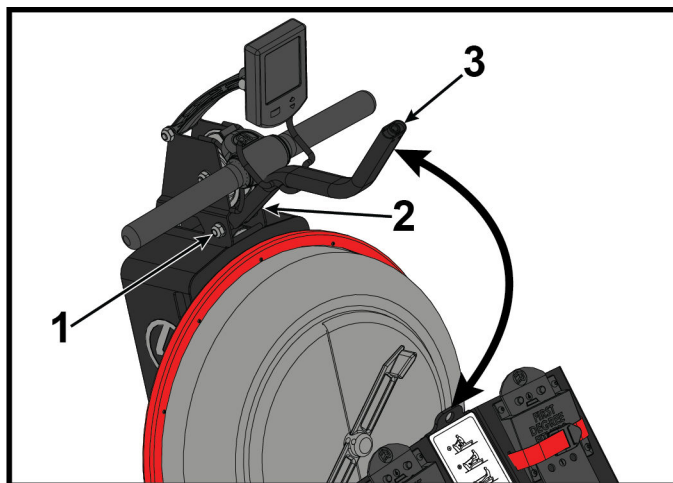

Item	Description	Qty
1	Nut	1
2	Bolt	1
3	S-bend bar	1

19. Install bolt and washer securing S-bend bar to footplate using a 6 mm Allen wrench. Torque to 180 kgf / cm.

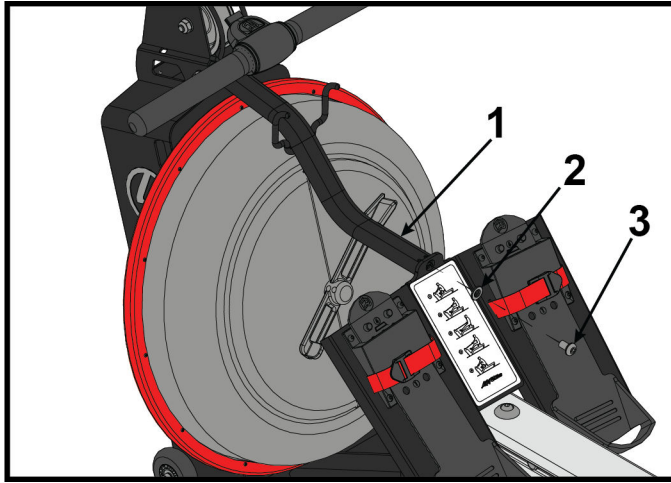

Item	Description	Qty
1	S-bend bar	1
2	Washer	1
3	Bolt	1

20. Tighten bolt and nut securing top of S-bend bar using a 6 mm Allen wrench and 17mm open end wrench. Torque to 180 kgf / cm.

### Tank Filling Procedure

**Note:** Where water quality is known to be poor, we recommend the use of distilled water.



**CAUTION:** Use a drop cloth under the tank when filling to avoid staining floor or carpet.

1. Turn adjuster handle to level 16.
2. Remove water tank cap from tank using a wide blade flat head screwdriver.

**Note:** Some water tank caps have wings on them and can be removed by hand.

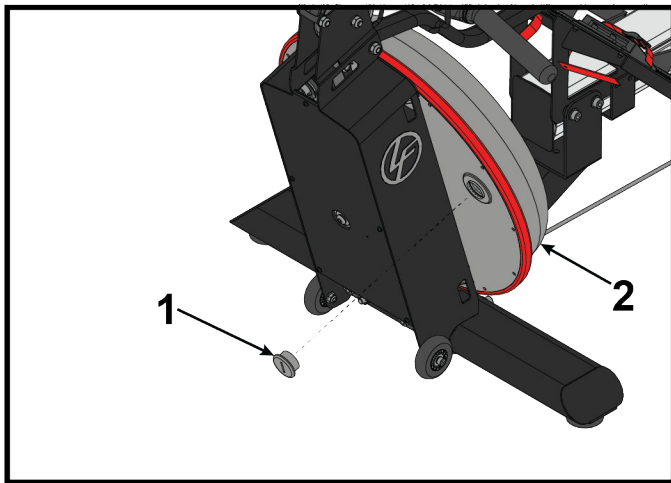

Item	Description	Qty.
1	Water tank cap	1
2	Tank	1



**Warning:** Do not insert fingers into tank!

**Note:** The lower tank plug is permanently sealed.

3. Place siphon into bucket and siphon hose into tank.

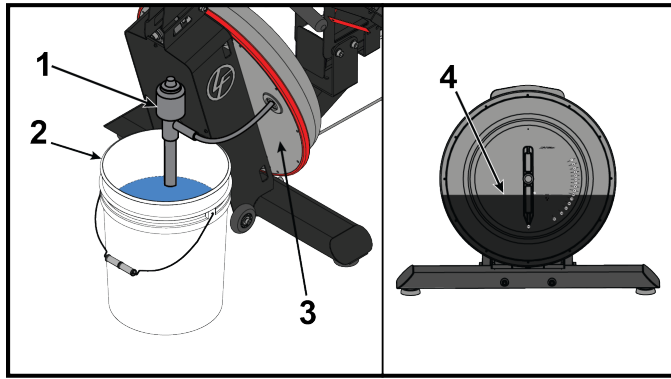

Item	Description	Qty.
1	Siphon	1
2	Bucket	1
3	Siphon hose in tank	1
4	Max fill line	1

4. Pump 2.0 Gallons (7.6 Liters) of water into tank.

**Note:** The siphon tube may be impeded by one of the impeller blades. Use the siphon only to push the impeller down slightly.

**Note:** The siphon valve must be closed to allow siphoning action to occur.

**Note:** Do not fill past max fill line on side of tank.

**Tip:** Placing the bucket in an elevated position will allow the siphon to continually pump water into the tank.

**Note:** Opening the siphon valve will stop the pumping action. Use this feature to avoid water spillage when nearing filling completion.

5. Once filling is complete (to the proper calibration level as indicated on the tank), follow water treatment schedule.

6. Install cap to tank using a wide blade flat head screwdriver.



**CAUTION:** Do not over tighten!

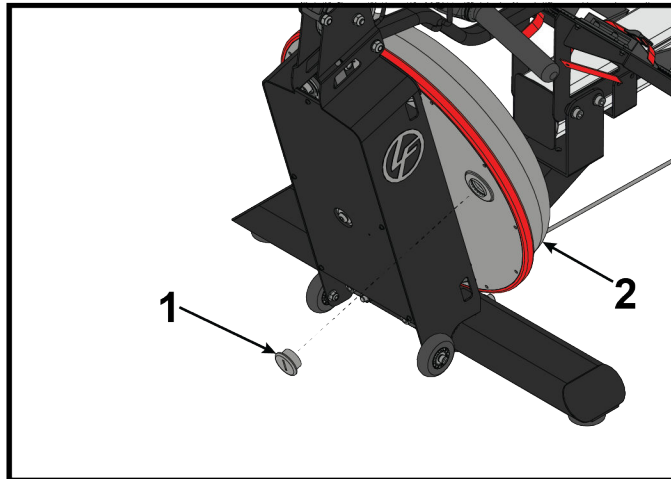

Item	Description	Qty.
1	Water tank cap	1
2	Tank	1

## Complete Installation

Operate unit at all levels to verify proper operation.