

Optima Plus Smith Rack

OP-SM

Owner's Manual



User and Service Documents Link

Operation Manuals and other Product Information available at
<https://www.lftechsupport.com/web/document-library/documents>

أدلة التشغيل ومعلومات أخرى عن الجهاز متاحة على الموقع <https://www.lftechsupport.com/web/document-library/documents>

操作マニュアルおよびその他の製品情報については、<https://www.lftechsupport.com/web/document-library/documents> をご覧ください。

如需操作手册和其他产品信息，请登录：<https://www.lftechsupport.com/web/document-library/documents>

操作手册和其他产品资讯请见 <https://www.lftechsupport.com/web/document-library/documents>

작동 설명서 및 기타 제품 정보는 <https://www.lftechsupport.com/web/document-library/documents> 에서 찾을 수 있습니다.

Trobareu el manual de funcionament i altra informació de producte a
<https://www.lftechsupport.com/web/document-library/documents>

Mae Llawlyfrau Gweithredu a Gwybodaeth Arall am Beiriannau ar gael yn
<https://www.lftechsupport.com/web/document-library/documents>

Die Betriebsanleitung und andere Produktinformationen erhalten Sie unter
<https://www.lftechsupport.com/web/document-library/documents>

Encontrará el manual de funcionamiento y otra información de producto en
<https://www.lftechsupport.com/web/document-library/documents>

Erabiltzailearen Eskuliburua eta Beste Produktuei buruzko Informazioa eskuratu
<https://www.lftechsupport.com/web/document-library/documents> gunean

Käyttöoppaat ja muut tuotetiedot ovat saatavana osoitteessa
<https://www.lftechsupport.com/web/document-library/documents>

Les manuels d'utilisation, ainsi que d'autres informations sur les Produits, sont disponibles sur
<https://www.lftechsupport.com/web/document-library/documents>

Felhasználói kézikönyvek és más termékinformációk: <https://www.lftechsupport.com/web/document-library/documents>

Manuali di funzionamento e altre informazioni sui prodotti disponibili su
<https://www.lftechsupport.com/web/document-library/documents>

Instrukcje obsługi i inne informacje o produktach dostępne na stronie
<https://www.lftechsupport.com/web/document-library/documents>

Manuais de Operação e Informações sobre outros produtos disponíveis em
<https://www.lftechsupport.com/web/document-library/documents>

Руководства по эксплуатации и другую касающуюся нашей продукции информацию можно найти, перейдя по ссылке
<https://www.lftechsupport.com/web/document-library/documents>

Kullanım Kılavuzları ve Diğer Ürün Bilgileri <https://www.lftechsupport.com/web/document-library/documents>'da bulunmaktadır

Corporate Headquarters

Columbia Centre III, 9525 West Bryn Mawr Avenue, Rosemont, Illinois 60018 • U.S.A.
847.288.3300 • FAX: 847.288.3703
Service phone number: 800.351.3737 (toll-free within U.S.A., Canada)
Global Website: www.lifefitness.com

International Offices

AMERICAS

North America

Life Fitness, Inc.

Columbia Centre III
9525 West Bryn Mawr Avenue
Rosemont, IL 60018 U.S.A.
Telephone: (847) 288 3300
Service Email: customersupport@lifefitness.com
Sales/Marketing Email: commercialsales@lifefitness.com

United Kingdom Life Fitness UK LTD

Queen Adelaide
Ely, Cambs, CB7 4UB
Telephone: General Office (+44) 1353.666017
Customer Support (+44) 1353.665507
Service Email: uk.support@lifefitness.com
Sales/Marketing Email: life@lifefitness.com

All Other EMEA Countries and Distributor Business EMEA*

Bijdorpplein 25-31
2992 LB Barendrecht
THE NETHERLANDS
Telephone: (+31) 180 646 644
Service Email: EMEAServiceSupport@lifefitness.com

Brazil

Life Fitness Brasil

Av. Rebouças, 2315
Pinheiros
São Paulo, SP 05401-300
BRAZIL
SAC: 0800 773 8282 option 2
Telephone: +55 (11) 3095 5200 option 2
Service Email: suportebr@lifefitness.com
Sales/Marketing Email: vendasbr@lifefitness.com

Germany, Austria, and Switzerland Life Fitness Europe GMBH

Neuhofweg 9
85716 Unterschleißheim
GERMANY
Telephone:
+49 (0) 89 / 31775166 Germany
+43 (0) 1 / 6157198 Austria
+41 (0) 848 / 000901 Switzerland
Service Email: kundendienst@lifefitness.com
Sales/Marketing Email: vertrieb@lifefitness.com

ASIA PACIFIC (AP)

Japan

Life Fitness Japan, Ltd

4-17-33 Minami Aoyama 1F/B1F
Minato-ku - Tokyo 107-0062
Japan
Telephone: (+81) 0120.114.482
Fax: (+81) 03-5770-5059
Service Email: service.lfj@lifefitness.com
Sales/Marketing Email: sales@lifefitnessjapan.com

Latin America and Caribbean* Life Fitness, Inc.

Columbia Centre III
9525 West Bryn Mawr Avenue
Rosemont, IL 60018 U.S.A.
Telephone: (847) 288 3300
Service Email: customersupport@lifefitness.com
Sales/Marketing Email: commercialsales@lifefitness.com

Spain Life Fitness IBERIA

C/Frederic Mompou 5, 1ª1ª
08960 Sant Just Desvern Barcelona
SPAIN
Telephone: (+34) 93.672.4660
Service Email: servicio.tecnico@lifefitness.com
Sales/Marketing Email: info.iberia@lifefitness.com

Hong Kong Life Fitness Asia Pacific LTD

32/F, Global Trade Square
21 Wong Chuk Hang Road
Hong Kong
Telephone: (+852) 2575.6262
Service Email: Service.HK@lifefitness.com
Sales/Marketing Email: hongkong.sales@lifefitness.com

EUROPE, MIDDLE EAST, and AFRICA (EMEA) Netherlands and Luxemburg

Life Fitness Atlantic BV

Bijdorpplein 25-31
2992 LB Barendrecht
THE NETHERLANDS
Telephone: (+31) 180 646 666
Service Email: service.benelux@lifefitness.com
Sales/Marketing Email: marketing.benelux@lifefitness.com

Belgium Life Fitness Benelux NV

Parc Industriel de Petit-Rechain
4800 Verviers
BELGIUM
Telephone: (+32) 87 300 942
Service Email: service.benelux@lifefitness.com
Sales/Marketing Email: marketing.benelux@lifefitness.com

All Other Asia Pacific countries and distributor business Asia Pacific*

32/F, Global Trade Square
21 Wong Chuk Hang Road
Hong Kong
Telephone: (+852) 2575.6262
Fax: (+852) 2575.6894
Service Email: Service.AP@lifefitness.com
Sales/Marketing Email: Marketing.HK.Asia@lifefitness.com

*Also check www.lifefitness.com for local representation or distributor/dealer

Table of Contents

User and Service Documents Link

Corporate Headquarters

Safety

Safety Information.....	6
Access Control.....	6
Installation.....	6
Proper Usage.....	6
Inspection.....	6
Operating Warnings.....	6
Plate Loaded, Free Weight, and Body Weight Systems.....	7
Warnings and Cautions.....	7
Product Labels.....	8
Label Locations.....	9

Assembly

Component and Hardware List.....	10
Tools Required.....	11
Assembly Procedure.....	11

Product Information

Specifications.....	18
---------------------	----

Maintenance Procedures

Maintenance Schedule.....	19
---------------------------	----

Warranty

What is Covered.....	21
Who is Covered.....	21
Who Pays Transportation and Insurance For Service.....	21
What We Will Do To Correct Covered Defects.....	21
What is Not Covered.....	21
Owner's Manual.....	21
Exclusive Warranty.....	21
Changes in Warranty Not Authorized.....	21
Effects of State Laws.....	21
Warranty Coverage.....	22

Bolt to Floor Guidelines

Introduction.....	23
Delivery and Installation Tips.....	23
Anchor Types.....	23
Anchor Specifications.....	24
Pullout Force.....	24
Tools Required.....	24
Static Anchor Procedure.....	24
Foot Dimensions.....	26

Life Fitness® is a registered trademark of Brunswick Corporation.

Gym Wipes® is a registered trademark of the 2XL Corporation. PureGreen 24 is a trademark of Pure Green.

© Copyright 2019, Life Fitness, a division of Brunswick Corporation. All Rights Reserved.

Columbia Center III - 9525 West Bryn Mawr Ave., Rosemont, IL 60018 • 847-288-3300

www.lifefitness.com • 1011903-0001 AA • 2019

1. Safety

Safety Information

It is the sole responsibility of the purchaser of LIFE FITNESS products to read the owner's manual and warning labels and instruct all individuals, whether they are the end user or supervising personnel, on proper usage of the equipment.

UNDERSTANDING EACH AND EVERY WARNING TO THE FULLEST IS IMPORTANT. IF ANY OF THESE WARNINGS ARE UNCLEAR, CONTACT LIFE FITNESS CUSTOMER SERVICE IMMEDIATELY AT 1-800-351-3737.

This equipment is categorized as class S per EN ISO 20957-1. As such this equipment is only intended for commercial, institutional and/or studio facilities. It is not intended for home use. Contact LIFE FITNESS with any questions regarding this classification.

It is recommended that all users of LIFE FITNESS exercise equipment be informed of the following information prior to use.

Access Control

LIFE FITNESS recommends that all commercial fitness equipment be used in a supervised area. It is recommended that the equipment be located in an access controlled area. Control is the responsibility of the facility owner.

Installation

SECURING EQUIPMENT - LIFE FITNESS recommends that all equipment be secured to a solid, level surface to stabilize it and eliminate rocking or tipping over. This must be performed by a licensed contractor. See [Bolt to Floor Guidelines](#) for installation procedure.

Proper Usage

- Do not use any equipment in any way other than designed or intended by the manufacturer. It is imperative that LIFE FITNESS equipment is used properly to avoid injury.
- Injuries may result if exercising improperly or excessively. It is recommended that all individuals consult a physician prior to commencing an exercise program. If at any time during exercise you feel faint, dizzy or experience pain, STOP EXERCISING and consult your physician.
- Keep body parts (hands, feet, hair, etc.), clothing and jewelry away from moving parts to avoid injury.
- When adjusting any seat, knee hold down pad, range of motion limiter, foothold pad, pulley or any other type of adjuster, make certain that the adjusting pin is fully engaged in the hole to avoid injury.

Inspection

- DO NOT use or permit use of any equipment that is damaged and/or has worn or broken parts. For all LIFE FITNESS equipment use only replacement parts supplied by LIFE FITNESS.
- Cables and belts pose an extreme liability if used when frayed. Always replace any cable at first sign of wear (consult LIFE FITNESS if uncertain).
- Routinely inspect all accessory clips that join attachments to the cables and replace them at the first sign of wear.
- MAINTAIN LABELS AND NAME PLATES - Do not remove labels for any reason. They contain important information. If unreadable or missing, contact LIFE FITNESS for a replacement.
- EQUIPMENT MAINTENANCE - Preventative maintenance is the key to smooth operating equipment as well as to keep your liability to a minimum. Equipment needs to be inspected at regular intervals.
- Ensure that any person(s) making adjustments or performing maintenance or repair of any kind is qualified to do so. LIFE FITNESS will provide service and maintenance training at our corporate facility upon request or in the field if proper arrangements are made.
- Before any use, examine all accessories approved for use with the LIFE FITNESS equipment for damage or wear.
- DO NOT ATTEMPT TO USE OR REPAIR ANY ACCESSORY APPROVED FOR USE WITH THE LIFE FITNESS EQUIPMENT WHICH APPEARS TO BE DAMAGED OR WORN.

Operating Warnings

 **WARNING:** This product can expose you to chemicals including Methyl Isobutyl Ketone, which is known to the State of California to cause cancer and birth defects or other reproductive harm. For more information go to <http://www.P65Warnings.ca.gov>

- It is the purchaser's sole responsibility to properly instruct its end users and supervising personnel as to the proper operating procedures of all equipment.
- Keep children away from strength equipment. Parents or others supervising children must provide close supervision of children if the equipment is used in the presence of children.
- Do not allow users to wear loose fitting clothing or jewelry while using equipment. It is also recommended to have users secure long hair back and up to avoid contact with moving parts.
- All bystanders must stay clear of all users, moving parts and attached accessories and components while machine is in operation.

Plate Loaded, Free Weight, and Body Weight Systems

- If the unit is equipped with weight rods, use only Olympic style weight plates (2.0" bore) for training weight. Do not use dumbbells or any means other than those stated to increase weight resistance - See machine specific section for more information.
- Always utilize weight plate retention devices such as clamps or pins.
- Only add weight plates up to the load limits of the unit. Make sure all weight plates are completely placed on the weight rod.
- Never exceed the load rating for any plate loaded station, body weight station, bench or other free weight device; including specific weight rod and band peg limits. See machine specific section for load limit information.
- Contact a LIFE FITNESS representative with any questions regarding proper weights and loading.

Warnings and Cautions

Warning labels indicate a potentially hazardous situation that could result in serious injury or death if the precautions are not observed.

Caution labels indicate a potentially hazardous situation that could result in serious injury or damage to machine if the precautions are not observed.

Contact [Customer Support Services](#) to replace any worn or damaged labels.

Product Labels

General Warning

WARNING

SERIOUS INJURY CAN OCCUR ON THIS EQUIPMENT. YOU MUST FOLLOW THESE PRECAUTIONS TO AVOID INJURY!

1. Before using, read all the warnings and obtain instruction on the use of this machine. Use only for intended exercise. **DO NOT** modify the machine.
2. Obtain a medical exam before beginning any exercise program.
3. Keep body, hair and clothing free of all moving objects.
4. Inspect machine and attachments before use. **DO NOT** use if the machine or attachments appear damaged. **DO NOT** attempt to fix broken or jammed machine or damaged attachments. Notify staff immediately.
5. Be certain that weight pin is completely inserted. Use only the pin provided by the manufacturer. If unsure, seek assistance.
6. Never pin the weights or prop plate into an elevated position. **DO NOT** use the machine if found in this condition. **DO NOT** attempt to fix. Seek assistance.
7. Inspect cables and their connections before using machine. **DO NOT** attempt to fix. Seek assistance.
8. Use only the incremental weights supplied by the manufacturer. **DO NOT** use dumbbells or other means to add resistance to the machine.
9. Children must not be allowed near this machine. Supervise teenagers.
10. Manufacturer recommends that all equipment be secured to the floor to stabilize and eliminate rocking or tipping over. Use a licensed contractor.
11. **DO NOT REMOVE THIS LABEL. REPLACE IF DAMAGED.**

Bar Rack Warning

WARNING

Bar will fall if hook is not fully engaged into slot.

Start Resistance:
45 lbs (20 kg)

Max Load Capacity:

Smith Bar:
5-45 lbs plates per side
(4-25 kg plates per side)

Olympic Bar:
8-45 lbs plates per side
(6-25 kg plates per side)

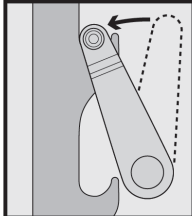

8699701

Bar Stop Warning

WARNING

Do not use without setting adjustable stop.

Proper Adjustments: Before using machine, adjust stops just below the desired range of motion for the exercise to be performed.

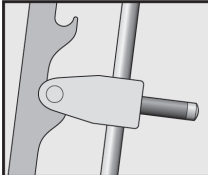

8699601

Serial Number

LifeFitness
9525 WEST BRYN MAWR AVE.
ROSEMONT, IL 60018
USA 1-800-351-3737
CAGE Code: 0CMY5

www.lifefitness.com Class: S Studio

Model: XXXXXX
Manufactured in USA with US and Foreign parts

Max. User Wt.
Max. Training Wt.
S/N: XXXXXXXX.....

XXXXXXXX.....



Pinch Hazard



Label Locations

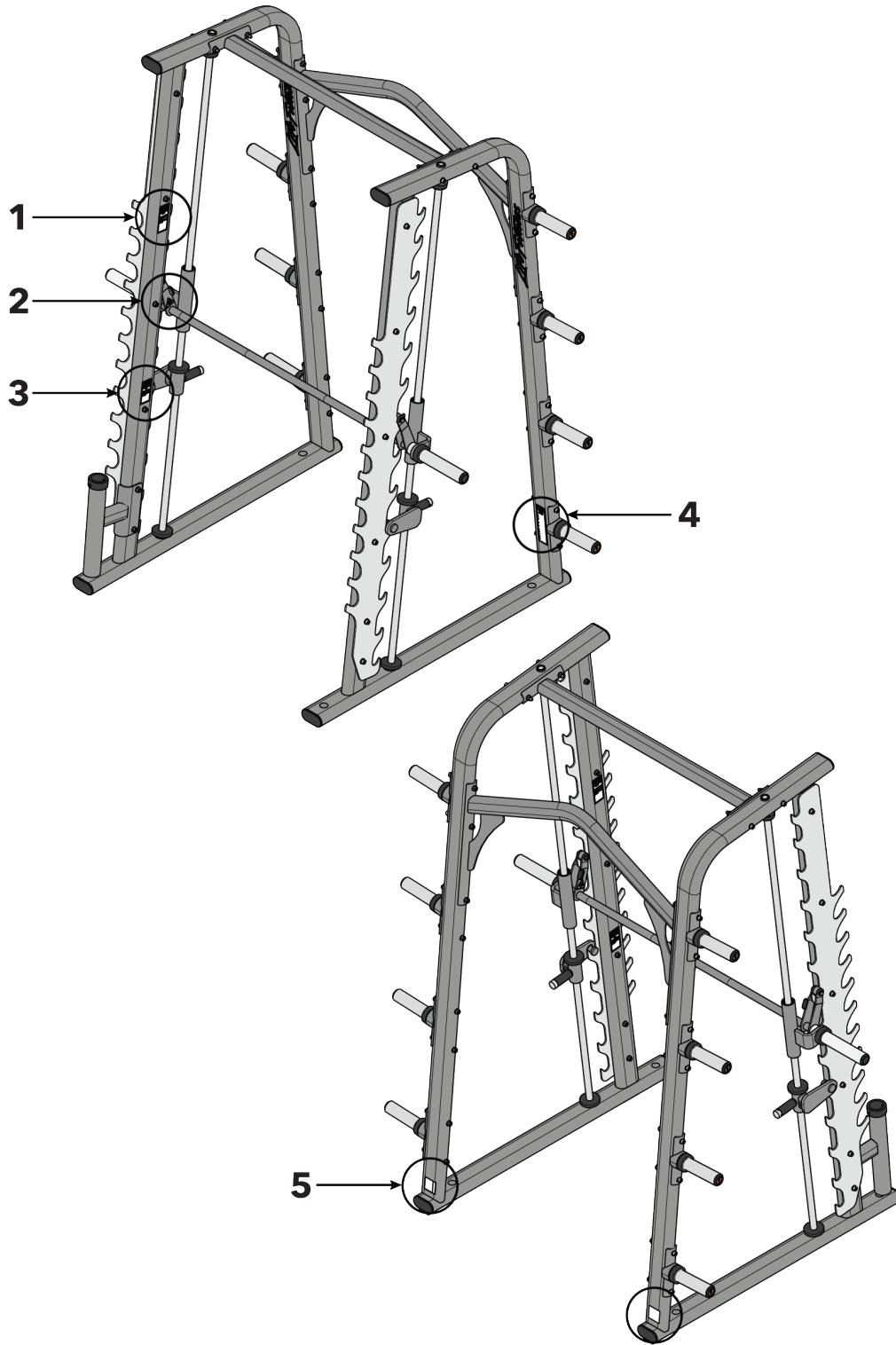

Item	Description	Qty.
1	Bar Rack Warning	2
2	Pinch Hazard	2
3	Bar Stop Warning	2
4	General Warning	1
5	Serial Number	2

2. Assembly

Component and Hardware List

Components

Item	Description	Qty.
1	Guide Rod	2
2	Top Cross Brace	1
3	Hook Plate	2
4	Right Carriage	1
5	User Bar	1
6	Adjustable Stop	2
7	Left Frame	1
8	Left Carriage	1
9	Right Frame	1
10	Weight Horn Assembly	8
11	Rear Cross Brace	1
12	Weight Horn Label Sheet	1
13	Bar Storage Assembly	1

Hardware

Item	Description	Qty.
1	Hardware Pack, OP-SM-HDWR	1
2	3/8" Flat Washer	64
3	M10 Hex Nylock Nut	32
4	M10 x 25mm Bolt	2
5	M10 x 70mm Bolt	10
6	M10 x 80mm Bolt	2
7	M10 x 120mm Bolt	10
8	M10 x 130mm Bolt	10
9	Shaft Collar	2
10	Carriage Bumper	4
11	Shaft Collar Bumper	2
12	Bar End Cap	2
13	Bar End Plate	2
14	Hole Plug	4

Hardware

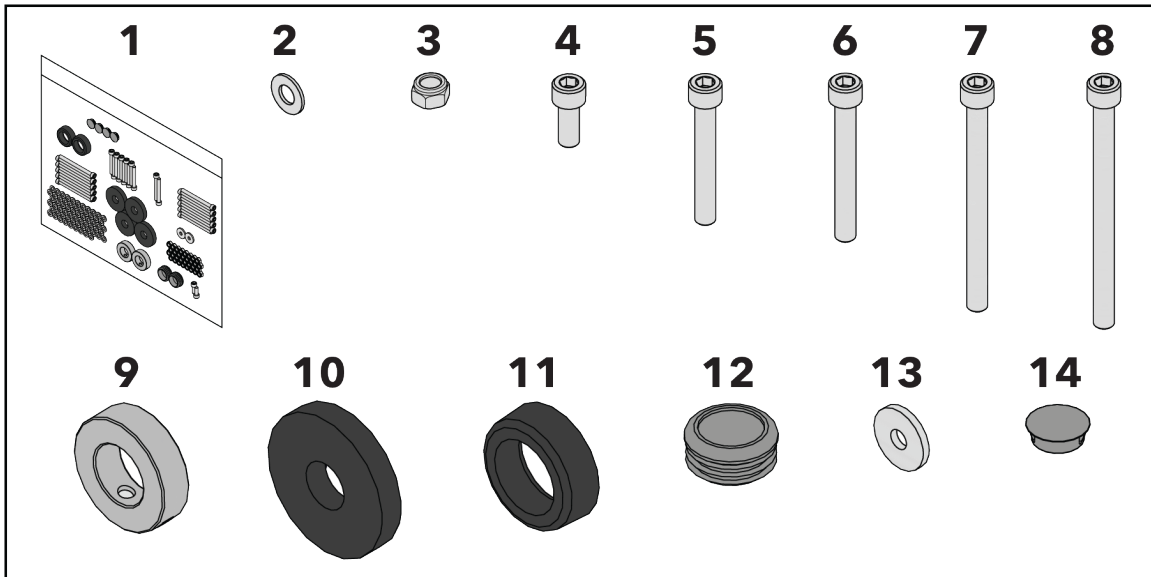

Tools Required

- 17 mm Socket wrench
- 17 mm Open end wrench
- 5 mm Allen wrench
- 7 mm Allen wrench
- 8 mm Allen wrench
- Torque wrench
- Rubber mallet

Assembly Procedure

Two people will be required for this procedure.

-  **TIP:** Read and understand all instructions thoroughly before assembling this unit. Check all items carefully. If there is damage, see the Customer Service section of this manual for proper procedure to return, replace, or reorder parts.

Install Guide Rods

1. Lay right frame down on the ground.
2. Install guide rod through guide rod hole at the top of the frame.

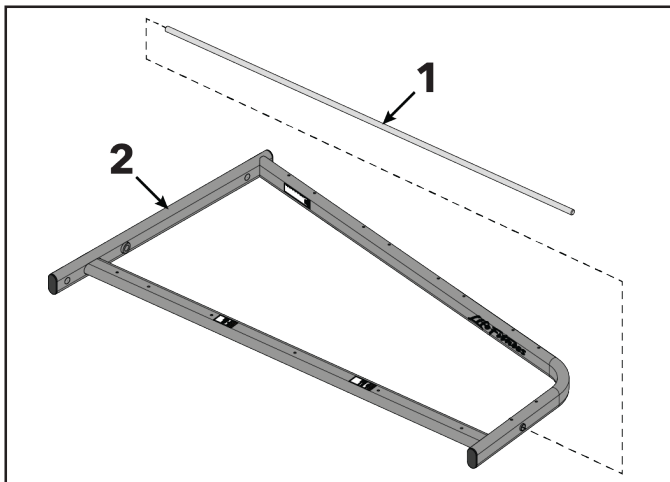

Item	Description	Qty.
1	Guide Rod	1
2	Right Frame	1

3. Repeat steps for left frame and guide rod.

Assemble Frames

1. Install bolts, washers, and hex nuts securing top cross brace to right frame using an 8mm Allen wrench and 17mm wrench.

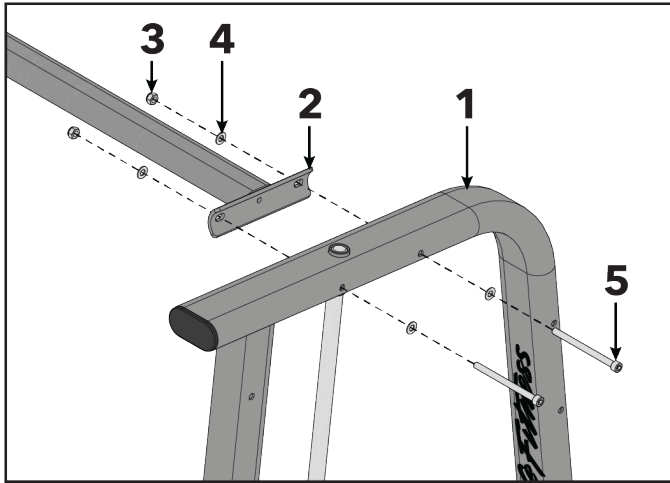

Item	Description	Qty.
1	Right Frame	1
2	Top Cross Brace	1
3	M10 Hex Nylock Nut	2
4	3/8" Flat Washer	4
5	M10 x 130mm Bolt	2



Hand tighten hardware.

- NOTE:** Make sure drain holes in top cross brace are facing the backs of the frames.

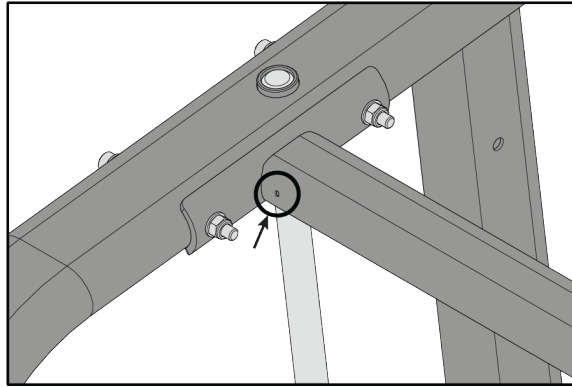

2. Install bolts, washers, and hex nuts securing rear cross brace and two weight horn assemblies to right frame using an 8mm Allen wrench and 17mm wrench.

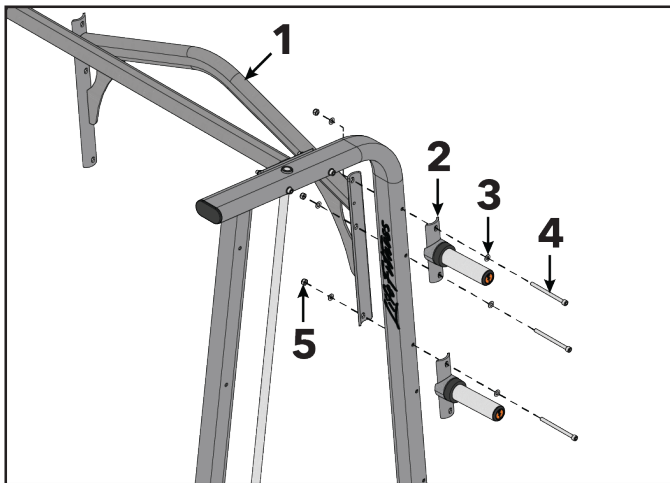

Item	Description	Qty.
1	Rear Cross Brace	1
2	Weight Horn Assembly	2
3	3/8" Flat Washer	6
4	M10 x 130mm Bolt	3
5	M10 Hex Nylock Nut	3



Hand tighten hardware.

3. Repeat steps 1 and 2 to install left frame.

- Install bolts, washers, and hex nuts securing weight horn assemblies to right frame using an 8mm Allen wrench and 17mm wrench.

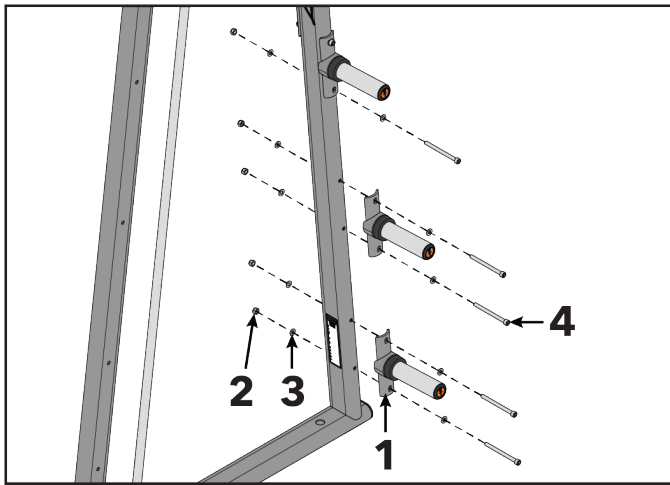

Item	Description	Qty.
1	Weight Horn Assembly	2
2	M10 Hex Nylock Nut	5
3	3/8" Flat Washer	10
4	M10 x 120mm Bolt	5



Hand tighten hardware.

NOTE: Make sure arrow sticker on weight horn is pointing UP when installing the weight horns.

- Repeat step 4 for left frame.
- Tighten all bolts to 20-25 ft-lb (27-33 Nm).

Install Hook Plates

- Install bolts, washers, and hex nuts securing hook plate to right frame using an 8mm Allen wrench and 17mm wrench.

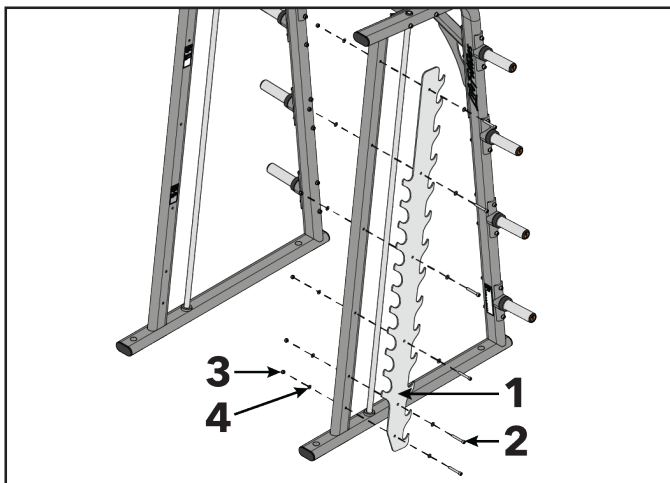

Item	Description	Qty.
1	Hook Plate	1
2	M10 x 70mm Bolt	6
3	M10 Hex Nylock Nut	6
4	3/8" Flat Washer	12



Tighten bolts to 20-25 ft-lb (27-33 Nm).

2. Install bolts, washers, and hex nuts securing hook plate to left frame using an 8mm Allen wrench and 17mm wrench.

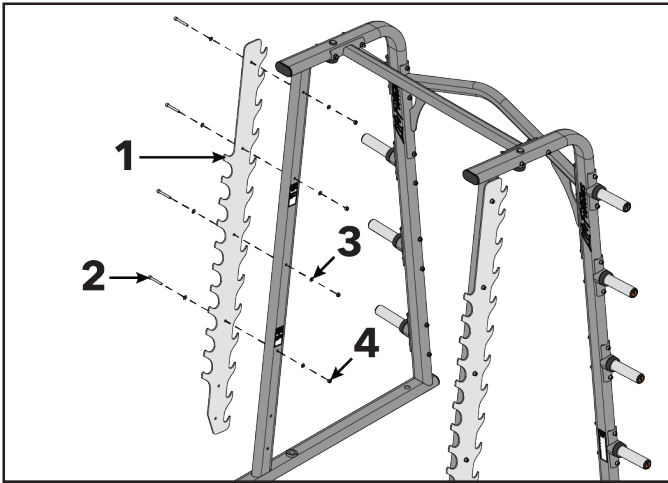

Item	Description	Qty.
1	Hook Plate	1
2	M10 x 70mm Bolt	4
3	3/8" Flat Washer	8
4	M10 Hex Nylock Nut	4



Tighten bolts to 20-25 ft-lb (27-33 Nm).

- NOTE:** Do not install bolts to the bottom two holes of the hook plate on the left side.

Install User Bar Assembly

1. Make sure rubber bumpers on the user bar are facing up, then slide left and right carriages onto the user bar.

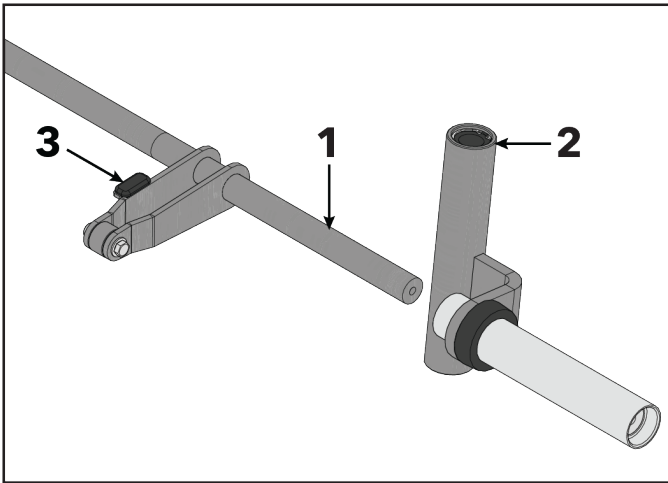

Item	Description	Qty.
1	User Bar	1
2	Left Carriage	1
3	Rubber Bumper	2

2. Install bolts securing bar end plates and carriages to user bar using an 8mm Allen wrench.

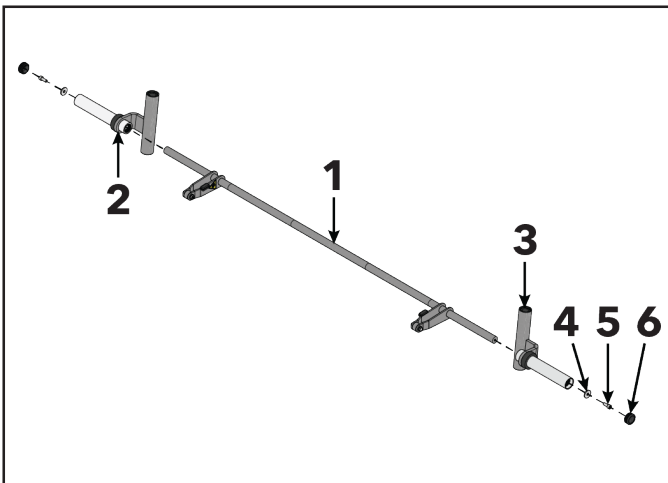

Item	Description	Qty.
1	User Bar	1
2	Right Carriage	1
3	Left Carriage	1
4	Bar End Plate	2
5	M10 x 25mm Bolt	2
6	Bar End Cap	2



Tighten bolts to 20-25 ft-lb (27-33 Nm).

3. Install bar end caps using a rubber mallet.

4. Lift guide rods up and out the tops of the frames.

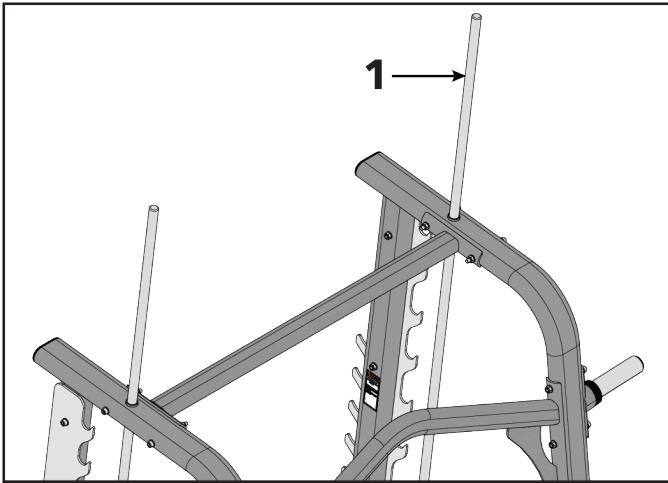

Item	Description	Qty.
1	Guide Rod	2

5. Install shaft collar, shaft collar bumper, user bar assembly, carriage bumpers, and adjustable stop to guide rods. Lower guide rods to the bottom of the frames.

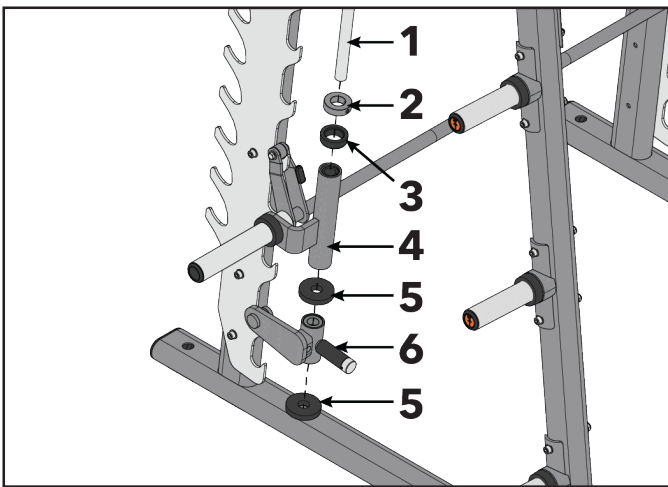

Item	Description	Qty.
1	Guide Rod	2
2	Shaft Collar	2
3	Shaft Collar Bumper	2
4	User Bar Assembly	1
5	Carriage Bumper	4
6	Adjustable Stop	2

6. Install shaft collar and shaft collar bumper to the tops of the left and right frames using a 5mm Allen wrench.

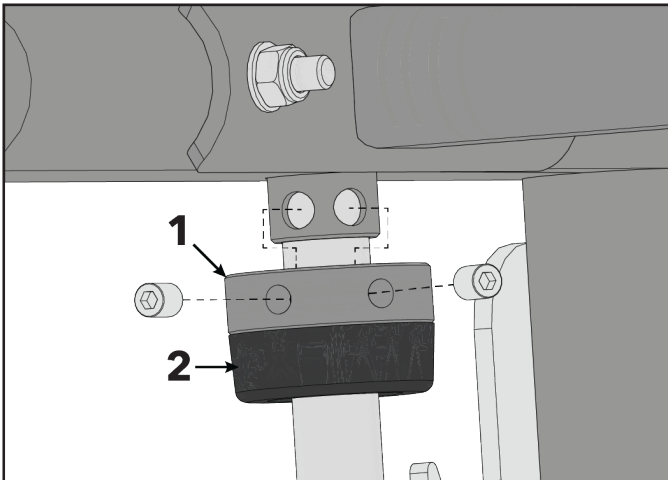

Item	Description	Qty.
1	Shaft Collar	2
2	Shaft Collar Bumper	2



Tighten set screws to 8-10 ft-lbs (11-13.5 Nm).

Install Hole Plugs

Install hole plugs to frames using a rubber mallet.

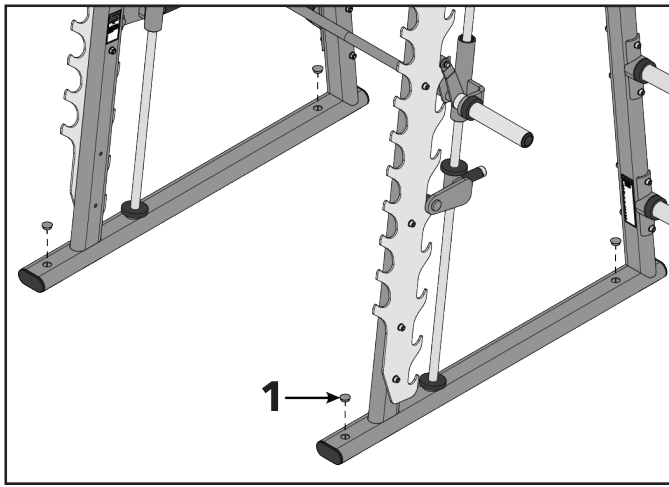

Item	Description	Qty.
1	Hole Plug	4

Install Bar Storage Assembly

Install bolts, washers, and hex nuts securing bar storage assembly to left frame using an 8mm Allen wrench and 17mm wrench.

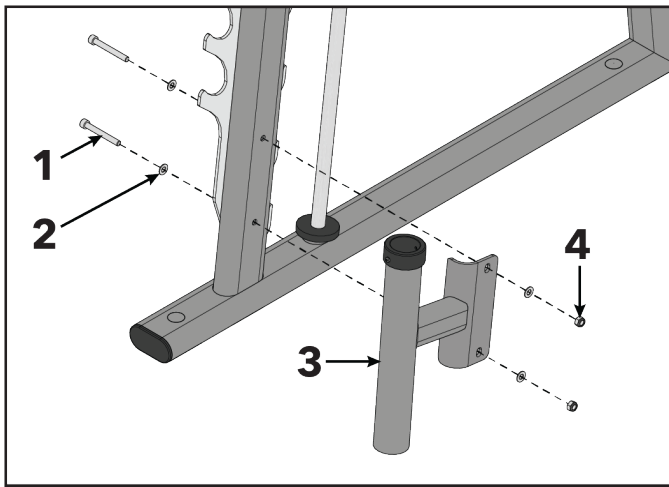

Item	Description	Qty.
1	M10 x 80mm Bolt	2
2	3/8" Flat Washer	4
3	Bar Storage Assembly	1
4	M10 Hex Nylock Nut	2



Tighten bolts to 20-25 ft-lb (27-33 Nm).

Install Weight Decals

Install weight decals to weight horns.

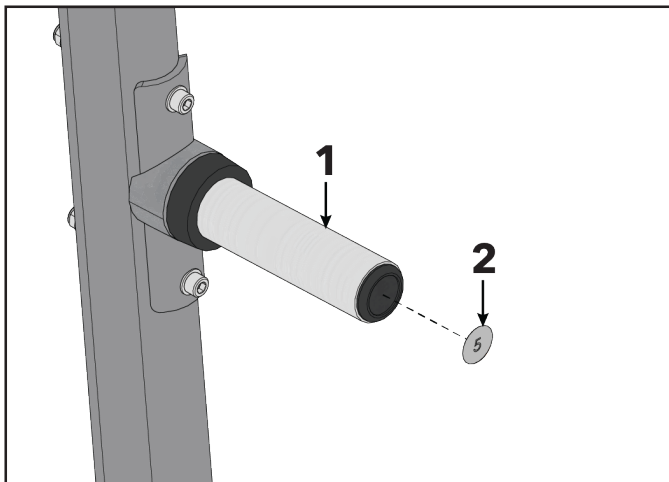

Item	Description	Qty.
1	Weight Horn	8
2	Weight Decal	8

 **NOTE:** Weight decal placement.

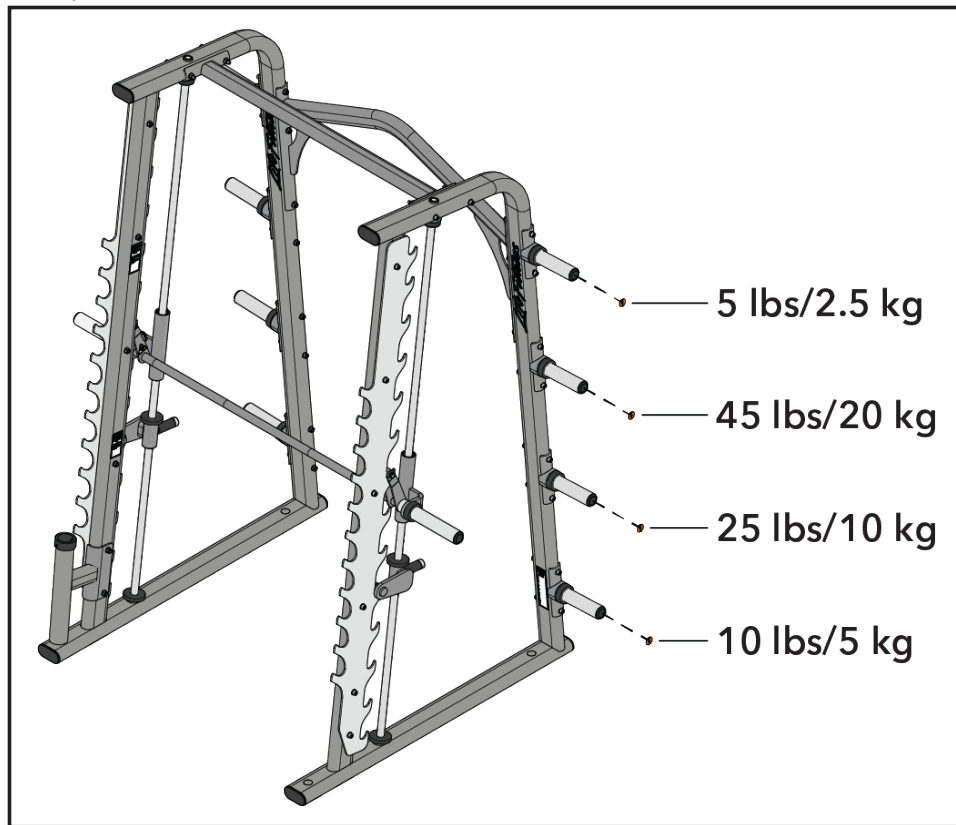

3. Product Information

Specifications

Machine Weight:	398 lbs.	180 kg.
Size:	in. = 51 L x 73 W x 88 H	cm = 130 L x 185 W x 223 H
Live Area:	in. = 120 L x 120 W	cm = 305 L x 305 W
Training Weight:	495 lbs.	220 kg.

Smith Bar

Plate Capacity:	5-45 lb. plates per weight rod	4-25 kg. plates per weight rod
Start Resistance:	45 lbs.	20 kg.

Olympic Bar*

Plate Capacity:	8-45 lb. plates per weight rod	6-25 kg. plates per weight rod
Max Resistance:	765 lbs.	320 kg.

*Assuming a 45 lb. Olympic-Style Barbell

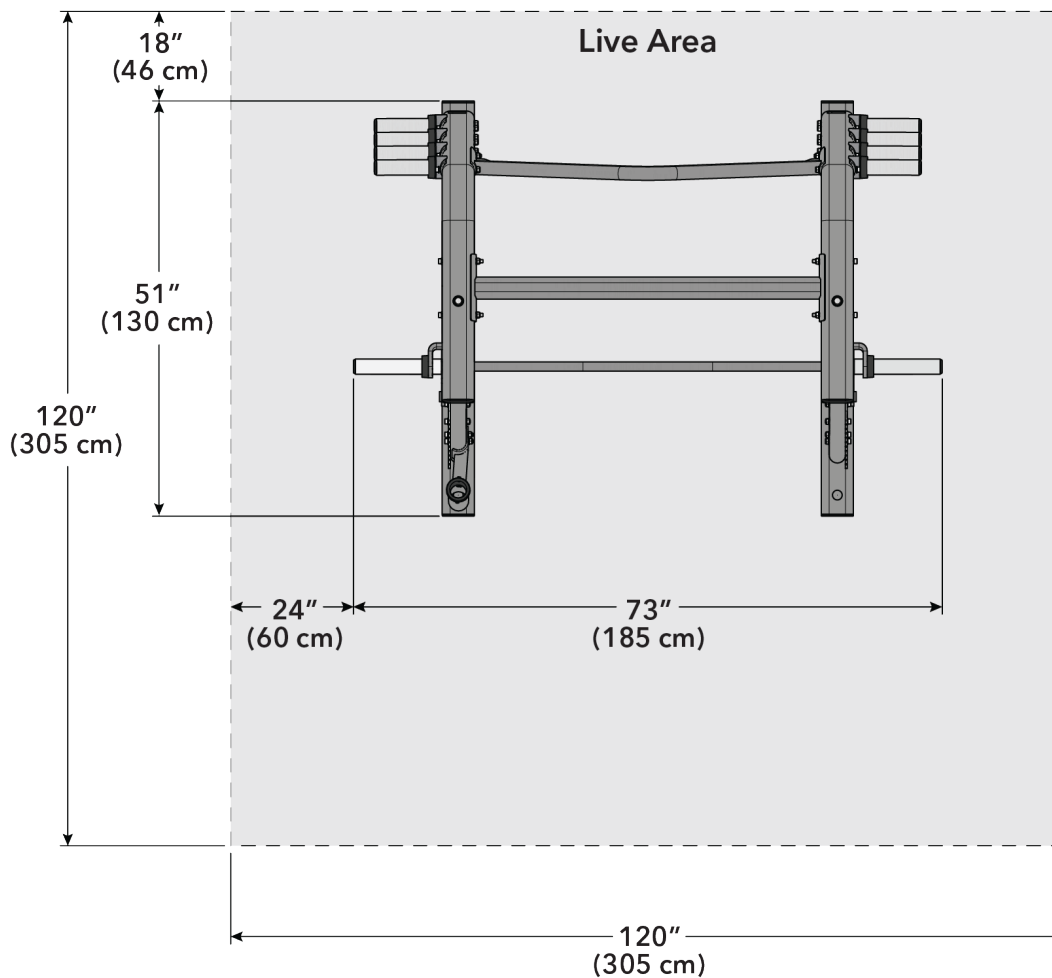

4. Maintenance Procedures

Maintenance Schedule

ACTION	DAILY	WEEKLY	MONTHLY	AS NEEDED
CLEAN				
Guide Rods			X	
Hand Grips				X
WAX				
Frames				X
INSPECT				
Paint			X	
Hardware		X		
Frame		X		
Hand Grips		X		
LUBRICATE				
Guide Rods				X

Clean

- Guide rods with a cotton cloth.
- Hand grips with an approved or compatible cleaner.

Wax

- Frames with a standard, non-abrasive, wax finish.

Inspect

- Hardware. Check for loosening. Tighten as required.
- Frames. Inspect for wear and damage.
- Handgrips. Check for wear and damage.
- For paint chips. Fill in immediately with LIFE FITNESS touch-up paint.

Lubricate

- Lubricate guide rods with Break-Free® brand lubricant (part number SK50-P0005-0000). Apply the lubricant to a cotton cloth, and then run the cotton cloth up and down the guide rods as needed.
-  **NOTE:** Only a few drops of lubricant are required for each guide rod.

Once a Week

- Visually inspect all hardware for loosening, tampering or wear.
- Check condition of hand grips.

Once a Month

- Clean guide rods with Break-Free® brand lubricant (part number SK50-P0005-0000). Clean tops of bearings at stack and inspect for heavy buildup on rods below the head plate. Lift half of stack and do a visual inspection, then clean as necessary.
- Inspect hardware on all machines and tighten any bolts or nuts that may have loosened over the life of the product.

Notes

- Use polishing compound (such as car wax) and remove shoe scuffs from powder coated surfaces as necessary.

Approved and Compatible Cleaners

Two preferred cleaners have been approved by reliability experts: PureGreen 24 and Gym Wipes. Both cleaners will safely and effectively remove dirt, grime and sweat from equipment. PureGreen 24 and the Antibacterial Force formula of Gym Wipes are both disinfectants that are effective against MRSA and H1N1.

PureGreen 24 is available in a spray which is convenient for gym staff to use. Apply the spray to a microfiber cloth and wipe down the equipment. Use PureGreen 24 on the equipment for at least 2 minutes for general disinfection purposes and at least 10 minutes for fungus and viral control.

Gym Wipes are large, durable pre-moistened wipes to use on the equipment before and after workouts. Use Gym Wipes on the equipment for at least 2 minutes for general disinfection purposes.

Contact Customer Support Services to order these cleaners (1-800-351-3737 or email: customersupport@lifefitness.com).

Mild soap and water or a mild non-abrasive household cleaner can also be used to clean the display and all exterior surfaces. Use a soft microfiber cloth only. Apply the cleaner to the microfiber cloth before cleaning. DO NOT use ammonia or acid based cleaners. DO NOT use abrasive cleaners. DO NOT use paper towels. DO NOT apply cleaners directly to the equipment surfaces.

Removal of Paint, Marking Pens, or Labels

- Butyl cellosolve works well for removal of paints, marking pen inks, lipstick, etc.
- Labels, stickers, etc. may be removed using kerosene. When the solvent will not penetrate sticker material, apply heat (hair dryer) to soften the adhesive and promote removal. GASOLINE SHOULD NOT BE USED.

5. Warranty

What is Covered

This LIFE FITNESS commercial exercise equipment product is warranted to be free of all defects in material and workmanship.

Who is Covered

The original purchaser or any person receiving the product as a gift from the original purchaser.

Who Pays Transportation and Insurance For Service

If the Product or any covered part must be returned to a service facility for repairs, We, Life Fitness, will pay all transportation and insurance charges for the first year. You are responsible for transportation and insurance charge after the first year.

What We Will Do To Correct Covered Defects

We will ship to you any new or rebuilt replacement part or component, or at our option, replace the Product. Such replacement parts are warranted for the remaining portion of the original warranty period.

What is Not Covered

Any failures or damage caused by unauthorized service, misuse, accident, negligence, improper assembly or installation, debris resulting from any construction activities in the Product's environment, rust or corrosion as a result of the Product's location, alterations or modifications without our written authorization, or by failure on your part to use, operate and maintain the Product as set out in your Operation Manual.

All terms of this warranty are void if this product is moved beyond the continental borders of the United States of America (excluding Alaska, Hawaii and Canada) and are then subject to the terms provided by that country's local authorized Life Fitness representative.

Owner's Manual

It is VERY IMPORTANT THAT YOU READ THIS MANUAL before operating the Product. Remember to perform the periodic maintenance requirements specified in the Manual to assure proper operation and your continued satisfaction.

Exclusive Warranty

THIS LIMITED WARRANTY IS IN LIEU OF ALL OTHER WARRANTIES OF ANY KIND EITHER EXPRESSED OR IMPLIED, INCLUDING BUT NOT LIMITED TO THE IMPLIED WARRANTIES OF MERCHANTABILITY AND FITNESS FOR A PARTICULAR PURPOSE, AND ALL OTHER OBLIGATIONS OR LIABILITIES ON OUR PART. We neither assume nor authorize any person to assure for us any other obligation or liability concerning the sale of this Product. Under no circumstances shall we be liable under this warranty, or otherwise, of any damage to any person or property, including any lost profits or lost savings, for any special, indirect, secondary, incidental or consequential damages of any nature arising out of the use of or inability to use this Product. Some states do not allow the exclusion or limitation of implied warranties or of liability for incidental or consequential damages, so the above limitations or exclusions may not apply to you. Warranty coverages and terms may differ outside the United States. Please contact the Life Fitness office servicing your country (contact information found at the front of this manual) or visit the applicable local Life Fitness website to receive the specific warranty information for your country.

Changes in Warranty Not Authorized

No one is authorized to change, modify or extend the terms of this limited warranty.

Effects of State Laws

This warranty gives you specific legal rights, and you may have other rights which vary from state to state and country by country.

Warranty Coverage

 **NOTE:** There is no warranty coverage for labor on Strength Products.

Item	10 Years	5 Years	1 Year	90 Days
Frame	X			
Guide Rods		X		
Grips			X	
Hardware / Mechanical				X
Items Not Specified				X

6. Bolt to Floor Guidelines

Introduction

LIFE FITNESS designs its products to be stable when used as designed. Because strength training is dynamic, we cannot predict how users will ultimately use the products in all circumstances. Therefore, LIFE FITNESS recommends that strength training equipment be secured to a solid, level surface to stabilize and eliminate rocking or tipping over. For some equipment, securing the equipment to the floor is REQUIRED.

Each new unit shipped comes with a multi-language hangtag stating the importance of bolting the unit down as a safety precaution.

It is the facility's responsibility to adhere to local and regional building codes.

Delivery and Installation Tips

All Anchors

- Fasteners must have minimum embedment in concrete floor, not including screed, regardless of wood/tile/rubber over sub-floor. (See *Anchor Types* for maximum sub-floor thickness between unit and concrete to equipment foot must be made of flooring or other material (i.e. no air gaps)).
- DO NOT reuse fasteners. Static and Dynamic anchors are designed for one-time use only.
- Factor in equipment's feet height when selecting fastener length.
- Factor in flooring thickness when selecting fastener length.
- It is also recommended to drill an additional 1/2" (12.7 mm) of depth beyond the length of the fastener being used to ensure that debris does not block the entry of the anchor.
- Minimum concrete compressive strength: 3000 psi (20 N/mm²).

Anchoring

- LIFE FITNESS requires that each foot has at least one anchor bolted to the floor.
- All anchors must have a minimum embedment into concrete, regardless of wood/tile/rubber/screed over sub-floor.
- Dynamic anchors must have a minimum embedment depth in concrete to ensure maximum security and pull out force. See *Anchor Types* for embedment depth minimums.

Building Codes

It is the facility's responsibility to adhere to local and regional building codes. Please verify with the customer to ensure that they are aware of this.

Carpeting

If bolted down to carpet flooring, be sure to use a box cutter knife to cut the carpet threads around each foot. This will help avoid the carpet threads from being wrapped around and pulled by the drill bit.

Competitor Product

The bolt down guidelines and procedures for LIFE FITNESS products were determined by the company's Engineering and Installation Development groups. These guidelines include which anchors to use and positioning of the anchors are required for LIFE FITNESS product.

- LIFE FITNESS does not have that level of specification or engineering input for competitive product.
- LIFE FITNESS installation teams are not permitted to anchor competitor equipment.

Drilling

It is also recommended to drill an additional 1/2" (12.7 mm) of depth beyond the length of the fastener being used to ensure that debris does not block the entry of the anchor.

- This can be done by marking your drill bit with a piece of tape.
- While it is recommended that a vacuum be used to clean up debris, this will not account for all the debris that will settle at the bottom of the drilled hole.

Anchor Types

Anchor	Subfloor between unit and concrete 0" to 1/2" (12.7mm) thick		Subfloor between unit and concrete over 1/2" (12.7mm) thick	
	Imperial	Metric	Imperial	Metric
Static	Imperial	KH-EZ 1/4" x 4"	Imperial	KH-EZ 1/4" x 5"
	Metric	HUS-H 6mm x 120mm	Metric	HUS-H 6mm x 150mm

Anchor Specifications

Static Anchor	Minimum Concrete Thickness	Minimum Drill Depth in Concrete	Minimum Concrete Embedment	Minimum concrete compressive strength
KH-EZ 1/4"	4-1/8" (105mm)	1/2" beyond anchor length	2-1/2" (63.5mm)	3000psi
HUS-H 6mm	100mm (3-3/32")	10mm beyond anchor length	55mm (2-1/64")	20 N/mm ²

Pullout Force

LIFE FITNESS specifies Hilti™ static and dynamic anchors. According to the anchor manufacturer, the recommended design pullout force (in tension) for the specified anchors, when properly installed in cracked concrete, is provided in the side table. This table should be used for reference only; for additional and up-to-date information on the anchor capabilities or the design pullout force in other substrates, please consult Hilti directly at <https://www.us.hilti.com>.

Selected Anchor	Design Resistance in Tension *
KH-EZ 1/4" x 4"	830 lb
HUS-H 6MM x 120MM	3.3 kN
KH-EZ 3/8" x 4"	1535 lb
KH-EZ 3/8" x 5"	1535 lb
HUS-H 8MM x 120MM	3.3 kN
HUS-H 8MM x 150MM	3.3 kN
HSL-3/8 4"	2000 lb
HST M12 x 115/20	8 kN
HST M12 x 195/200	8 kN
KB-TZ 3/8" x 3-3/4"	1615 lb

* Design strength extracted from the Hilti Anchor Fastening Technology Manual issued September 2014.

Tools Required

 **WARNING:** Adhere to manufacturer's equipment warnings and guidelines. Follow manufacturer's instructions for proper usage.

Static Anchor

- Floor scanner/rebar detector (optional)
- 1" L-shape SDS rotary hammer
- 1/4" x 12" (6mm x 305mm) carbide drill bit (for 1/4" (6mm) anchors)
- 3/8" x 12" (8mm x 305mm) carbide drill bit (for 3/8" (8mm) anchors)
- Safety glasses
- Extension cord
- Impact wrench
- Vacuum (for debris)

Static Anchor Procedure

 **CAUTION:** If it is possible that the length of your bolt will not provide the minimum requirement of 2.5" (63.5mm) of engagement, a longer anchor should be used.

1. Place unit into position to be mounted and cycle unit to set stance.
2. Each foot **must** get at least one static fastener.

3. Wearing protective glasses, drill down into the flooring to the required depth as perpendicular as possible, ensuring that the foot thickness is being accounted for; refer to *Anchor Selection* and *Foot Dimensions*.

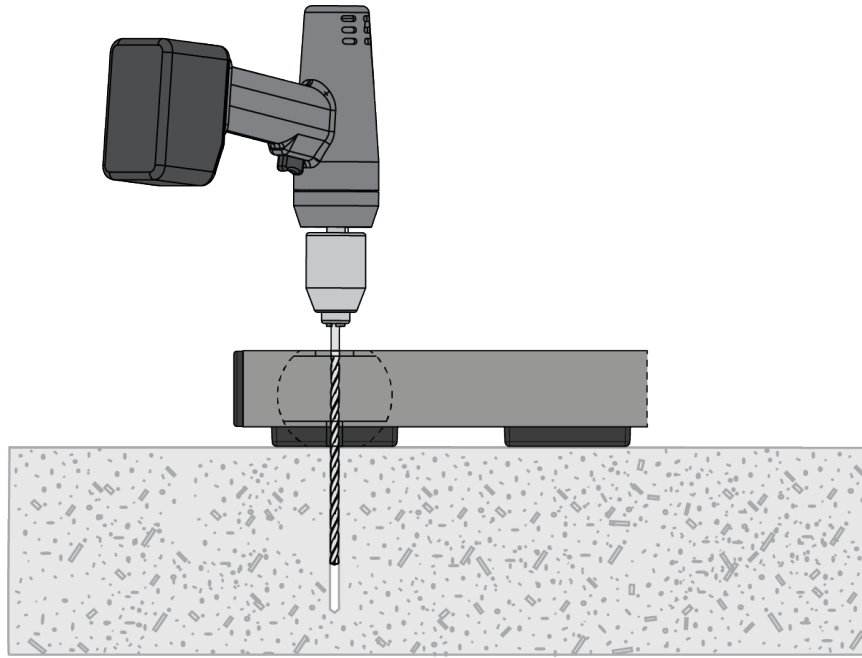

4. Insert fastener and tighten to 18 Foot-Pounds (24Nm) for 1/4" (6mm) anchor or 40 Foot-Pounds (54Nm) for 3/8" (8mm) anchor.

 **NOTE:** If the legs/frame do not contact the mounting surface **DO NOT** pull down with the fastener or anchor. Loosen frame hardware and re-tighten to allow machine to align.

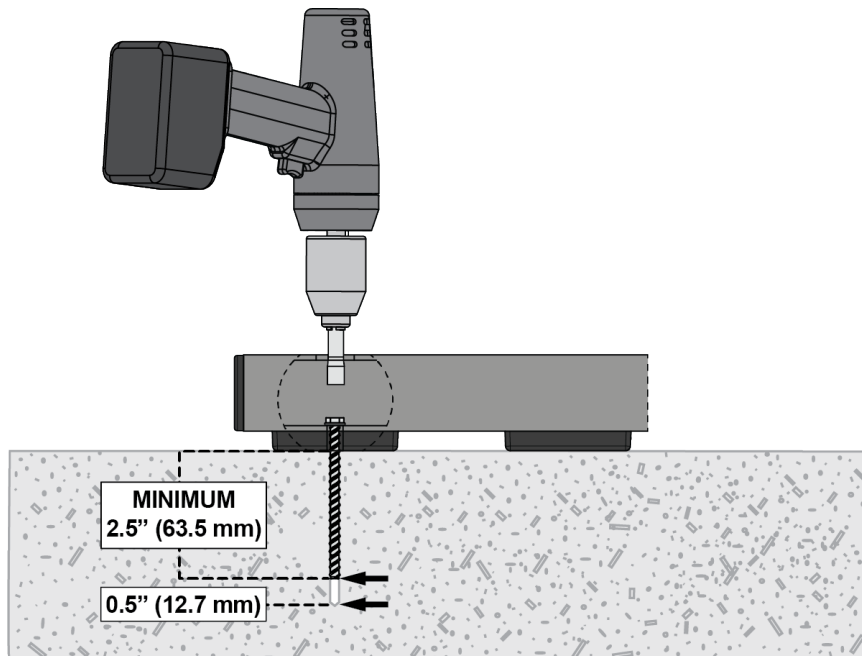

Foot Dimensions

Use below image to determine foot specifications.

