

Broadcast Vision Upgrade Kit 625CRT

Kit Number KU-25267, KU-25268, or KU-25273

Installation Instructions

This instruction sheet describes how to install the Broadcast Vision upgrade kit for Cybex bike models 625C, 625R, and Cybex treadmill model 625T.

The procedures outlined in the instruction sheet are:

- [Install Kit, 625C, 625R Bikes](#), page 2
- [Install Kit, 625T Treadmill](#), page 12
- [Connect Broadcast Vision to Cybex product](#), All products, page 21

Tools Required:

- Phillips screwdriver
- Utility knife
- ESD (Electrostatic Discharge) grounding strap
- Headphones (not included)

 Read and understand all instructions thoroughly before installing this kit.

Verify the kit contents shown.

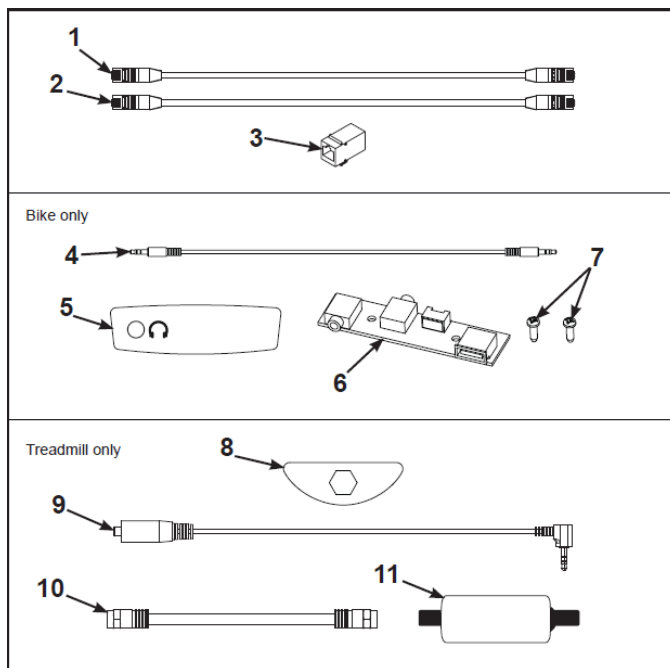

	Description	Qty.
1	Cable, Cat6, 7 ft., AW-24892 (625R)	1
2	Cable, Cat6, 8.3 ft., AW-24865 (625C and 625T)	1
3	Coupler, CN-24895 (625CRT)	1
4	Cable, Headphone jack jumper, AW-23298 (625CR)	1
5	Decal, Headphone jack, DE-23399 (625CR)	1
6	PCA, Headphone jack board, AD-23332 (625CR)	1
7	Screw, 4 x 3/8", HS-20553 (625CR)	2
8	Decal, Headphone jack, DE-22784 (625T)	1
9	Cable, Headphone jack jumper, AW-22480 (625T)	1
10	Coax cable, 6" AW-25319 (625T)	1
11	Coax cable filter, EC-25318 (625T)	1

Disconnect power source

Unplug the power cord from the power outlet.

⚠ WARNING

Shock and electrocution hazard.

- Unplug unit and let sit 10 minutes before cleaning or performing maintenance.
- Electrical charge can remain in unit after unplugging.
- Keep water and liquids away from electrical parts.

NOTICE

Component damage. Wear an ESD grounding strap during this procedure. Connect ESD grounding strap to frame bolts or unpainted metal of frame. If ESD grounding strap is not available, touch frame bolts or unpainted metal of frame before handling any electronics.

Install Kit, 625C, 625R Bikes

Remove back cover (625C shown)

Remove four screws securing back cover to console assembly using a Phillips screwdriver.

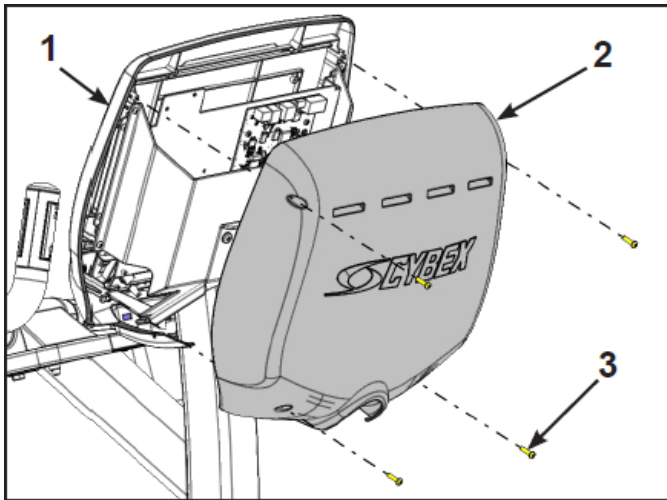

	Description	Qty.
1	Console assembly	1
2	Back cover	1
3	Screw	4

Remove console assembly

Remove six screws securing console assembly to console support using a Phillips screwdriver.

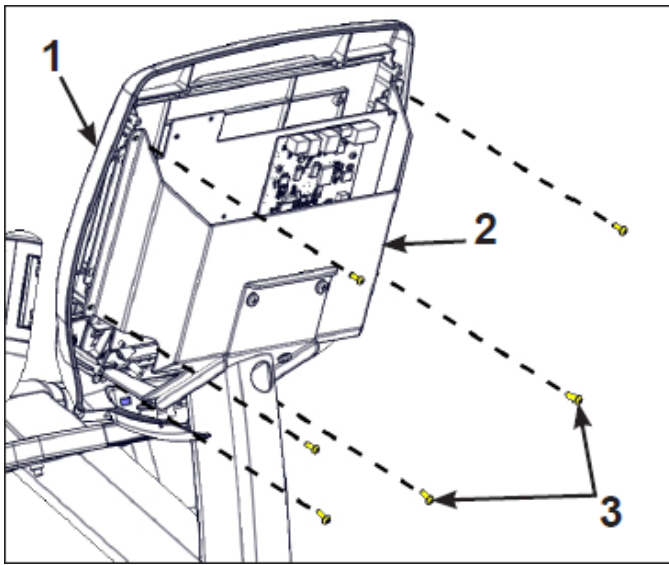

	Description	Qty.
1	Console assembly	1
2	Console support	1
3	Screw	6

Disconnect console cables

1. Disconnect console cables from MCC board.

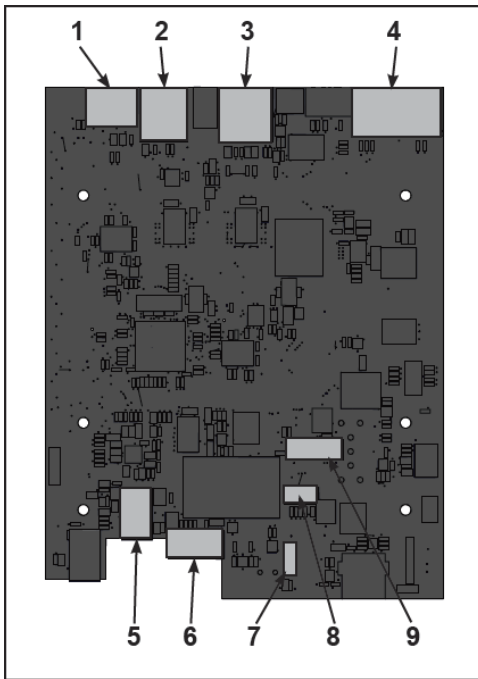

	Description	Qty.
1	MYE/BV, Gray	1
2	CSAFE, Red	1
3	Console cable	1
4	Upper display	1
5	Headphone jack	1
6	iPod (optional)	1
7	Heart rate	1
8	Handset membrane	1
9	iPod board assembly (optional)	1

MCC board cables

2. Unplug cables from MCC board by un-latching connectors with the following procedure:

a) Press in the top of the cable connector.

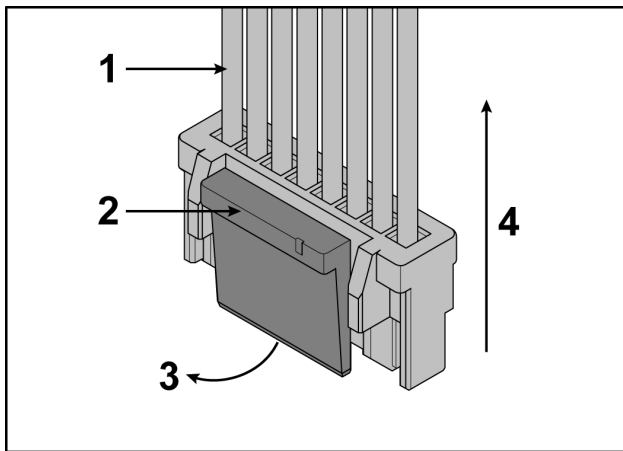

	Description	Qty.
1	DO NOT PULL CONNECTOR OUT BY THE WIRES!	1
2	Step a, Latch	1
3	Step b	1
4	Step c	1

b) Ensure latch disengages the connector.

c) Unplug cable by holding down latch and pulling straight out from connector. Do not pull on wires, remove by connector.

Install headphone jack board

1. Remove the blank decal from the headphone jack cover using a utility knife.

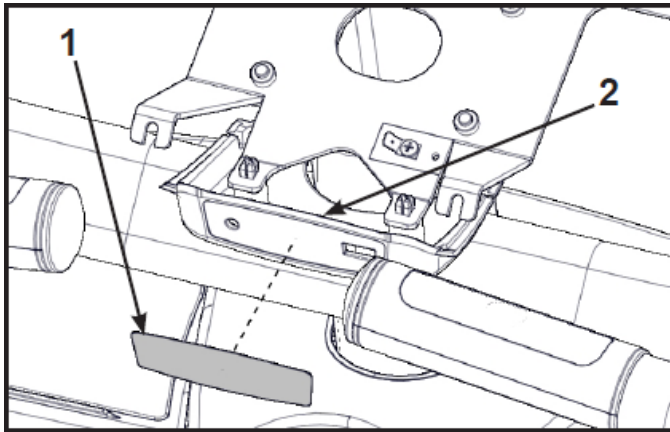

	Description	Qty.
1	Blank decal	1
2	Headphone jack cover	1

- Install the two 4 x 3/8" screws securing the headphone jack board to the headphone jack cover using a Phillips screwdriver.

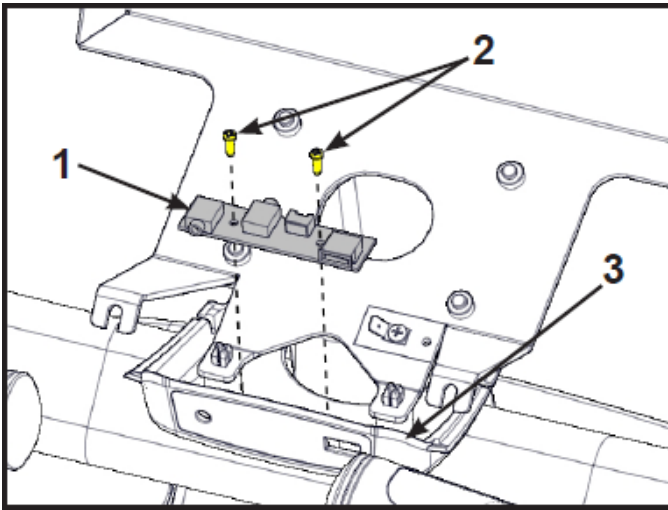

	Description	Qty.
1	Headphone jack board	1
2	Screws, 4 x 3/8"	2
3	Headphone jack cover	1

- Install the headphone jack decal to the headphone jack cover.

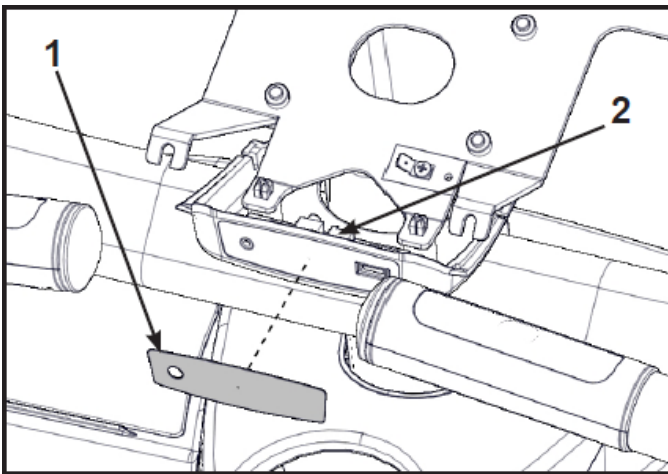

	Description	Qty.
1	Headphone jack decal	1
2	Headphone jack cover	1

- Plug the headphone jack cable into the headphone jack board.

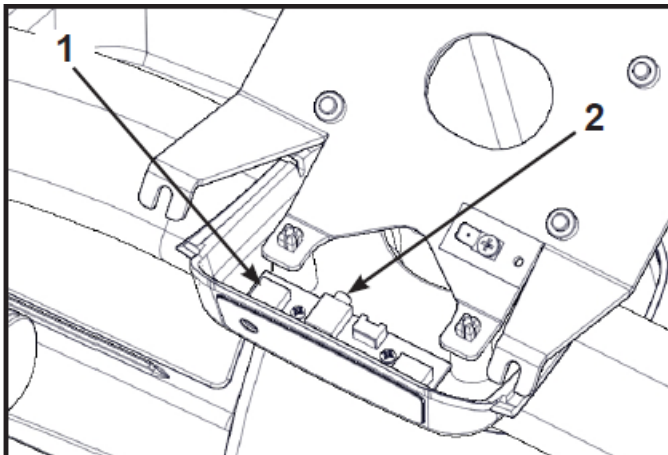

	Description	Qty.
1	Headphone jack board	1
2	Plug cable in here	1

Connect console cables

1. Install console cables to MCC board.

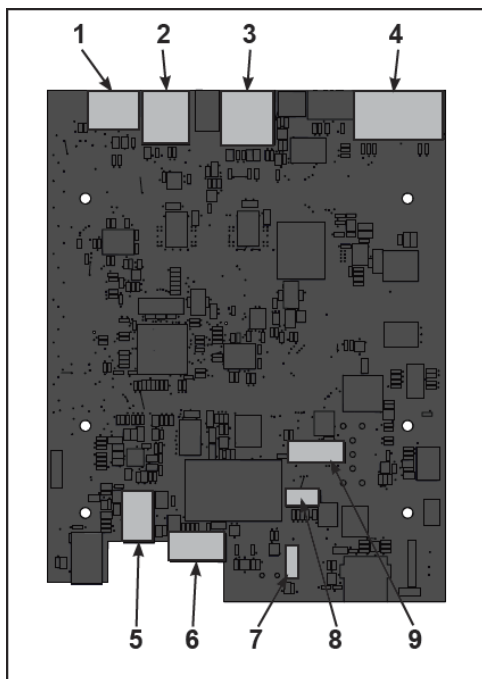

	Description	Qty.
1	MYE/BV, Gray	1
2	CSAFE, Red	1
3	Console cable	1
4	Upper display	1
5	Headphone jack	1
6	iPod (optional)	1
7	Heart rate	1
8	Handset membrane	1
9	iPod board assembly (optional)	1

MCC board cables

2. Plug Cat6 cable into gray connector (1).
3. Plug headphone jack jumper into headphone jack (5).

Remove front covers, Upright bike

1. Remove screw securing front right cover using a Phillips screwdriver.
In addition to the mounting screws, there are four plastic connectors that secure front covers together. Ensure that all four plastic connectors are inserted properly in each front cover.

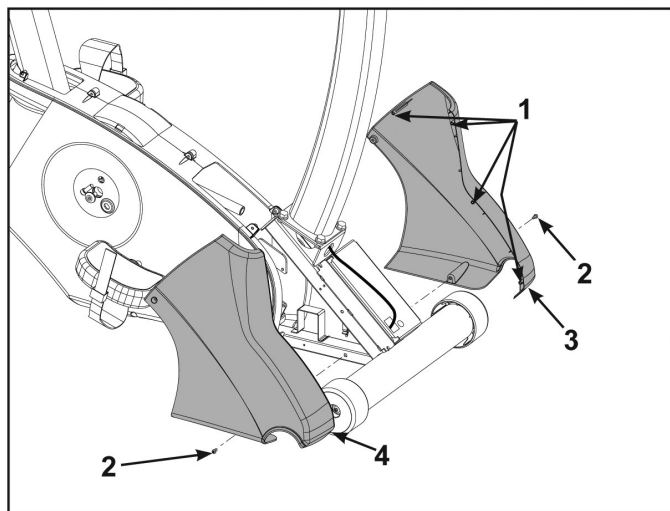

	Description	Qty
1	Plastic connector	4
2	Screw	2
3	Front left cover	1
4	Front right cover	1

2. Remove front right cover.

3. Remove screw securing front left cover using a Phillips screwdriver.
4. Remove front left cover.

Remove front covers, Recumbent bike

1. Remove three screws securing front left cover using a Phillips screwdriver.
In addition to three mounting screws per front cover, there are five plastic connectors that secure front covers together. Ensure that all five plastic connectors are inserted properly in each front cover.

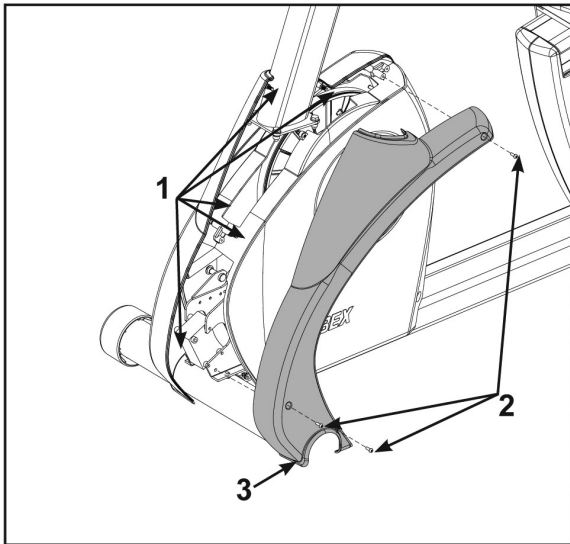

	Description	Qty
1	Plastic connector	5
2	Screw	3
3	Front left cover	1

2. Remove front left cover.
3. Remove three screws securing front right cover using a Phillips screwdriver.

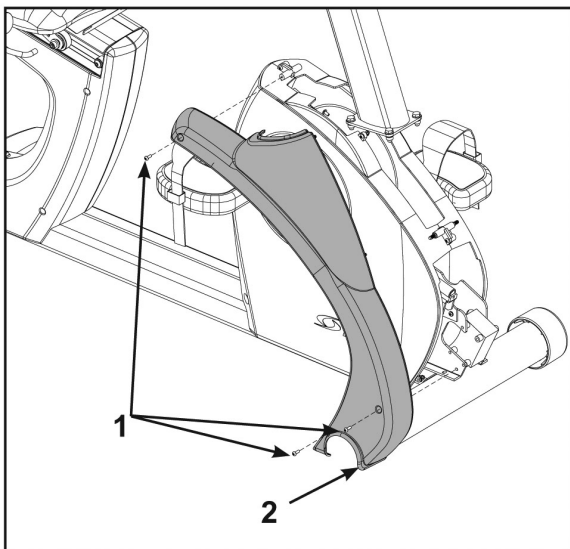

	Description	Qty
1	Screw	3
2	Front right cover	1

4. Remove front right cover.

Install Cat6 cable, Upright bike

1. Route Cat6 cable through console and down into weldment.

- Route Cat6 cable into top of upright tube until it exits through lower hole in upright tube.

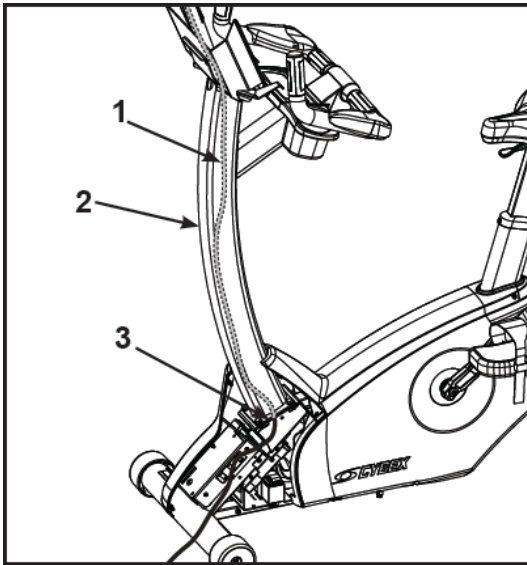

	Description	Qty.
1	Cable	1
2	Upright tube	1
3	Lower hole	1

Install Cat6 cable, Recumbent bike

- Route Cat6 cable through console and down into weldment.
- Route Cat6 cable into top of upright tube until it exits through lower hole in upright tube.

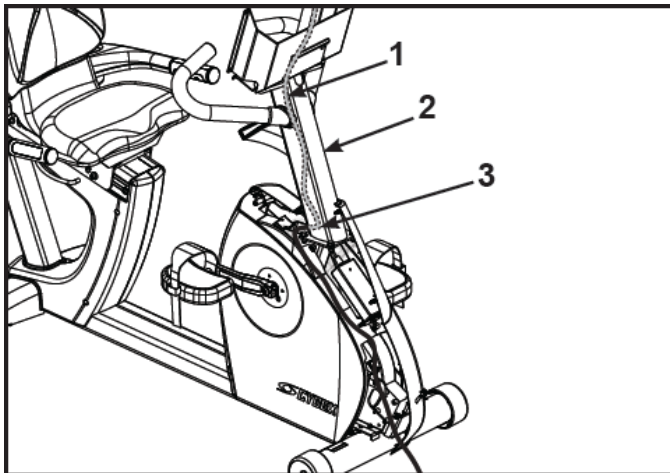

	Description	Qty.
1	Cable	1
2	Upright tube	1
3	Lower hole	1

Install front covers, Upright bike

In addition to mounting screws, there are four plastic connectors that secure front covers together. Ensure that all four plastic connectors are inserted properly in each front cover.

- Install screw securing front left cover using a Phillips screwdriver.

2. Install screw securing front right cover using a Phillips screwdriver.

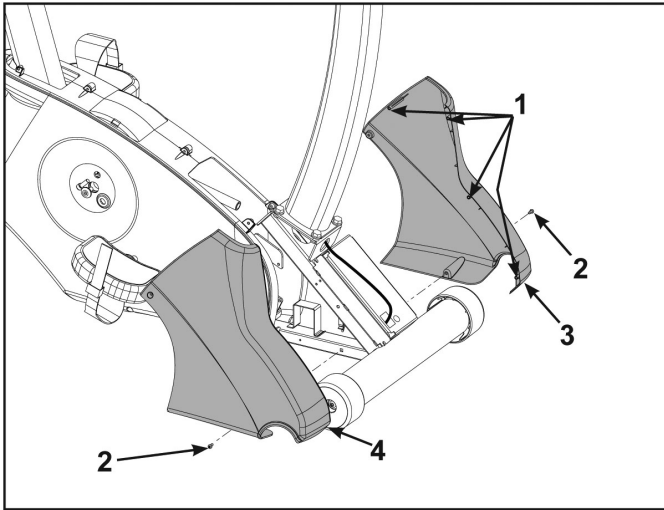

	Description	Qty
1	Plastic connector	4
2	Screw	2
3	Front left cover	1
4	Front right cover	1

Install front covers, Recumbent bike

In addition to two mounting screws per front cover, there are five plastic connectors that secure front covers together. Ensure that all four plastic connectors are inserted properly in each front cover.

1. Install three screws securing front left cover using a Phillips screwdriver.

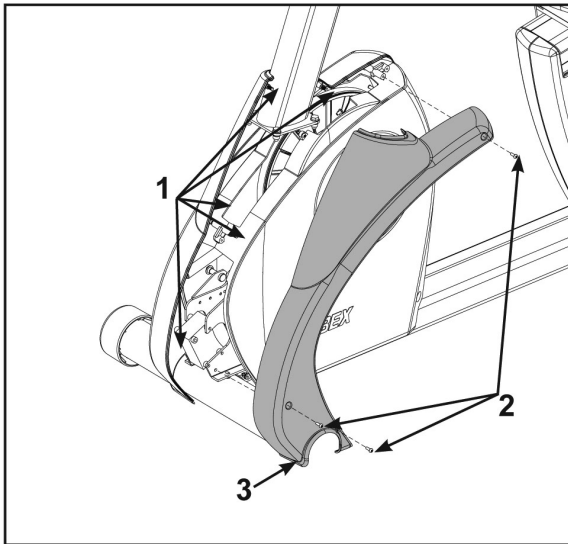

	Description	Qty
1	Plastic connector	5
2	Screw	3
3	Front left cover	1

2. Install three screws securing front right cover using a Phillips screwdriver.

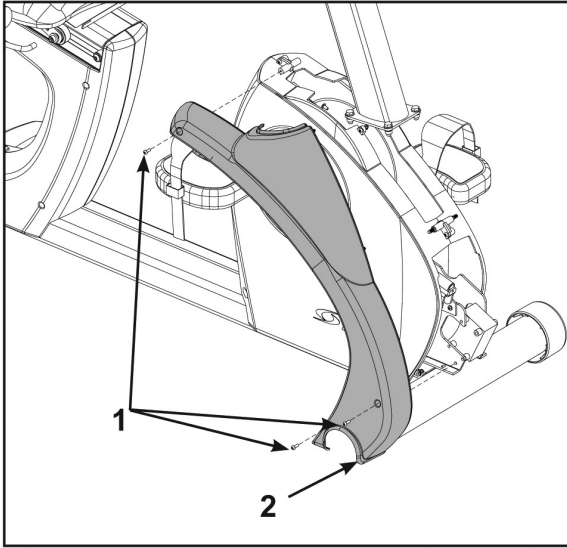

	Description	Qty
1	Screw	3
2	Front right cover	1

Install console assembly

Install six screws securing console assembly to console support using a Phillips screwdriver.

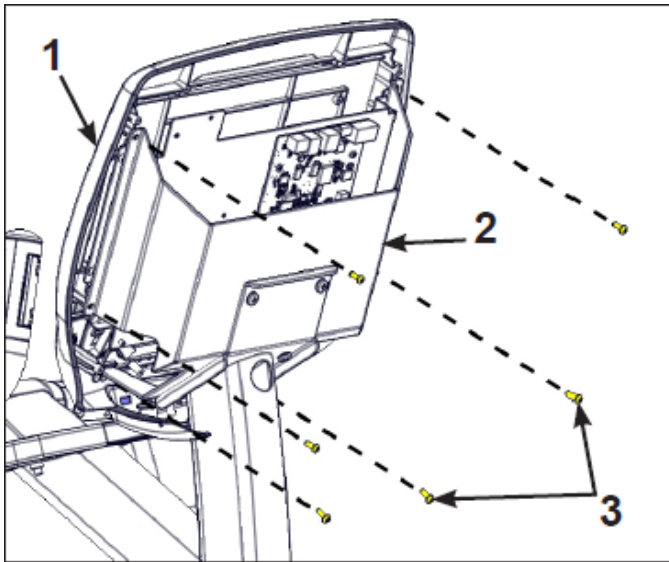

	Description	Qty.
1	Console assembly	1
2	Console support	1
3	Screw	6

Install back cover

Install the four screws securing the back cover to the console assembly using a Phillips screwdriver.

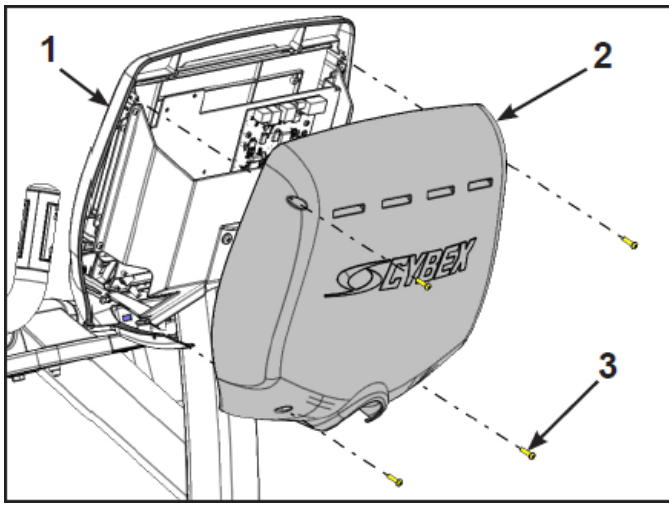

	Description	Qty.
1	Console assembly	1
2	Back cover	1
3	Screw	4

Install coupler

Plug coupler onto end of Cat6 cable at base.

Proceed to [Connect Broadcast Vision to Cybex product](#) on page 20.

Install Kit, 625T Treadmill

Remove back cover

Remove four screws securing back cover to console assembly using a Phillips screwdriver.

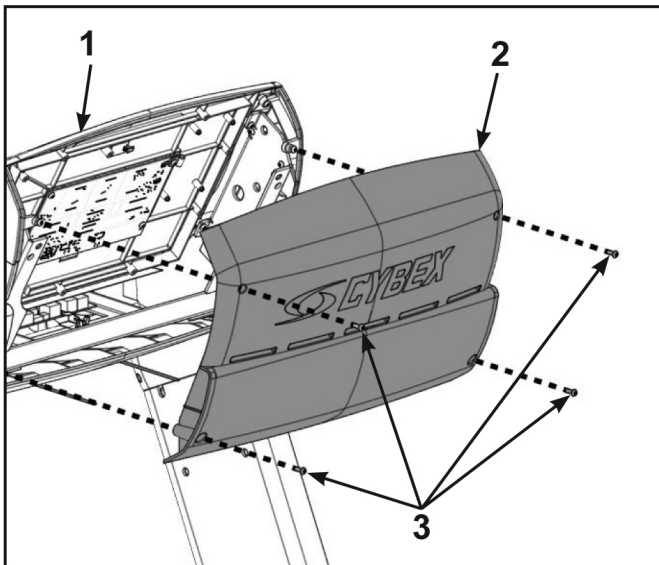

	Description	Qty.
1	Console Assembly	1
2	Back Cover	1
3	Screws	4

Remove access cover

Remove the two screws securing the access cover to the handset using a Phillips screwdriver.

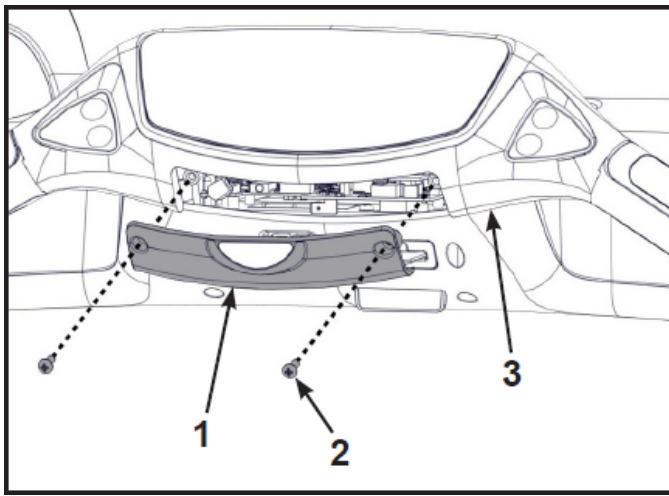

	Description	Qty.
1	Access Cover	1
2	Screws	2
3	Handset	1

Install headphone jack cable

1. Remove blank decal from headphone jack cover using a utility knife.
2. Install headphone jack decal on headphone jack cover.
3. Install nut into front of headphone jack cover.

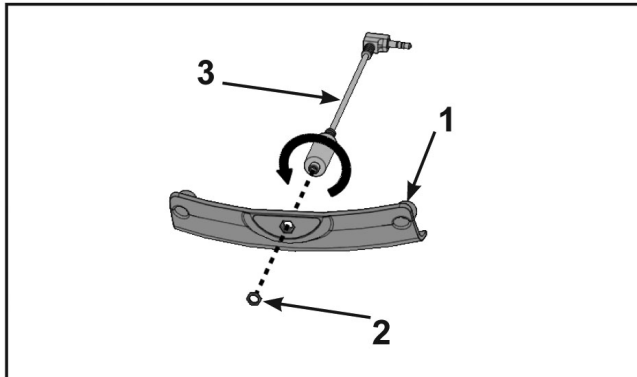

	Description	Qty.
1	Headphone Jack Cover	1
2	Nut	1
3	Headphone Jack Cable	1

4. Screw headphone jack cable into headphone jack cover and tighten by hand.

Connect headphone jack cable

Plug headphone jack cable into headphone jack (5).

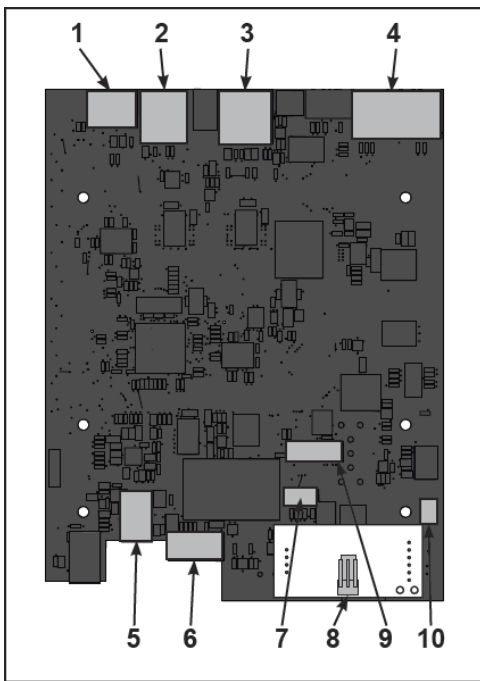

	Description	Qty.
1	MYE/BV, Gray	1
2	CSAFE, Red	1
3	Console cable	1
4	Upper display	1
5	Headphone jack	1
6	iPod (optional)	1
7	Handset membrane	1
8	Wireless heart rate	1
9	iPod board assembly (optional)	1
10	Contact heart rate grips	1

MCC board cables

Install handset cover

1. Plug the headphone jack cable into the headphone jack on the MCC board.

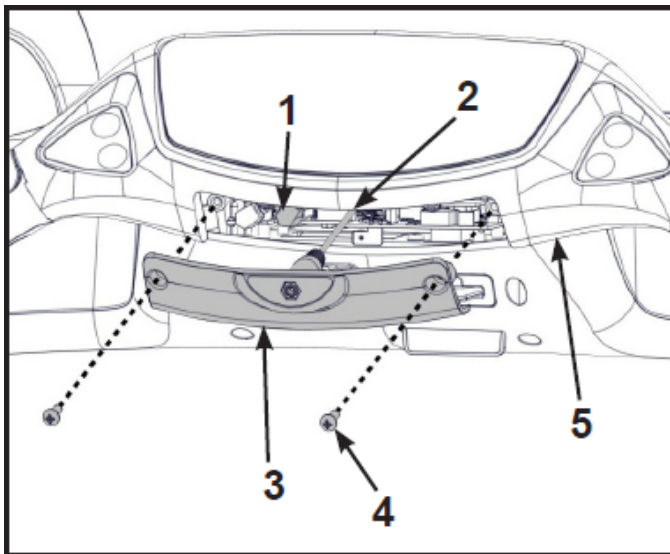

	Description	Qty.
1	Headphone jack	1
2	Headphone Jack Cable	1
3	Headphone Jack Cover	1
4	Screws	2
5	Handset	1

2. Install the two screws securing the headphone jack cover to the handset cover using a Phillips screwdriver.

Install Cat6 cable

1. Remove the sixteen screws securing the lower console cover to the console using a Phillips screwdriver.

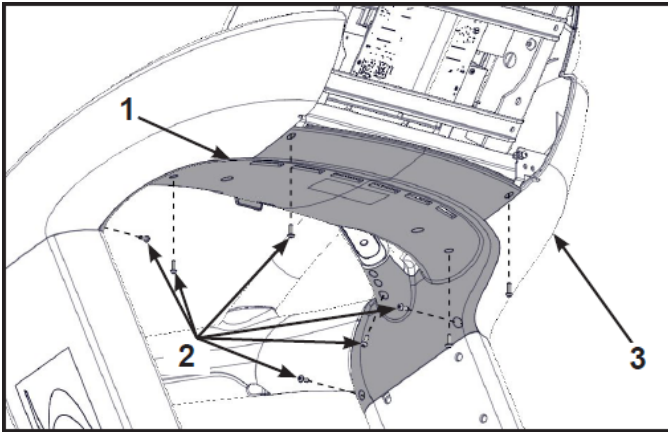

	Description	Qty.
1	Lower console cover	1
2	Screws	16
3	Console	1

Make note of screws and their location.

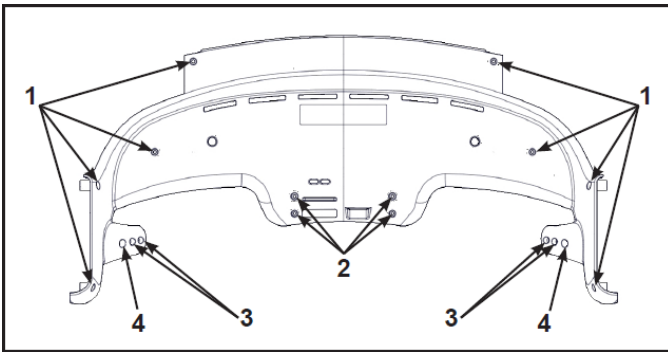

	Description	Qty.
1	Short screws	8
2	Long screws	4
3	Long sheet metal screws	4
4	Do not remove	2

2. Remove the lower cover by carefully bending to release from uprights.

NOTICE

Handset or cable damage may occur. Handset will be loose. Do not grab or hold onto handset. Damage to the handset or cables can occur.

3. Loosen, but do not remove the two front cover screws securing the motor cover using a Phillips screwdriver.

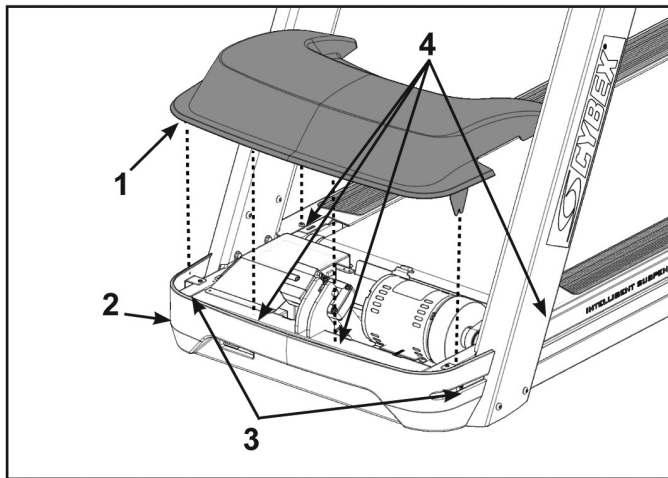

	Description	Qty.
1	Motor Cover	1
2	Front Cover	1
3	Screws	2
4	Plastic Connectors	4

4. Remove motor cover by carefully lifting vertically. Do not break the four plastic connectors.

5. Loosen, but do not remove the seven screws securing the shield to the base using a Phillips screwdriver.

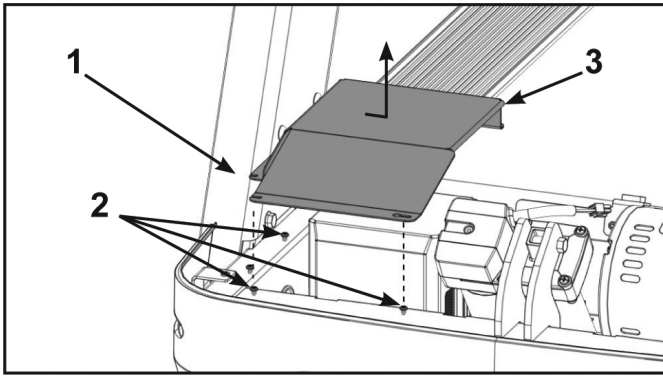

	Description	Qty.
1	Base	1
2	Screws	7
3	Shield	1

6. Remove shield by sliding sideways and then vertically off of base.

7. Plug Cat6 cable into gray connector on MCC board.

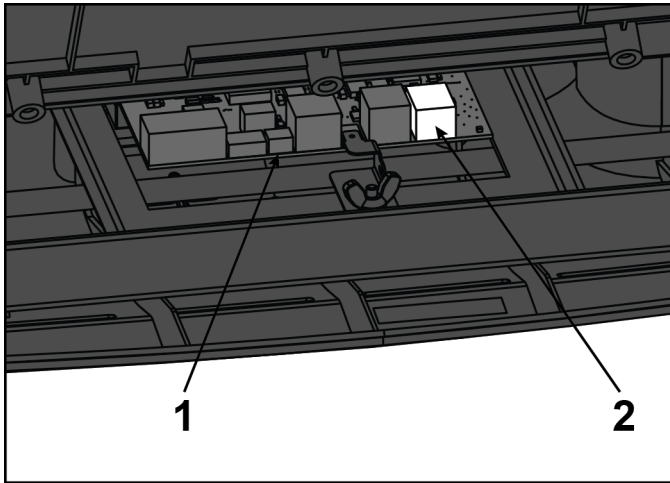

	Description	Qty.
1	MCC board	1
2	Gray connector	1

8. Insert the Cat6 cable into the back of the console until it exits near the top of the right upright.

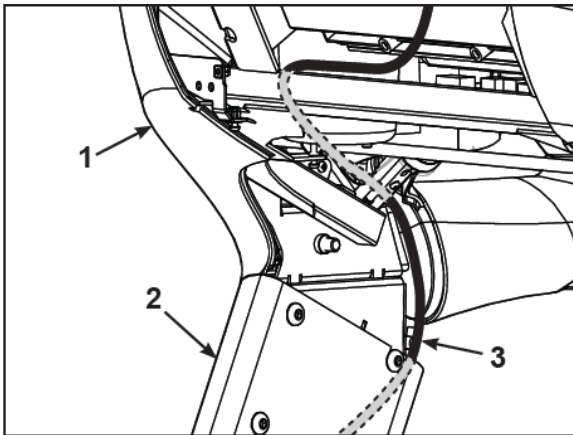

	Description	Qty.
1	Console	1
2	Upright	1
3	Cable	1

9. Feed the Cat6 cable down through the upright until it exits access hole at the bottom.

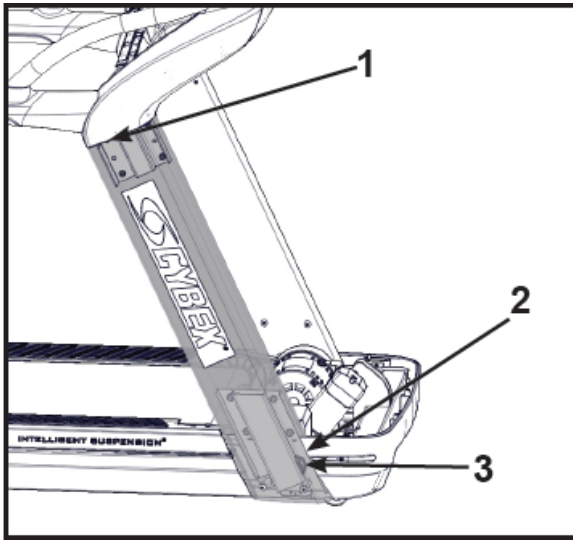

	Description	Qty.
1	Cable enters here	1
2	Cable exits here	1
3	Access hole	1

10. Insert the Cat6 coupler into the mounting plate by hooking the upper tab into the mounting plate and snapping in the lower tab.

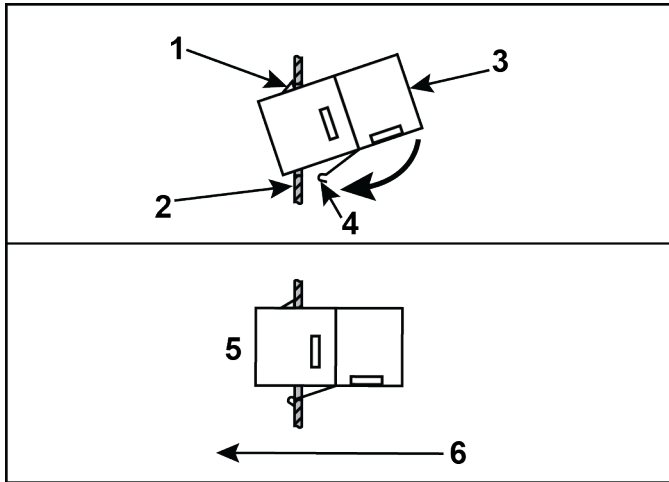

	Description	Qty.
1	Upper tab	1
2	Mounting plate	1
3	Cat6 coupler	1
4	Lower tab	1
5	Installed	1
6	Front of unit	1

11. Plug the Cat6 cable into the coupler on the front of the unit.

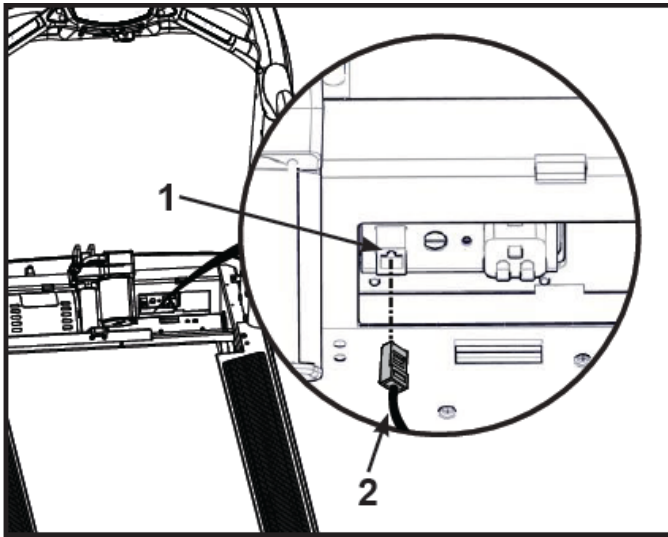

	Description	Qty.
1	Coupler	1
2	Cat6 cable	1

Install shield

Using a Philips screwdriver tighten the seven screws securing the shield to the base.

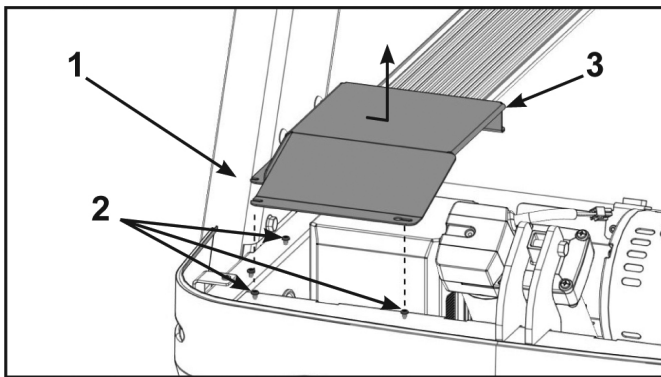

	Description	Qty.
1	Base	1
2	Screws	7
3	Shield	1

Install motor cover

1. Place the motor cover into position vertically by aligning the two tabs and four plastic connectors. Two plastic connectors are mounted in the front cover and two in the motor cover. If motor cover top does not fit properly, loosen the side screws as needed.

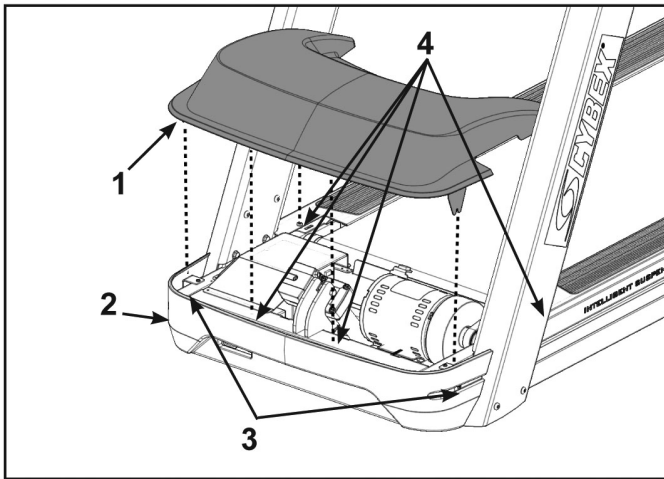

	Description	Qty.
1	Motor Cover	1
2	Front Cover	1
3	Screws	2
4	Plastic Connectors	4

2. Tighten the two front cover screws using a Phillips screwdriver. Be sure the screws are securing the motor cover's tabs.

Install lower console cover

Install the sixteen screws securing the lower console cover to the console using a Phillips screwdriver.

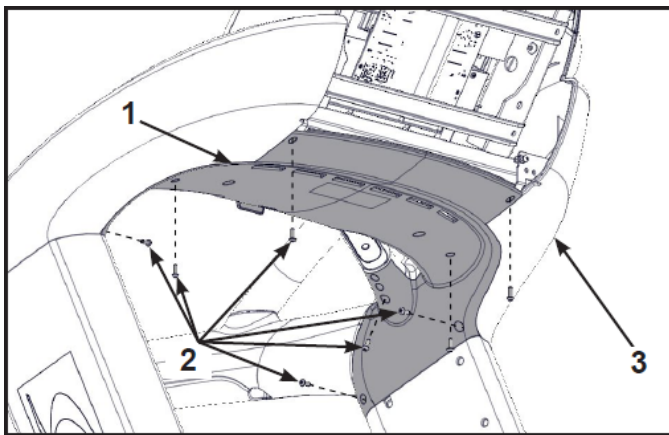

	Description	Qty.
1	Lower console cover	1
2	Screws	16
3	Console	1

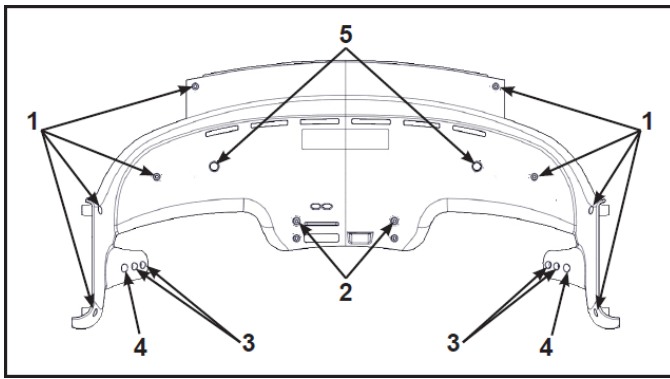

	Description	Qty.
1	Short screws	8
2	Long screws	4
3	Long sheet metal screws	4
4	Do not remove	2
5	Drainage holes	2

Install back cover

Install the four screws securing the back cover to the console assembly using a Phillips screwdriver.

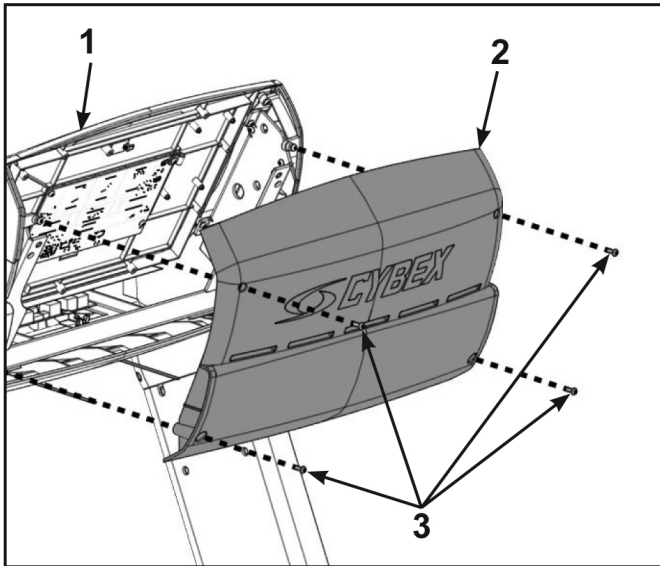

	Description	Qty.
1	Console Assembly	1
2	Back Cover	1
3	Screws	4

Install coax cable filter (Treadmill only)

1. Turn the Broadcast Vision television off.
2. Unscrew the coax cable from the Broadcast Vision television.

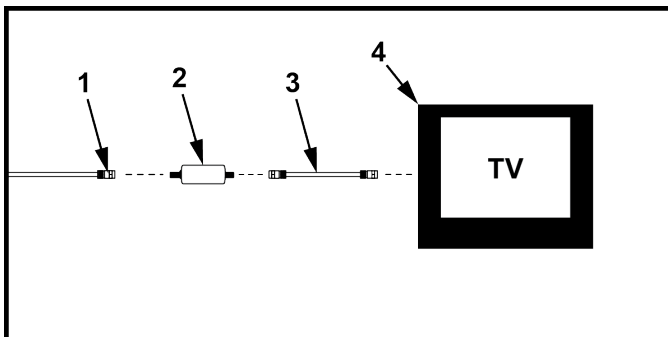

	Description	Qty.
1	Coax cable, from cable provider	1
2	Coax cable filter	1
3	Coax cable, 6"	1
4	Broadcast Vision television	1

3. Install the coax cable filter to the coax cable from cable provider.

4. Install the 6” coax cable to the coax cable filter.
5. Install the 6” coax cable to the Broadcast Vision television.
6. Turn the Broadcast Vision television on.

Connect Broadcast Vision to Cybex product

1. Plug the short cable (TV side) of the C.A.B. (Console Adapter Box) or C-tv (Connected TV) into the Broadcast Vision TV.

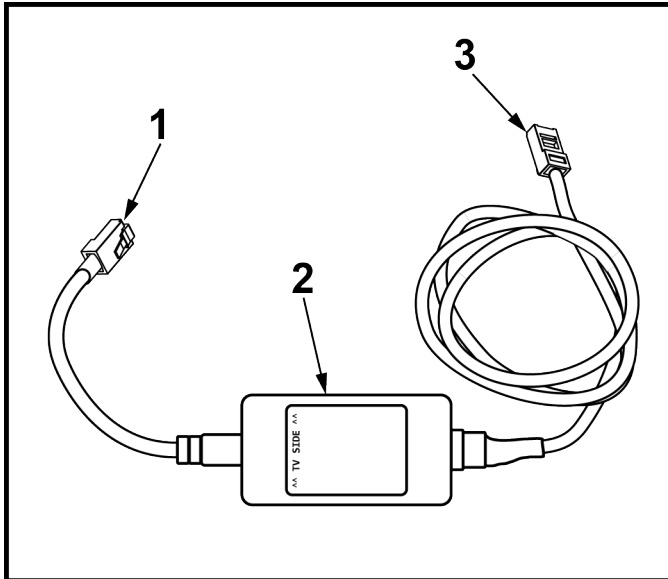







	Description	Qty.
1	Short cable, TV side	1
2	C.A.B. Console Adapter Box or C-tv (Connected TV)	1
3	Long cable, Cybex product side	1

2. Plug the long cable of the C.A.B. (Console Adapter Box) or C-tv (Connected TV) into the coupler at the base of the Cybex product.

C.A.B. (Console Adapter Box) or C-tv (Connected TV) setup option

For self powered units; plug in AC adapter or have another user pedal the unit for the entire procedure.

1. Plug the power cord into the power outlet. (Treadmills and powered units).
2. Turn the main power switch to the on (I) position. (Treadmills and powered units).
The control panel will light up.
3. Press any key to access the Opening Screen.
4. Press and hold the **Scan/Hold**  or **Display option**  and **UP**  keys for 3 seconds.
5. Navigate through the setup menu with the **UP**  and **DOWN**  keys.
6. Navigate to the A/V option.
7. Press the **ENTER**  key once to enter setup values.
8. Select **C.A.B.** (Console Adapter Box) or **C-tv** (Connected TV) from the A/V options.
9. Press the **ENTER**  key again to save any changes and advance forward in the menu.
10. Press the **STOP** key to exit Setup options.

Adjust volume

1. Connect headphones to the Cybex cardio equipment and listen to the TV audio. At the default volume level of 10 on the Cybex Equipment, the TV volume should be 'normal'.
2. If the TV is too loud or too quiet, adjust the TV volume using the Broadcast Vision Remote Control or controls on the TV until it is acceptable.
3. Adjust the volume on the Cybex Equipment using the Volume Up/Down buttons to ensure a normal range for use.

Once the TV volume is set, apply this TV volume level to all TV's.

Complete installation

Operate the unit at all levels to verify proper operation.