

NetPulse Monitor Bracket 750A/750AT

Kit Number 750AK047

Installation Instructions

This instruction sheet describes how to install the NetPulse monitor bracket for Cybex Arc Trainer® models 750A or 750AT.

⚠ CAUTION: *Serious injury or damage to machine can occur. To avoid injury the following precautions must be observed. Install monitor in accordance with NetPulse installation instructions and verify monitor is secure.*

Tools Required

- Phillips screwdriver
- Stubby Phillips screwdriver
- 7/16" socket wrench
- 5/32" Allen wrench
- Block, minimum height of 3.5"
- Heavy string, nut, and tape

Read and understand all instructions thoroughly before installing this kit.

Verify the kit contents shown. NetPulse monitor and cable not included.

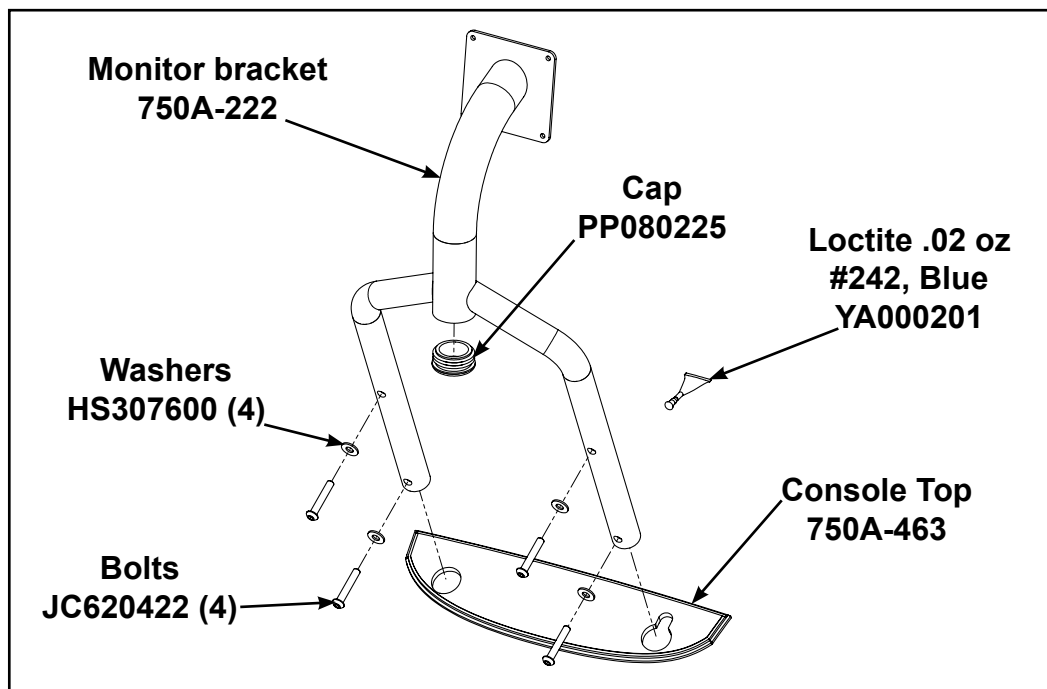

Disconnect external power source

If unit has the optional AC Power Kit unplug the power cord from the power outlet.

Remove tray insert and main tray

1. Remove two screws securing tray insert to main tray using a stubby Phillips screwdriver.

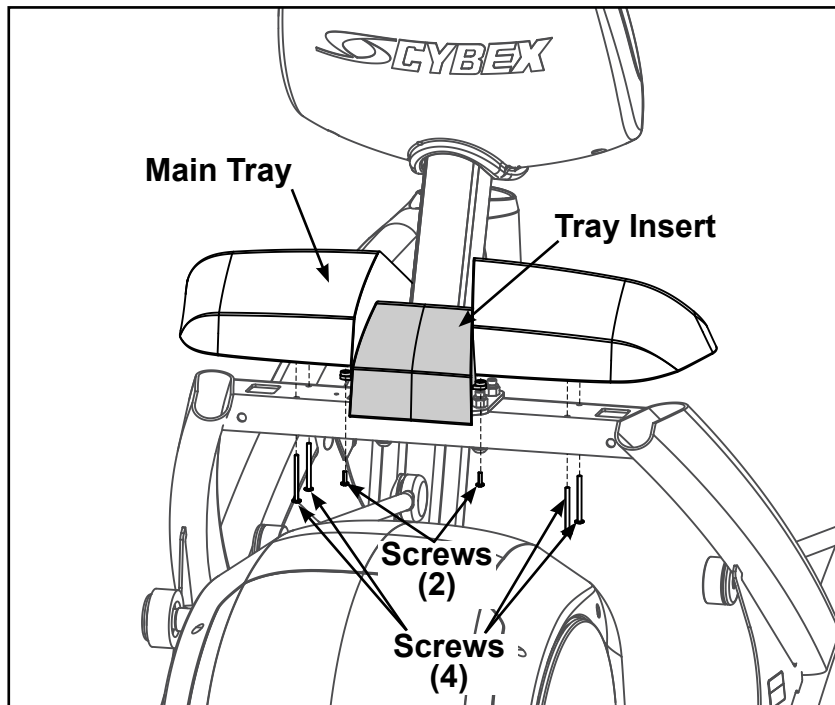

2. Remove four screws securing main tray to frame using a stubby Phillips screwdriver.

Remove back and top covers

1. Remove five screws securing back cover using a Phillips screwdriver.

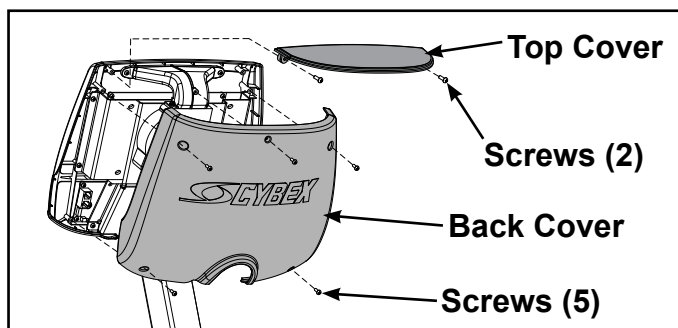

2. Remove two screws securing top cover using a Phillips screwdriver.
3. Set the two screws aside and discard top cover.

Install monitor bracket

1. Insert the NetPulse cable into the notch in the console top.

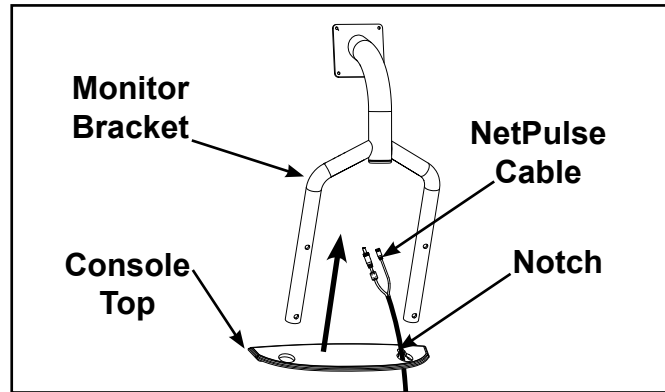

2. Slide console top up monitor bracket with NetPulse cable in notch.
3. Add loctite to four bolts and mounting holes in console.

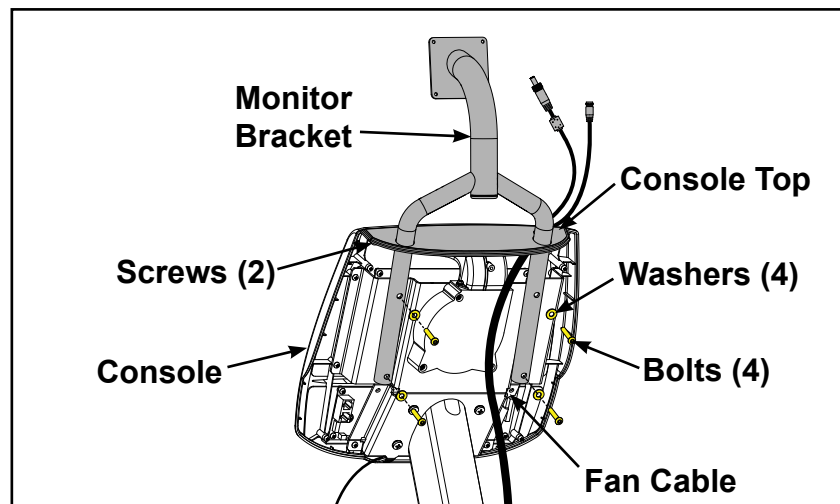

4. Install four bolts and four washers to secure monitor bracket to console using a 5/32" Allen wrench. Do not pinch or damage fan cable.
5. Install two screws securing console top using a Phillips screwdriver.

Remove right wheel

1. Place a block under unit to elevate right wheel. Block must be at least 3.5" high.

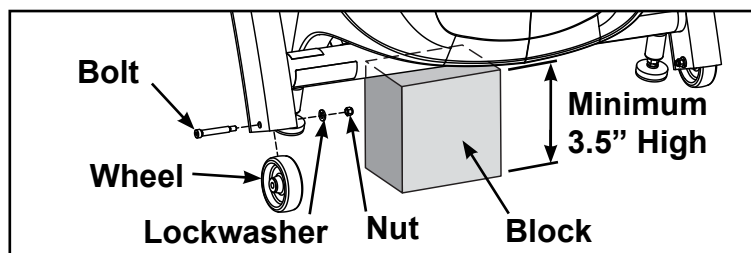

2. Remove bolt, lockwasher, and nut securing right wheel using a 7/16" socket wrench and a 5/32" Allen wrench.

Routing cable

1. Route NetPulse cable through top of console support tube to exit by heart rate wire.

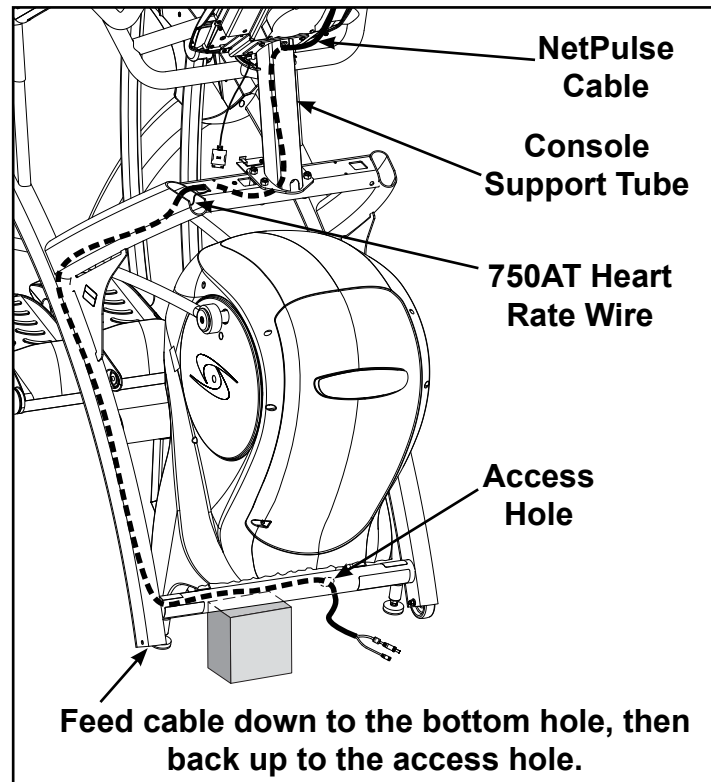

2. Tie one end of a heavy string to a nut and drop nut down frame. Tie other end to the Netpulse cable and carefully feed cable down through bottom (where the wheel was removed).

On the 750AT model the heart rate wire may need to be pulled tight before threading string.

3. Route cable back up through the bottom hole and out the access hole.

Install right wheel

1. Install wheel, bolt, lockwasher, and nut securing right wheel using a 7/16" socket wrench and a 5/32" Allen wrench.

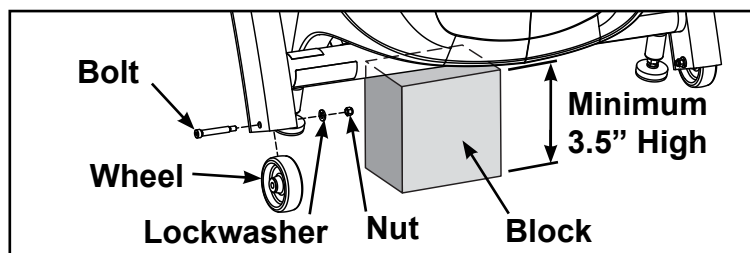

2. Remove the block.

Install NetPulse monitor and cable

Install monitor and cable in accordance with NetPulse installation instructions and verify monitor is secure.

Install back cover

Install the five screws to secure back cover in place using a Phillips screwdriver. Do not pinch or damage cables.

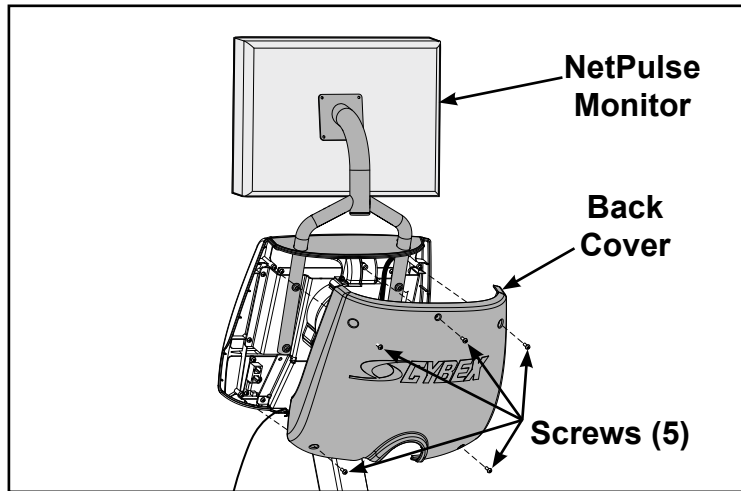

Install tray insert and main tray

1. Install four screws securing main tray to frame using a stubby Phillips screwdriver.

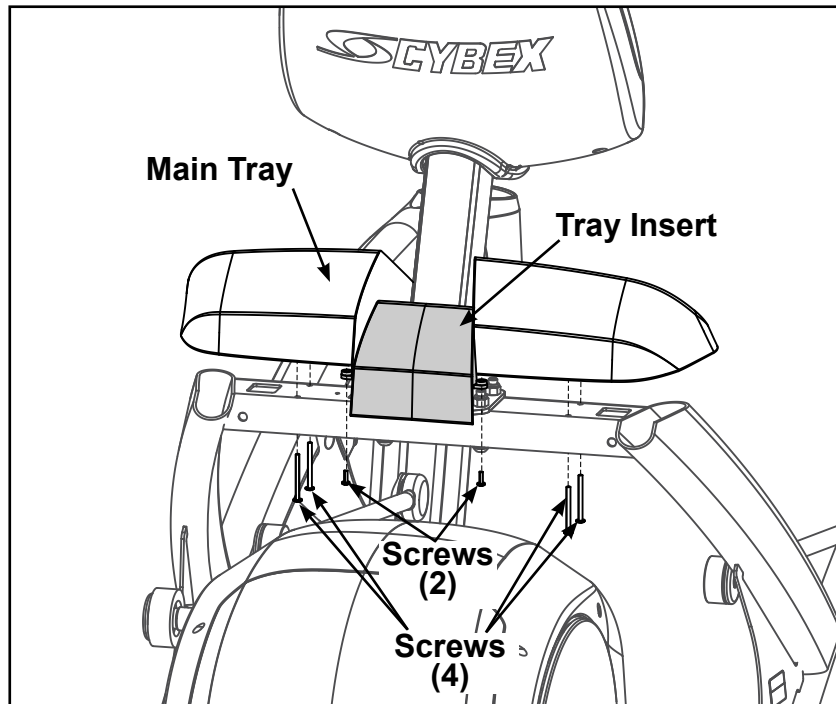

2. Install two screws securing tray insert to main tray using a stubby Phillips screwdriver.

Complete installation

1. Plug the optional power cord into the power outlet.
2. Operate the unit at all levels to verify proper operation.