

# Weight Storage Installation

## Tools Required

- 7/32" Allen wrench
- 9/16" Wrench

**NOTE:** This instruction sheet describes how to install the weight storage attachment on 16010, 16050 or 16060 Cybex Free Weight Bench.

1. Read and understand all instructions thoroughly before installing.
2. Verify weight storage attachment parts. See Figure 1.

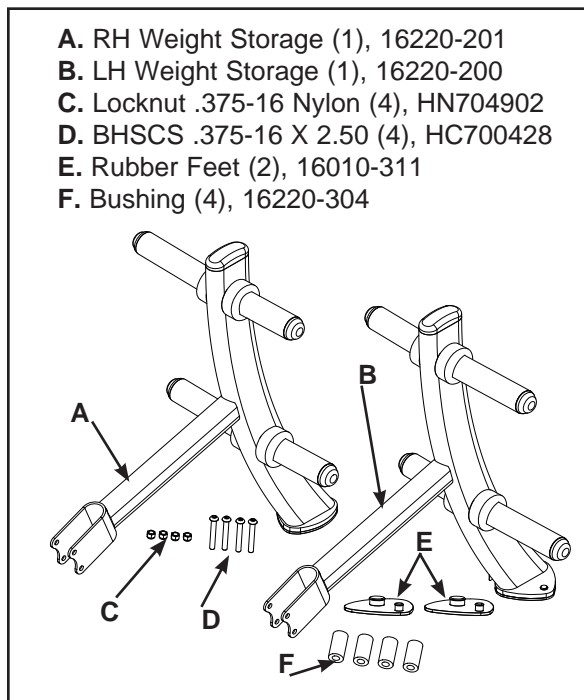

Figure 1

## 3. Install weight storage.

- A. Remove hardware package (C), (D), (F) and rubber feet (E) secured to weight storage frame.
- B. Carefully remove pad from bench frame. See Figure 2.

## Installation Instructions

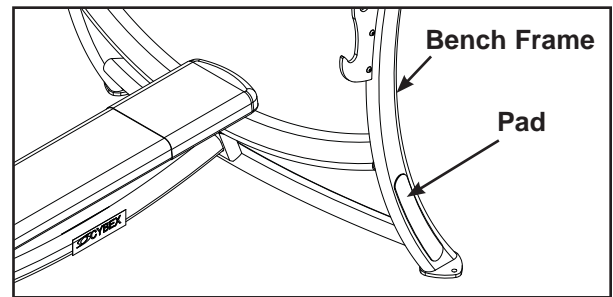

Figure 2

- C. Carefully remove all pad adhesive from frame.
- D. Repeat step 3B and 3C for opposite pad.
- E. Attach rubber foot (E) on RH weight storage (A) and LH weight storage (B).
- F. Align LH weight storage (B) on bench frame. See Figure 3.

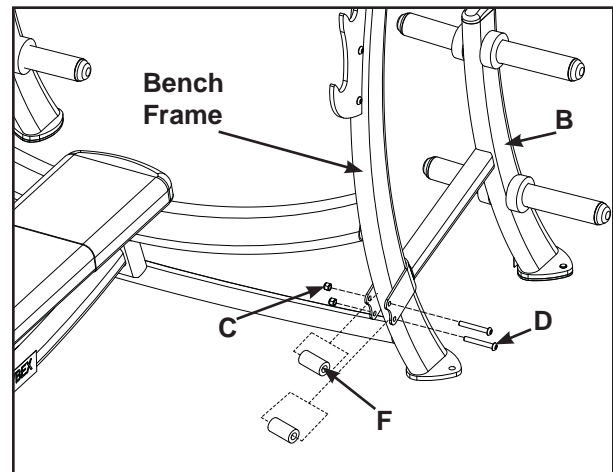

Figure 3

- G. Position bushings (F) on weight storage (B) See Figure 3.
- H. Using a 7/32" Allen wrench and a 9/16" wrench, secure weight storage (B) and bushings (F) in place with two Button Head Socket Cap Screws (BHSCS) (D) and two locknuts (C).
- I. Repeat steps 3F and 3G for RH weight storage (A).

## 4. Verify proper operation.

